



Section: 6

Dryer Parts Data

SWD

Dryer Cabinet Group

	Description	T-30 SWD	QTY
1	Panel Assy., Front- Upper (SS)	9989-603-001	1
*	Insulation Front Panel, half moon (top)	9277-063-001	1
*	Insulation Front Panel, half moon (bottom)	9277-063-002	1
2	Screw, FLHDCR, 10B x- 1 3/4	9545-008-014	4
3	Washer, Finish, #10	8641-585-001	4
*	Nut, Spring	8640-442-001	4
*	Hinge ,Backup Plate	9982-386-001	1
*	Screw, Countersink, 10-32X 1/2	9545-012-003	2
4	Strap, Hinge (SS/Black)	9544-072-002	2
*	Screw, Hinge to Panel	9545-012-028	4
*	Door Assy., Loading Complete-SS	9960-256-039	1
*	Door Assy., Loading Complete-Chrome/BLK/SS	9960-256-035	1
5	Door Assy., Loading-SS(ring only)	9960-255-008	1
5	Door Assy., Loading-Chrome(ring only)	9960-255-016	1
6	Plate Assy., Hinge (SS)	9982-280-012	1
*	Screw, Hinge to Door	9545-012-015	4
*	Nut, Hinge to Door	8640-413-002	4
*	Cover, Hinge Plate	9074-341-002	1
*	Screw, Phillips-10B x 3/8	9545-008-010	2
7	Glass, Door	9212-002-003	1
8	Gasket, Glass Black	9206-413-001	1
*	Support, Door Glass	9548-117-000	1
*	Tool Install Dryer Door Gasket	8545-064-001	1
9	Gasket, Outer Rim Black	9206-420-003	1
10	Handle, Loading Door	9244-093-001	1
*	Screw, Handle 1/4-20 x 3/8	9545-018-017	2
11	Stud, Door Catch, 3/4	9531-033-002	1
12	Nut, Hex	8640-413-001	1
13	Nut, Acorn	8640-413-003	1
14	Catch, Loading Door	9086-015-002	1
15	Pop Rivet for mtg. catch	8638-190-009	2
16	Screw, Door to Hinge Strap (Special Black Type)	9545-052-001	1
17	Washer, Fiber	8641-436-003	1
*	Cabinet Touch Up Paint (White)	9472-001-013	1

Cabinet Group

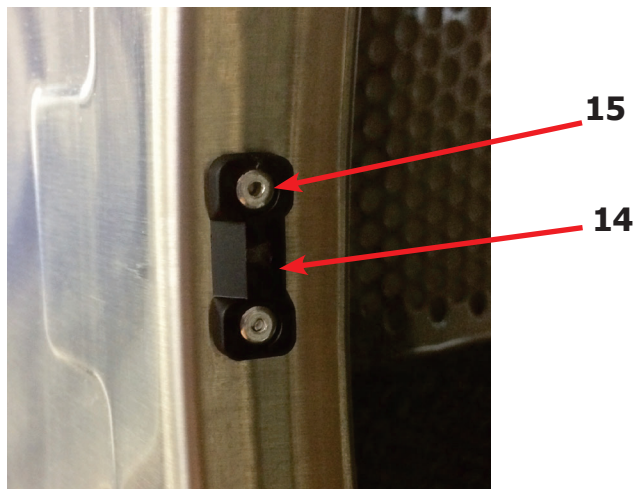
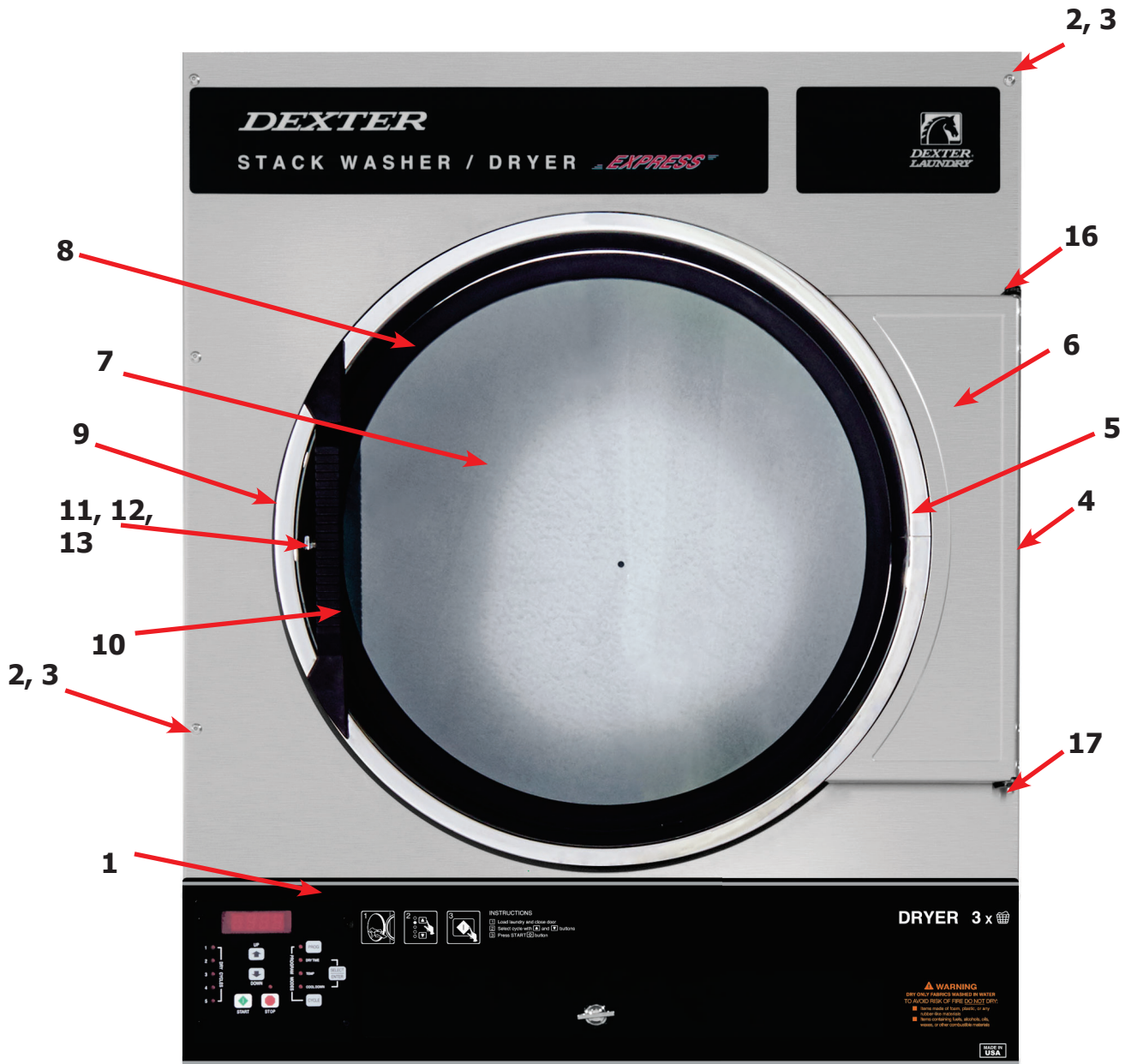

Dryer Cabinet Group

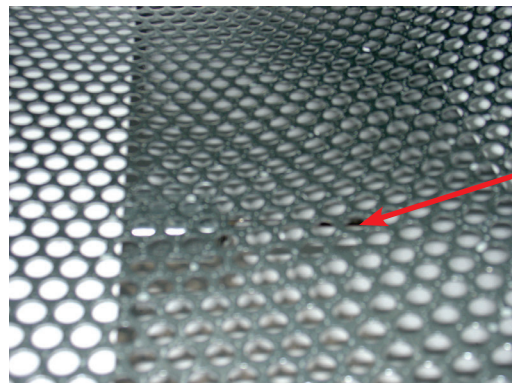
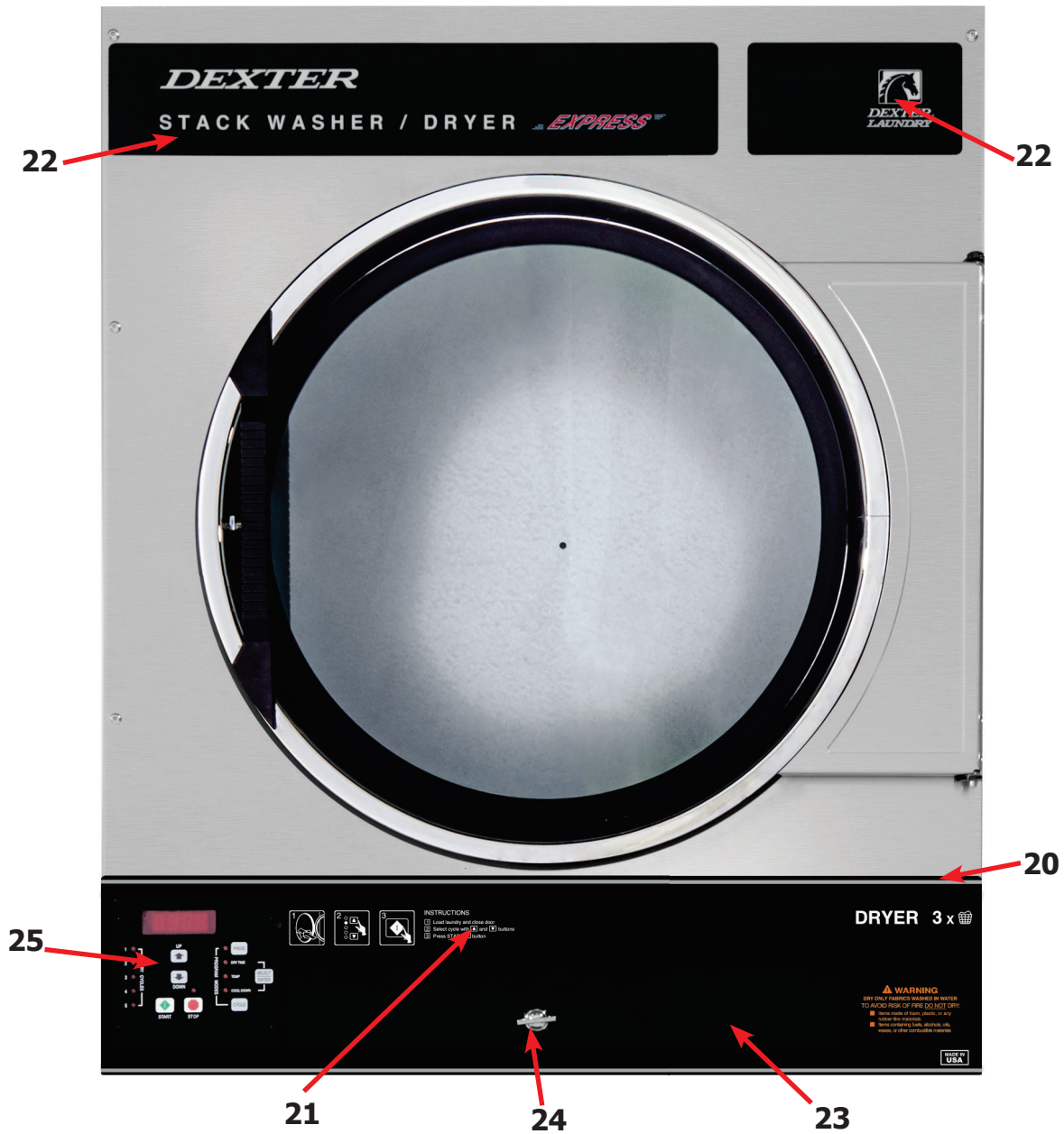

Cabinet Group Continued

Key	Description	T-30 SWD-11	QTY
20	Escutcheon, SWD, Dryer opl	9994-042-001	1
21	Trim, Overlay-Upper Black	9435-056-001	1
*	Screw, #4-40 x 3/16	9545-020-009	12
22	Nameplate Stack Dryer Express Black	9412-202-001	1
*	Lint Drawer Assembly Black	9866-004-013	1
*	Drawer, Front PTD	9974-010-001	1
*	Washer, Flat, #10	8641-581-006	2
*	Washer, Curved-Spring	8641-569-004	2
*	Nut, 10-32	8640-413-007	2
23	Overlay Trim, Lint Drwr-Black	9435-029-002	1
*	Felt Seal (back of lint screen assembly)	9555-057-002	1
*	Lint Screen Assembly ONLY (no front)	9805-038-001	1
*	Replaceable Lint Screen Only	9555-057-002	1
24	Lock-Door Service Thumb Turn	8650-026-002	1
*	Cam, Lock	9095-044-001	1
*	Lint Screen Strap Hold Down Screws 10Bx 1/4	9545-008-001	32
25	Controls Assy, 24VAC, Black	9857-227-001	1
*	Harness, Electronic Control	9627-770-005	1
*	Screw-trhdtrnx 6bsd1/2blk	9545-031-009	4
*	Harness, Heat Sensor	9627-679-003	1
*	Wire Nut Connector Grey	8640-276-002	2
27	Sensor Temp/Bracket Control	9501-010-002	2
*	Cover, Cabinet (Top)	9074-365-001	1
*	Insulation Cabinet Cover	9277-041-011	1
*	Screw-hxwshrundrcuthd,10abx3/8	9545-008-024	14
*	Stack Dryer Trunnion Puller	9732-243-002	1

Dryer Back Panels and Guards

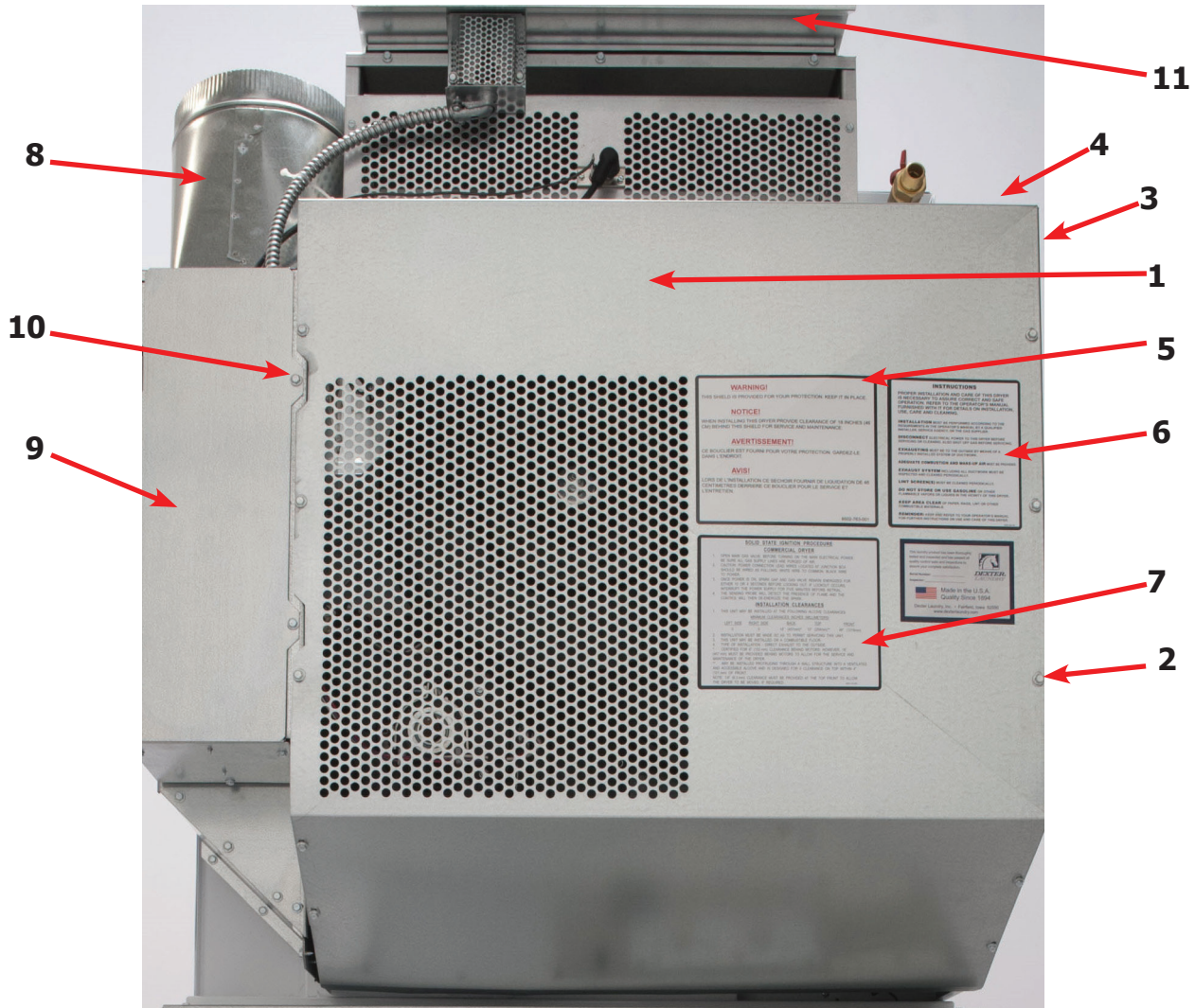

Key	Description	Part Number	Qty
1	Guard, Drive	9208-124-001	1
2	Screw, 10AB x 3/8	9545-008-024	18
3	Panel, Drive Guard,	9208-123-001	1
4	Guard-Small, upper	9208-074-001	1
5	Warning, Label	8502-763-001	1
6	Label, Instructions	8502-645-001	1
7	Lighting and Clearance, Label	8527-112-001	1
8	Duct, Transition	9109-129-001	1
9	Door, Cover-Control Box	9108-141-001	1
10	Guard Side, RH	9208-141-001	1
*	Cabinet, Cover	9074-365-001	1
*	Insulation	9277-041-011	1
11	Shield-Burner Inlet	9550-173-001	1
*	Wiring Diagram & Schematic	9506-830-001	1
*	6" Slide Open Clean Out Duct (Optional)	9973-035-001	1

Air Flow Switch Assembly

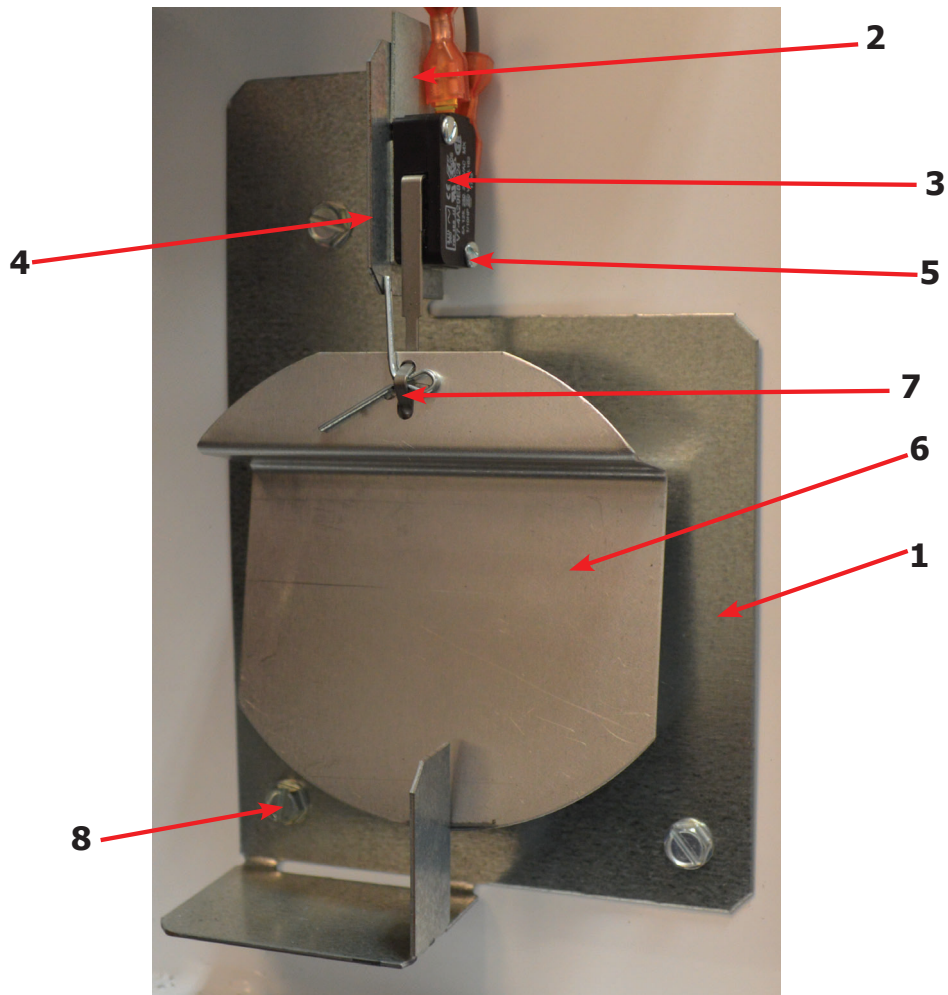

Key	Description	T-30 SWD	QTY
*	Air Flow switch Assy	9801-095-001	2
1	Bracket-Airflow switch	9029-174-001	2
2	Shield-Switch	9550-169-003	2
3	Switch-Micro	9539-461-009	2
4	Nut-Twin, 4-40	8640-401-001	2
5	Screw-.625, 4-40	9545-020-001	2
6	Actuator-Air Flow Switch	9008-007-001	2
7	Pin-Cotter, .09375x.75	9451-169-002	2
8	Screw, 10BX x 1/4	9545-008-01	3
*	Harness Assembly, Overtmp/Airflow	9627-861-001	1

Dryer Burner Housing Group

Key	Description	T-30 SWD	QTY
*	Housing Assembly, Burner (All sheet metal parts not listed)	9803-229-003	1
1	Service Burner Plate Front	9452-730-001	1
2	Screw, 10B X 1/4"	9545-008-001	4
3	Service Plate baffle Recirculation Chamber Clean Out	9452-850-001	1
4	Screw, 10B x 3/8"	9545-008-006	6
5	Angle, Burner Support	9003-220-001	1
*	Screw, 10B x 3/8"	9545-008-006	2
6	Burner, Main	9048-020-001	2
*	Screw 10AB x 3/8"	9545-008-006	2
*	Panel, Back Burner Housing	9454-991-001	1
7	Electrode Assy, Ignition	9875-002-003	1
8	Screw, Electrode Mtg 8B x 1/4"	9545-045-001	2
9	Valve, Gas Shut Off (Optional)	9379-196-001	1
10	Pipe, 1/2 x 4 1/2, BLK	8655-073-044	1
11	Elbow, 1/2 x 90, BLK	8615-104-037	1
12	Nipple, 1/2 x 4 1/2, BLK	8665-073-008	1
13	Control Assy, Gas	9857-134-001	1
14	Manifold, Assy	9029-175-001	1
*	Orifice, Burner-Natural #32	9425-069-009	2
*	Orifice, Burner-LP #50	9425-069-008	2
15	Bracket, Manifold	9029-175-001	2
16	Pipe Plug in end of Burner Manifold	8615-104-038	1
*	Screw, 10AB x 3/8"	9545-008-006	2
*	Bracket, High Limit Thermostat	9029-192-001	1
17	Thermostat, Hi-Limit	9576-203-002	1
*	Spacer, Hi-Limit	9538-142-001	2
*	Screw 8B x 3/4"	9545-045-007	2
18	Cover, Hi-Limit Stat	9074-329-001	1
*	Screw, 10AB x 3/8"	9545-008-006	2
19	Thermostat, Safety Shutoff	9576-207-008	1
20	Screw, 10AB x 3/8"	9545-008-006	2
21	Cover, Safety Stat	9825-062-001	2
*	Screw, 10AB x 3/8	9545-008-006	3
*	Control, Ignition Fenwall (3 trybox)	9857-182-001	1
*	Kit, LP Conversion	9732-102-036	1
22	Heat Recirculation Duct, (From Exhaust to Burner	9973-033-001	2
*	Screw, 10AB x 3/8"	9545-008-006	8
23	Shield-Burner Inlet	9550-173-001	1
*	Make-Up air Vent Kit	9732-333-001	1

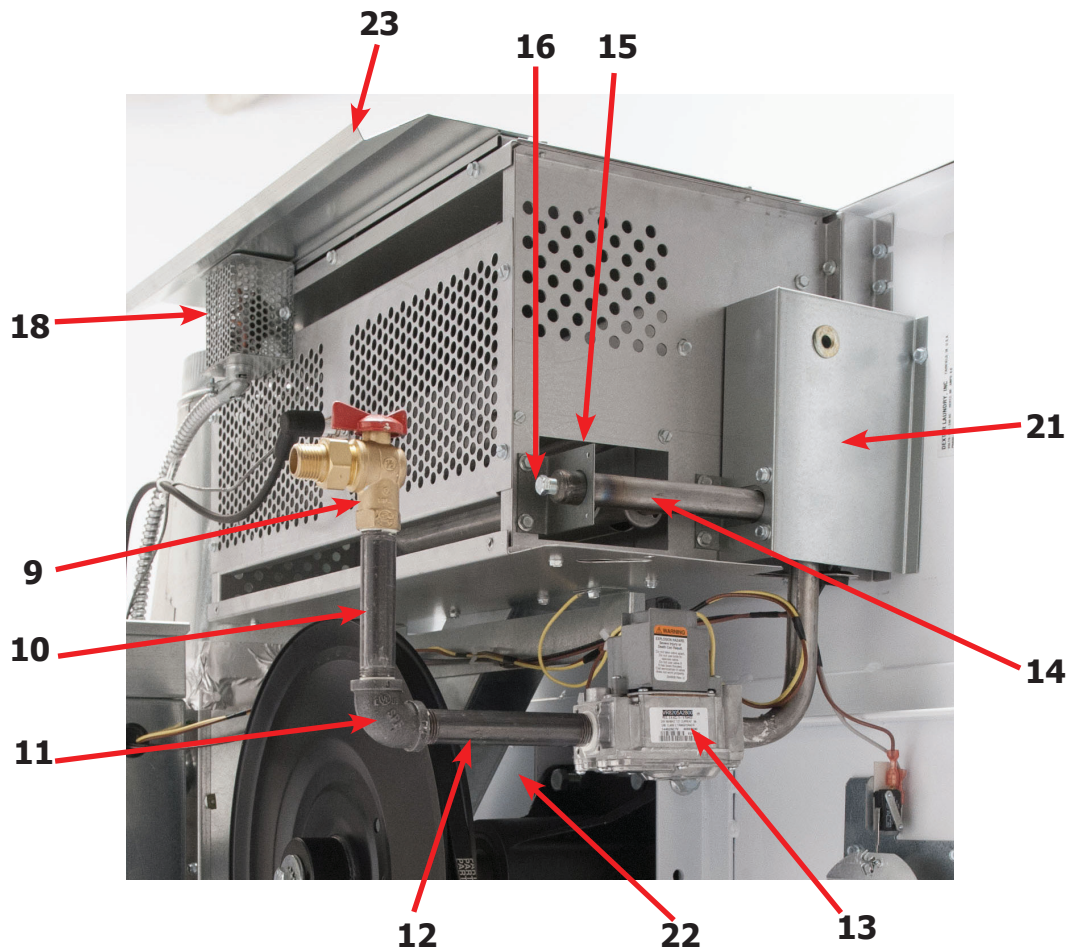
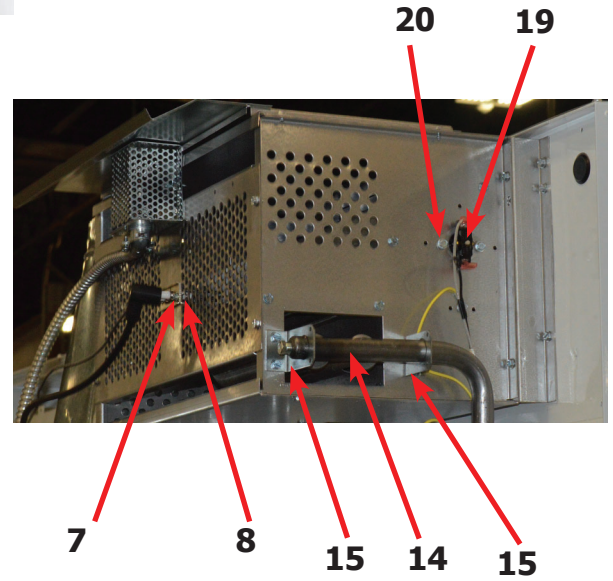
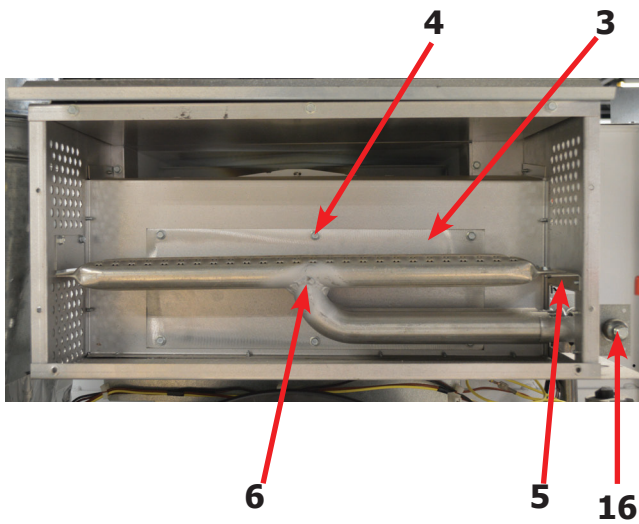
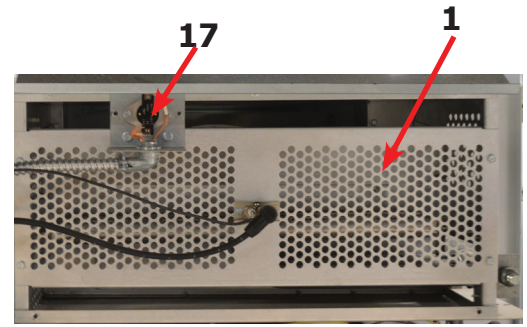
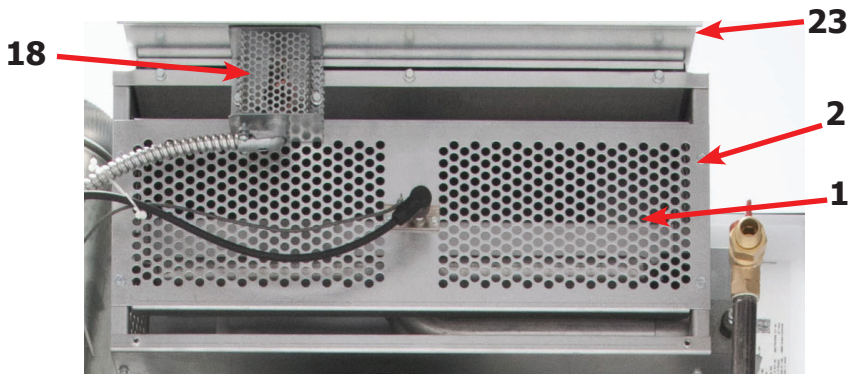

Bearing Housing Group

Key	Description	T-30 SWD	QTY
	Bearing Housing Complete Assy (Includes bearings & Spacer)	9803-160-003	1
1	Housing, Bearing	9241-161-002	1
*	Spacer, Bearing	9538-139-002	1
2	Bearing, Ball, Front & Rear	9036-130-001	2
3	Screw-Wizlock, 3/8-24x3/4	9545-049-002	4
4	Nut, 5/16-18	8640-400-002	4
5	Screw, 3/8-24x1	9545-049-001	2
6	Nut, 3/8-24	8640-415-002	2

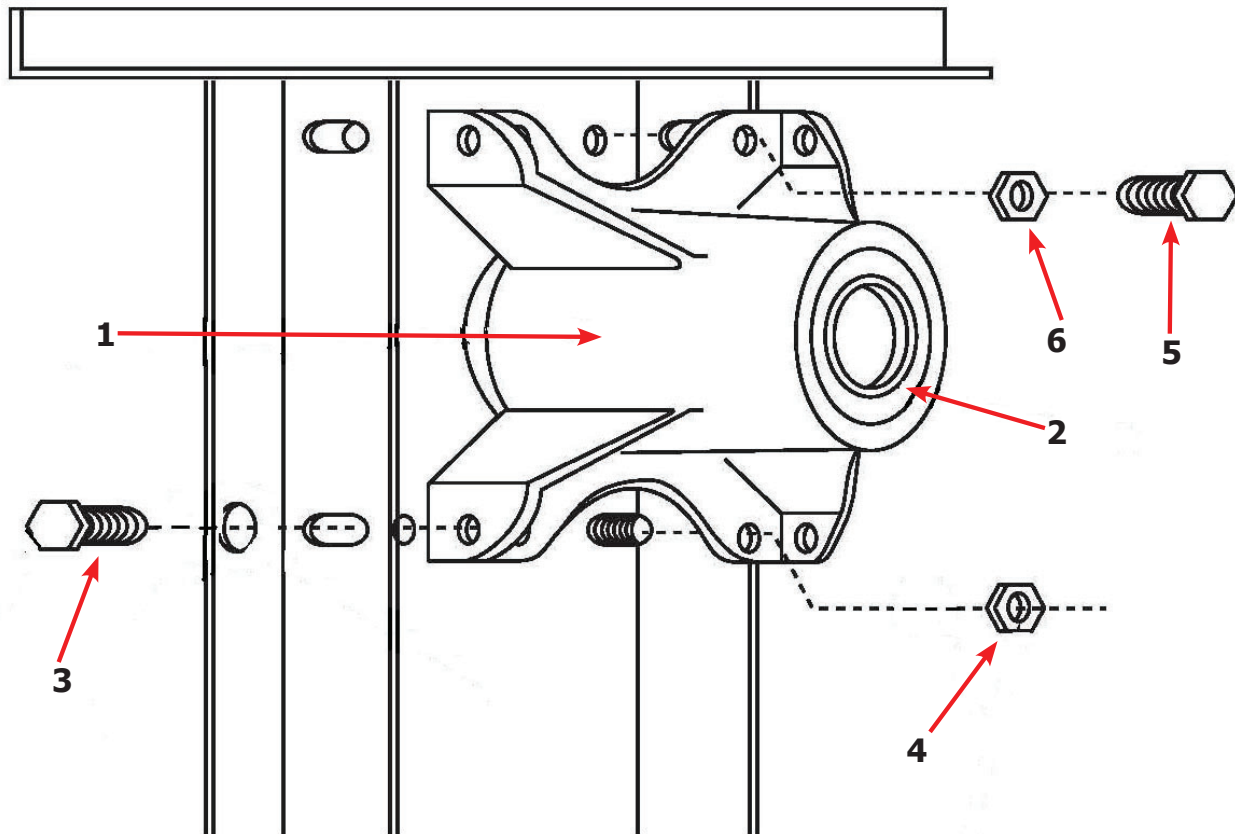
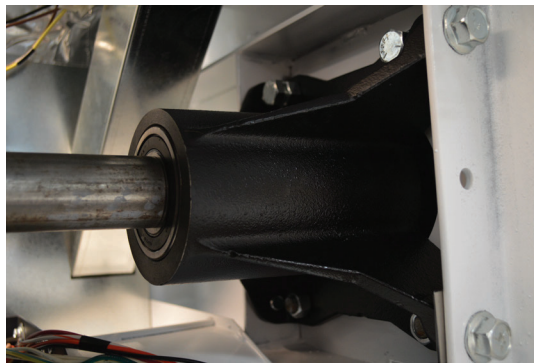

Tumbler Group

Key	Description	T-30 SWD	QTY
*	Tumbler Assy Complete W/Spider (GALV)	9848-147-001	1
1	Tumbler Assy (Galvanized)	9848-146-001	1
*	Tumbler Assy Complete W/Spider (SS & Galv front)	9848-147-002	1
1	Tumbler Assy (Stainless Galvanized front)	9848-146-002	1
2	Rod, Tumbler	9497-019-003	3
3	Washer, Special	8641-554-001	3
4	Shim	9552-013-003	AR
5	Spider Assy	9568-015-001	1
6	Nut, Wiz Lock	8640-415-004	3
7	Spacer-Shaft	9538-164-002	1
8	Tolerance Ring	9487-234-005	1
9	Pulley, Driven	9908-049-002	1
10	Washer -Flat 1/2	8641-581-026	1
11	LockWasher - IntTooth, 1"	8641-582-016	1
12	Screw, 1/2-13x1 1/4	9545-017-009	1
*	Belt, Drive	9040-073-009	2

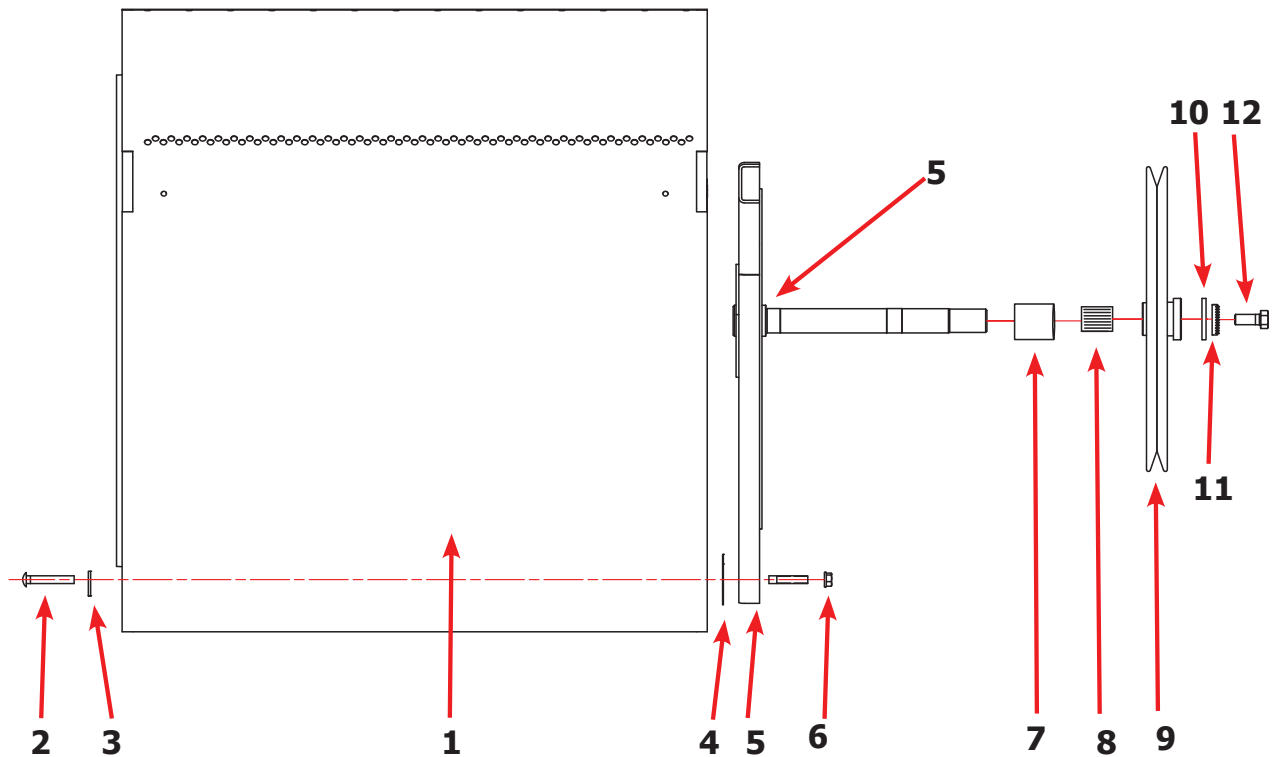

Key	Description	T-30 SWD	QTY
*	Wire Harness Overtemperature Switch	9627-861-001	1
*	Switch Assy, Air Flow	9801-095-001	1
1	Switch, Air Flow	9539-461-009	1
2	Bracket, Switch- Air Flow	9029-174-001	1
3	Actuator, Switch	9008-007-001	1
4	Pin, Cotter	9451-169-002	1
5	Screw 4-40 x 5/8"	9545-020-001	2
*	Nut, Special Twin .#4-40	8640-401-001	1
*	Shield, Switch	9550-169-003	1
*	Screw 10 Bx 1/4"	9545-008-001	3
7	Motor, Drive	9376-331-001	1
*	Tumble Capacitor	5191-108-002	1
*	Start Capacitor	5191-109-002	1
8	Plate, Motor Mtg	9452-740-001	1
*	Bolt 3/8" - 16 x 3/4"	9545-029-008	1
*	Lockwash Spring 3/8	8641-582-003	1
9	Screw, Motor Plate to Back Assy. 1/4-20x 2 1/2	9545-018-019	1
9	Lockwasher 1/4	86411-582-007	1
9	Spacer	9538-163-006	1
9	Flat Washer 1/4 x 7/8.	8641-581-017	1
9	Rubber Grommet	9209-086-002	1
*	Grommet Spacers	9538-166-006	1
*	Screw, Set	9545-028-013	1
10	Back Assy, Blower Hsg	9962-017-002	1
*	Nut 1/4x20	8640-414-004	7
*	lock washer	8640-582-007	7
*	Clamp-cable,3/4	8654-126-004	2
*	Screw-hxhdsLtdmach,12abx1/2	9545-048-001	2
11	Support Assy, Intermed. Pulley	9991-053-001	1
12	Bolt, Rd Hd 3/8-16 x 1 1/4	9545-029-010	3
13	Bolt, 3/8-16 x 1 1/2	9545-029-003	1
12	Nut Flange WiziocK 3/8" - 16	8640-415-004	3
*	Washer, Flat	8641-581-035	1
14	Arm Assy-Tension, Complete	9861-022-001	1
*	Washer, Flat	8641-581-035	1

Rear View Photos

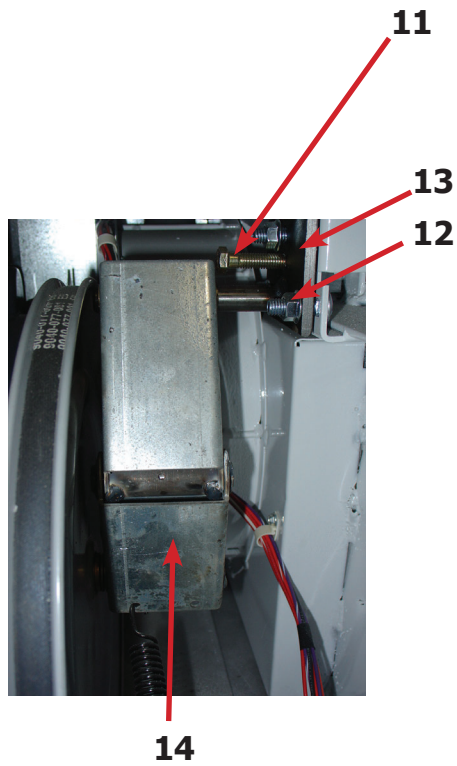
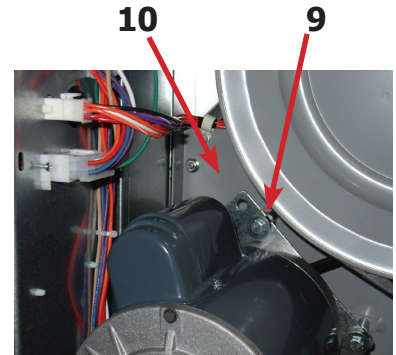
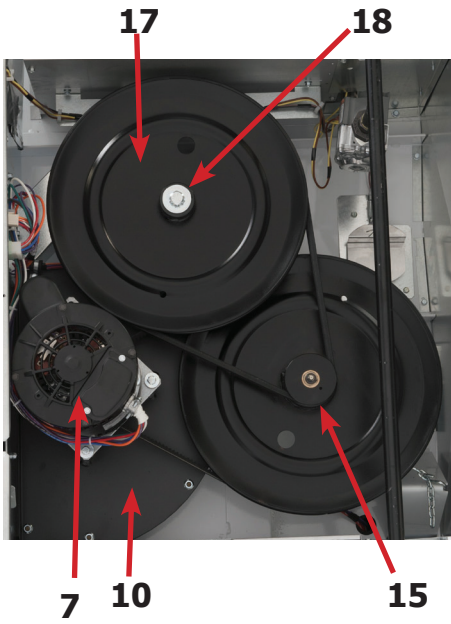
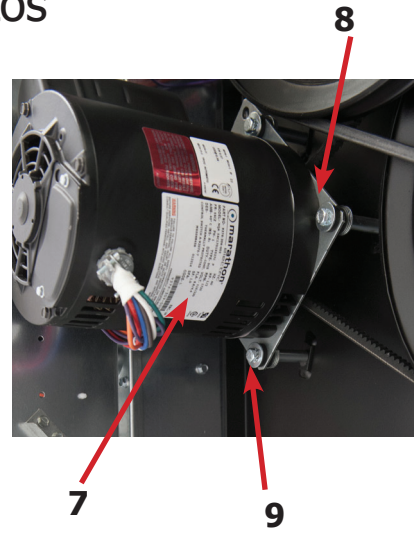
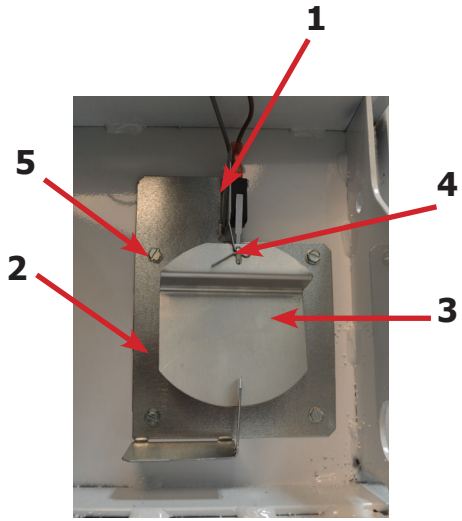

Key	Description	T-30 SWD	QTY
14	Arm Assy-Tension, Complete	9861-022-001	1
*	Washer, Flat	8641-581-035	1
15	Ring-Retaining	9487-200-003	1
16	Pulley Assy, Intermediate with bronze flange bearing	9908-039-004	1
*	Bearing - Bronze Flange	9036-145-002	1
*	Spacer-Shaft (See Tumbler Group for Expanded View)	9538-164-002	1
*	Tolerance Ring	9487-234-005	1
17	Pulley, Driven	9908-049-002	1
18	Washer -Flat	8641-581-026	1
18	LockWasher - IntTooth, 1"	8641-582-016	1
18	Screw, 1/2-13x1 1/4	9545-017-009	1
19	Belt, Drive- Motor	9040-077-001	1
20	Belt, Drive- Tumbler	9040-073-009	1
21	Spring, Tension	9534-319-002	1
22	Chain, Tension	9099-012-002	1
23	Hook, Tension	9248-,022-002	1
*	Damper Inside Duct Exhaust	9125-007-002	1
24	Pin, Damper Hinge	9451-146-001	1
*	Nut, Spring	8520-141-000	2
*	Screw #10B x 1/2	9545-008-026	3
*	Cover Duct Upper	9825-380-001	1
*	Base Duct	9047-118-001	1
*	Screw 10ABx 3/8"	9545-008-024	40
26	Impeller, W/Set Screws	9278-040-001	1
27	Pulley, Motor	9453-157-001	1
25	Heat Recirculation Assembly Duct	9973-033-001	1
*	Bracket for Wire Harness Under Burner Housing	9029-173-001	1

Rear View Photos

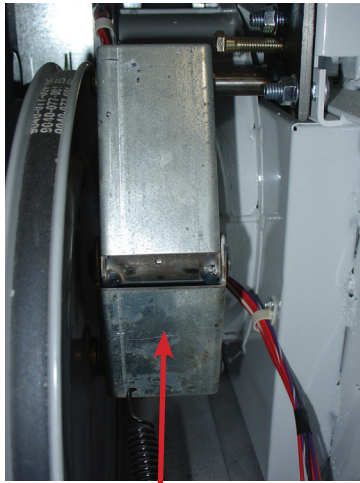

14

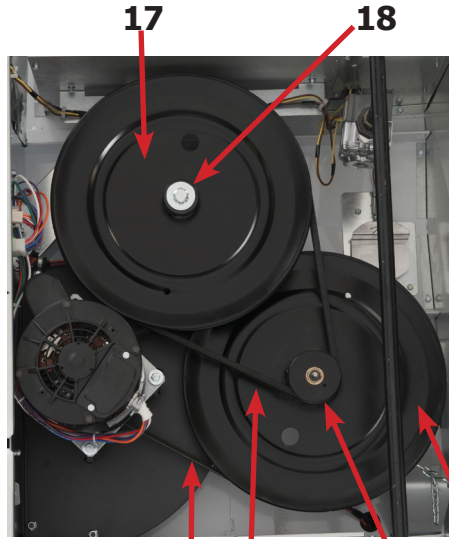

17

18

19 20

15 16



21

22

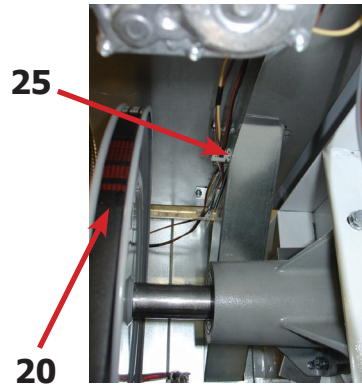

25

20

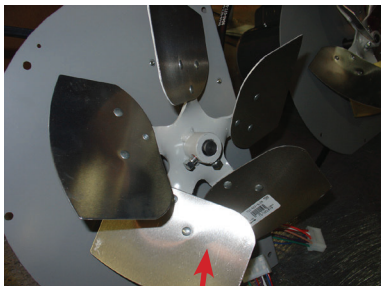

26

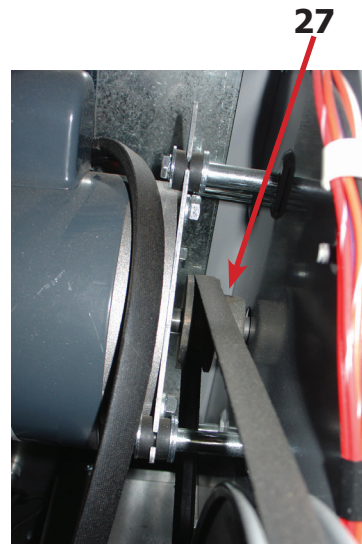

27

Control Assembly Group

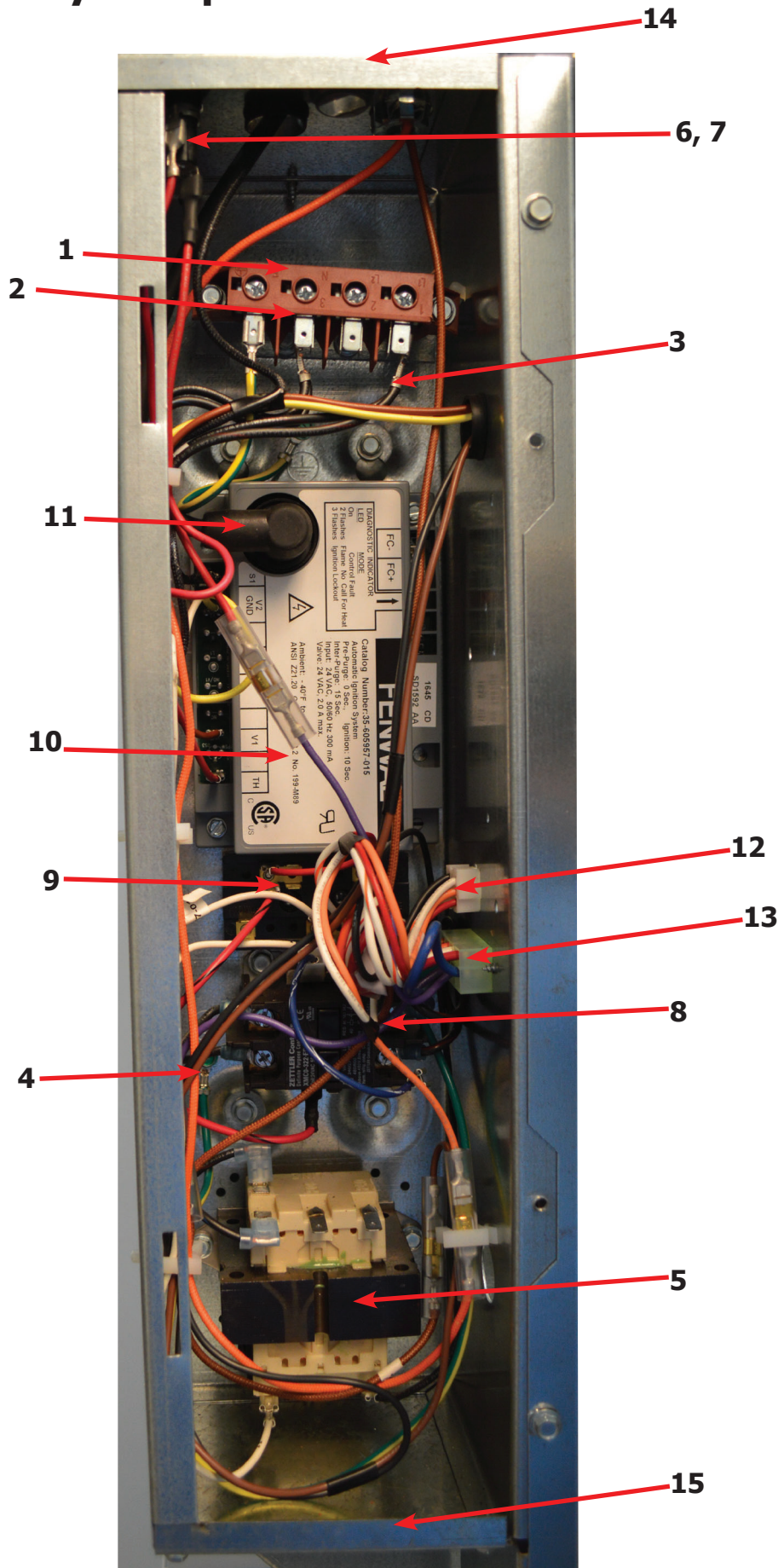

Control Assembly Group

Key	Description	T-30 SWD	QTY
*	Control, Rear	9857-234-001	1
*	Bracket, Terminal Block Power	9029-202-001	1
1	Strip, Terminal Marker	9558-029-003	1
2	Terminal-Block, Power, 4 Pole	9897-035-001	1
*	Screw, 10AB x 3/8"	9545-008-024	4
3	Harness Assembly-Power Main Fork, Upper	9627-859-007	1
4	Wire Assembly-Ground, GRN/YEL, 7"	8220-137-002	1
*	Lock Washer, Ext tooth #10	8641-582-006	1
*	Screw, 10-32 x 1/2"	9545-008-027	1
5	Transformer, 208/240/60Hz. 24/120VAC	8711-007-002	1
*	Screw, 10AB x 3/8"	9545-008-024	2
6	Fuse Holder Assembly	9200-001-002	1
7	Fuse, 1.5Amp/250V-Fast Acting	8636-018-001	1
8	Relay, Motor, 30Amp 24VAC	5192-299-002	1
*	Screw, Phillips, 8AB x 1/2"	9545-045-012	2
9	Terminal Block, Power	9897-026-001	1
*	Screw, Phillips, 8AB x 1/2"	9545-045-012	2
*	Harness-Assembly, Low Voltage, Upper	9627-867-011	1
10	Ignition Module	9857-182-001	1
*	Screw, 10AB x 3/4"	9545-008-018	2
11	Wire Assembly, High Voltage	9631-403-009	1
*	Door-Control Box	9108-141-001	1
*	Screw, 10AB x 3/8"	9545-008-024	3
12	Harness, Main (Internal Box)	9627-863-003	1
*	Harness Main Extension (External Box)	9627-913-003	1
13	Harness Motor	9627-864-007	1
14	Control Box Panel Upper	9454-943-001	1
15	Control Box Panel Lower	9454-697-001	1
*	Control Box Wrapper	9636-216-001	1
*	Wire Red/Black 8"	8220-062-047	1
*	Wire White #11, 14"	8220-062-038	1
*	Wire-Blue/White 5.5"	8220-062-026	1
*	Wire Black/Red #9 9"	8220-146-001	1

Door Switch Group

Key	Description	T-30 SWD	QTY
1	Door Switches (Rectangle)	9539-487-001	2
2	Bracket-Mounting lint tray switch	9029-303-001	1
3	Conduit-Wire	6068-051-001	1
*	Grommet Wire 1/2 i.d.	9029-089-001	1

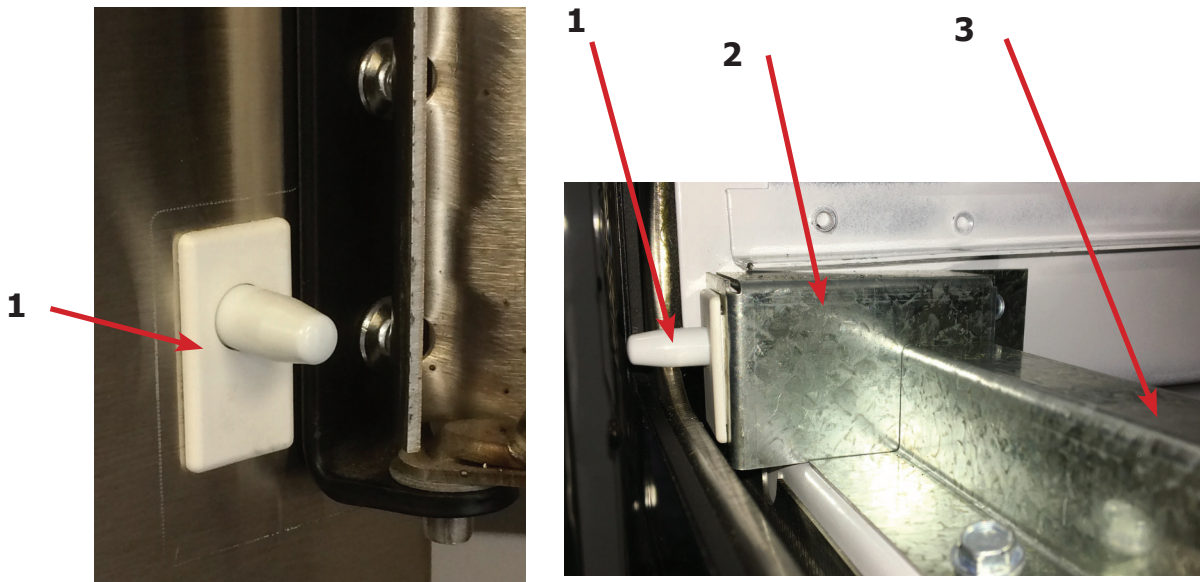

Hinge Plate Cover

Key	Description	T-30 SWD	QTY
1	Cover-Hinge, Black	9074-341-002	1
2	Screw-TRHDCR, 10B x 3/8, Black	9545-008-010	2

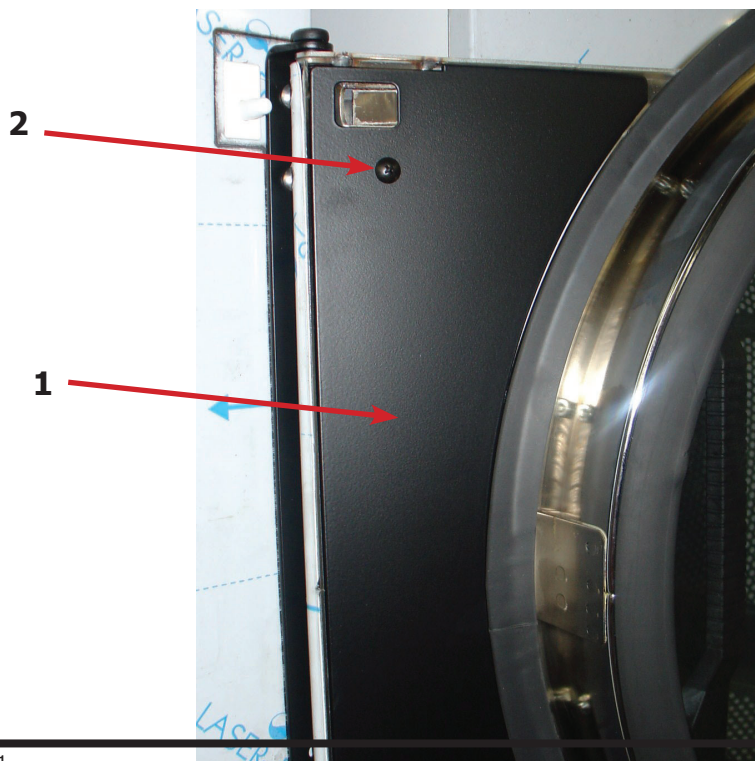

Control Group

Key	Description	T-30 SWD	QTY
	Control Assembly	9857-227-001	1
1	Membrane Switch OPL Black	9801-111-001	1
*	Wire Assembly Green/Yellow	8220-137-002	1
*	Wire Assembly Green	8220-001-478	1
2	Nut-Hex #6-32	8640-411-003	1
3	Nut-Hex #6-32	8640-411-001	3
4	PCB Assyembly-Controller opl	9471-016-001	1
5	Plastic Spacer #6x1/2	9538-157-016	4
6	Plate Assyembly opl ptd	9982-391-002	1

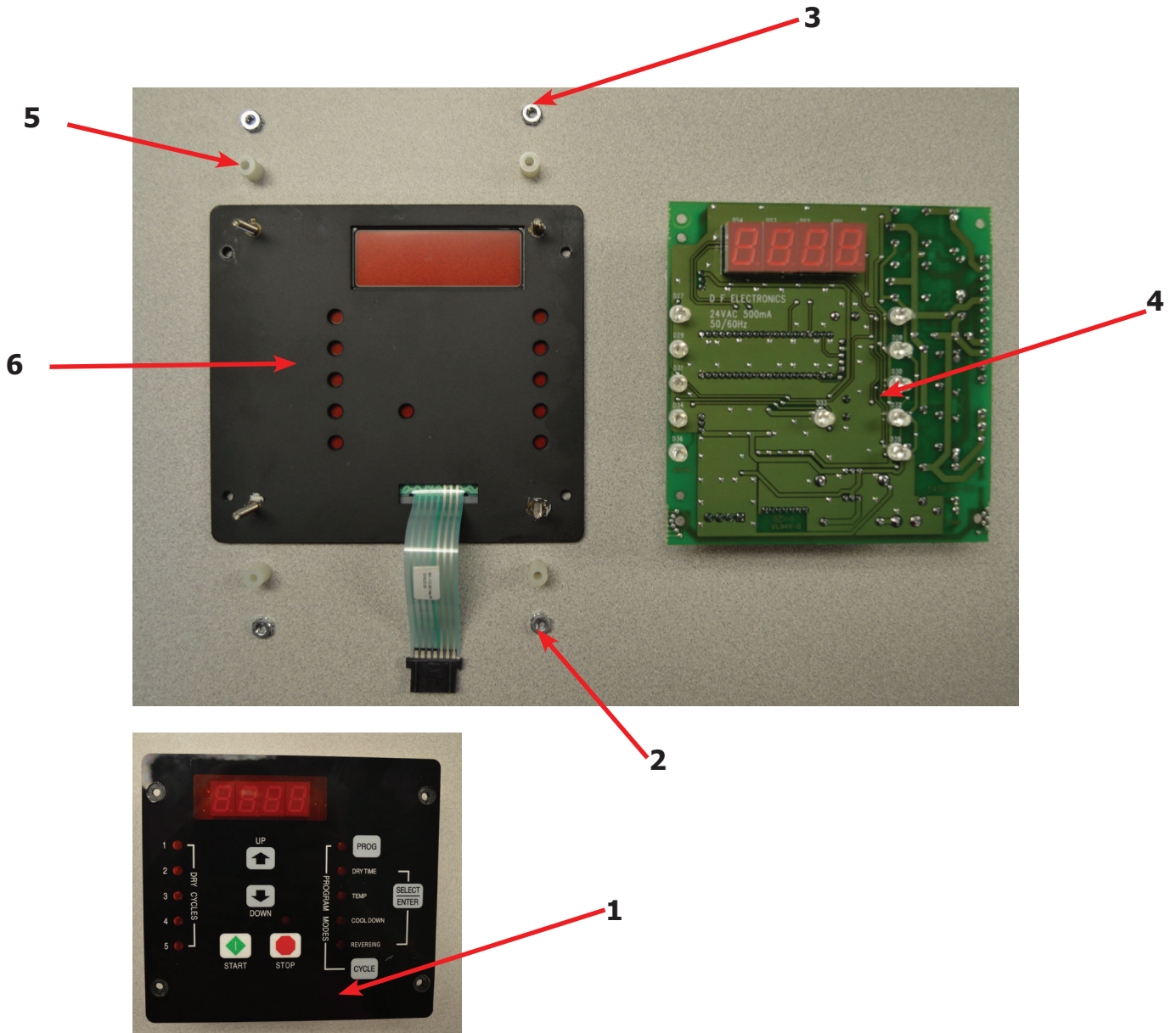

Wiring Schematic Dryer

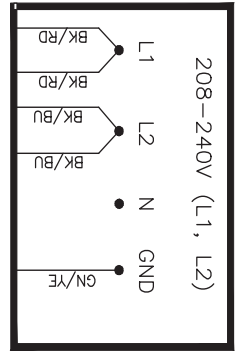

EXTERNAL GROUND MUST BE A NATIONAL/LOCAL ELECTRICAL CODE APPROVED GROUND AND CONNECTED TO THE DRYER GROUNDING TERMINAL.

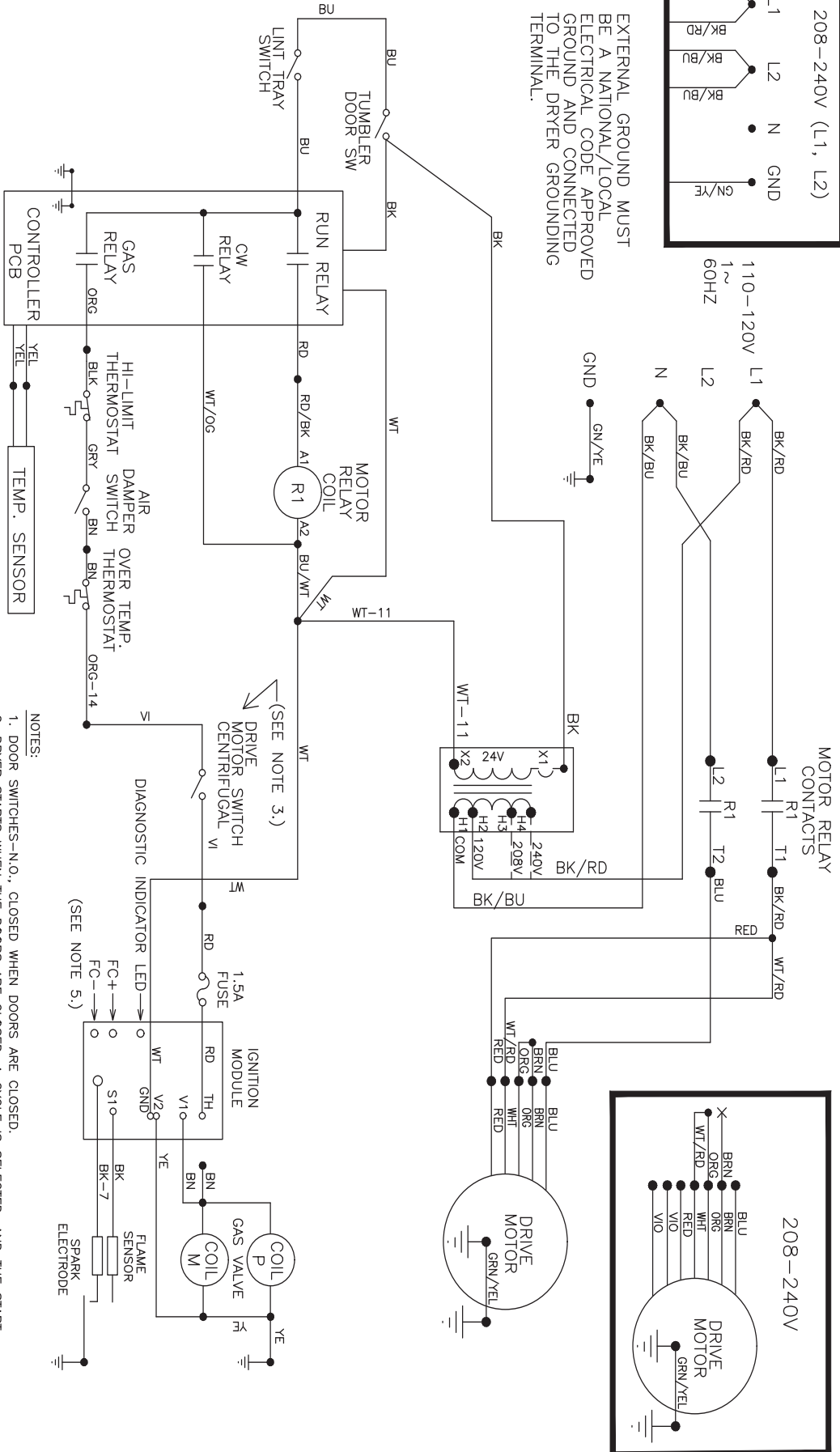

CAUTION: LABEL ALL WIRES PRIOR TO DISCONNECTION WHEN SERVICING CONTROLS. WIRING ERRORS CAN CAUSE IMPROPER AND DANGEROUS OPERATION. VERIFY PROPER OPERATION AFTER SERVICING. ATTENTION: AU MOMENT DEL'ENTRIEN DES COMMANDES, ETIQUETEZ TOUS LES FILS AVANT DE LES DEBRANCHER. DES ERREURS DE CABLAGE PEUVENT ENTRAINER UN FONCTIONNEMENT INADEQUAT ET DANGEREUX. S'ASSURER QUE L'APPAREIL FONCTIONNE ADEQUATEMENT UNE FOIS L'ENTRIEN TERMINE.

- NOTES:
1. DOOR SWITCHES-N.O., CLOSED WHEN DOORS ARE CLOSED.
 2. DRYER STARTS WHEN THE DOORS ARE CLOSED, A CYCLE IS SELECTED, AND THE START BUTTON IS PUSHED. THERE IS AN AUTOMATIC COOL DOWN AT THE END OF THE CYCLE.
 3. CENTRIFUGAL SWITCH-N.O., CLOSES WHEN MOTOR IS UP TO SPEED.
 4. REFER TO OWNER'S MANUAL FOR DESCRIPTION OF OPERATION AND REQUIREMENTS FOR HEATING CIRCUIT.
 5. WITH A DC MICROAMMETER, FLAME CURRENT CAN BE MEASURED AT TEST POINTS. READING SHOULD BE 0.7uA DC OR HIGHER.

9506-830-001PR

SCHEMATIC

DNS030N_15_B_X_-----X

Wiring Diagram Dryer

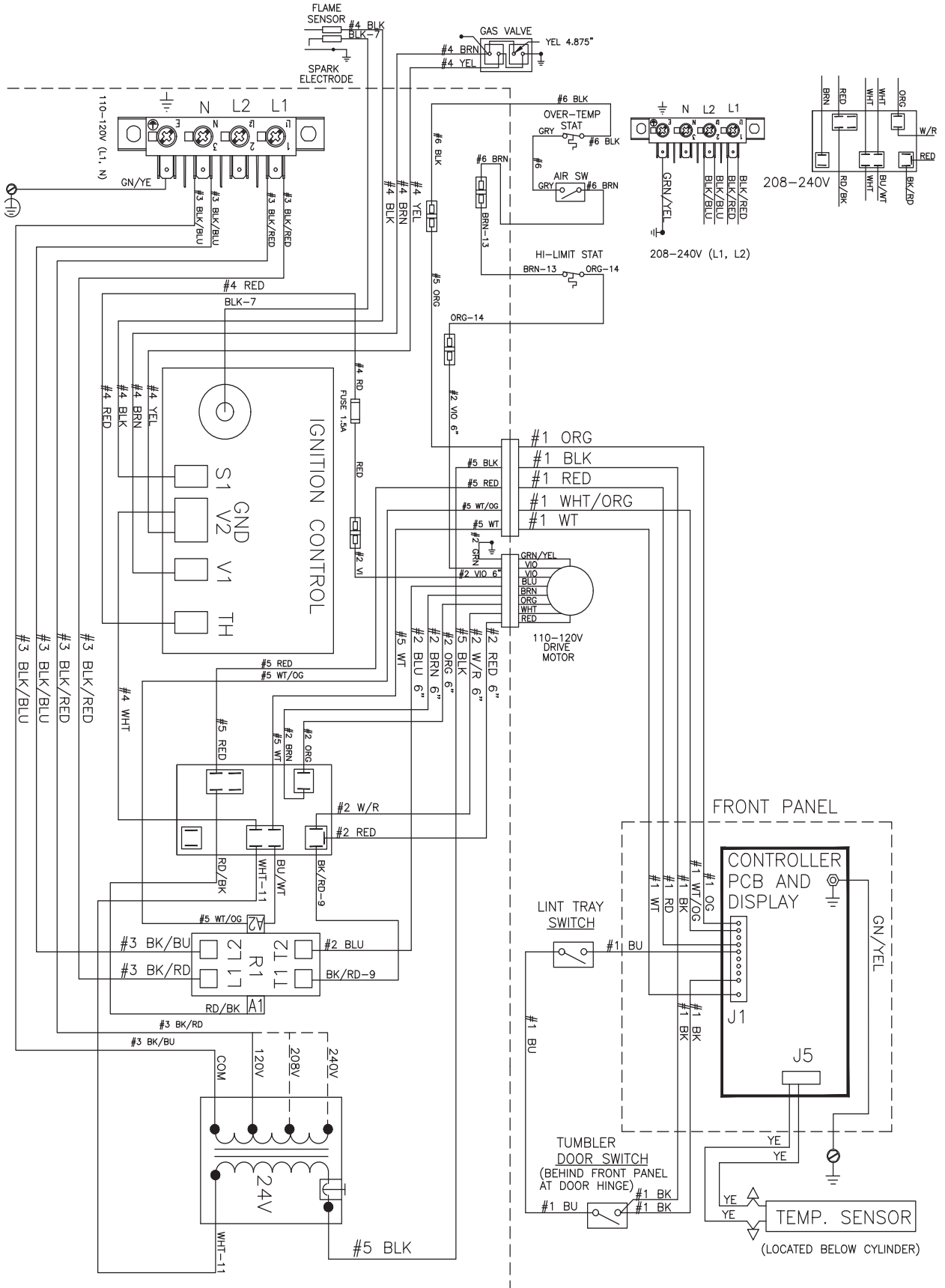

9506-830-001PR WIRING DIAGRAM DNS030N-15_B_X-____-__X

Notes

Lined area for taking notes.

Section: 7

50 Hz Gas Dryer

T-30 SWD -39 50 Hz Parts

Key	Description	Part Number	Qty
*	Strip, Terminal Marker -39 Models	9558-029-004	1
1	Transformer	8711-007-002	1
*	Instructions, Transformer Connect	8507-230-003	1
2	Ignition Control -39 Models	9857-182-001	1
*	Harness-Ignition Control,	9627-867-011	1
3	Wire Assembly High Voltage	9631-403-009	1
4	Motor	9376-318-002	1
5	Pulley, Motor Drive	9453-169-009	1
6	Harness Motor Extension	9627-864-007	1
*	Wiring Label Schematic/Diagram -39 models	9506-832-001	1
*	Owner's Manual	8514-287-001	1
*	Lint Drawer Assembly -39 Models	9866-004-013	1

Rear View Photos

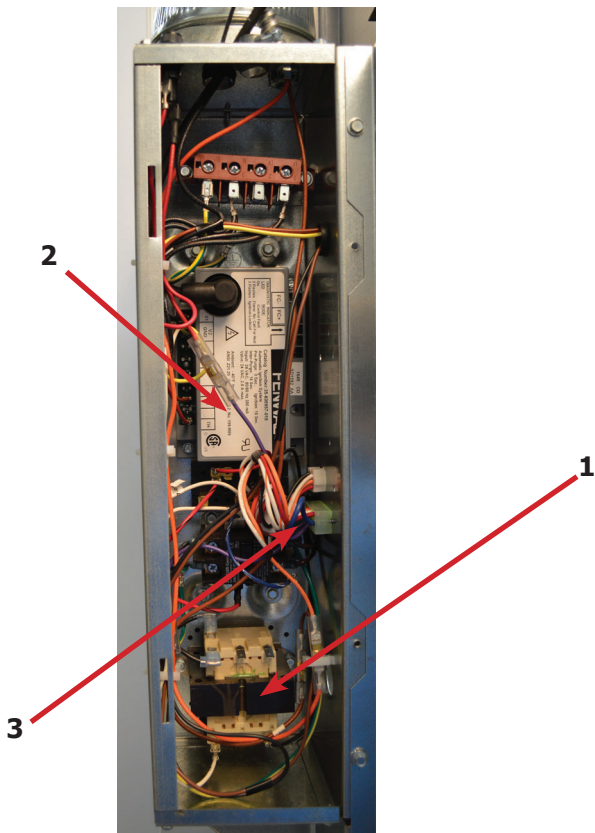
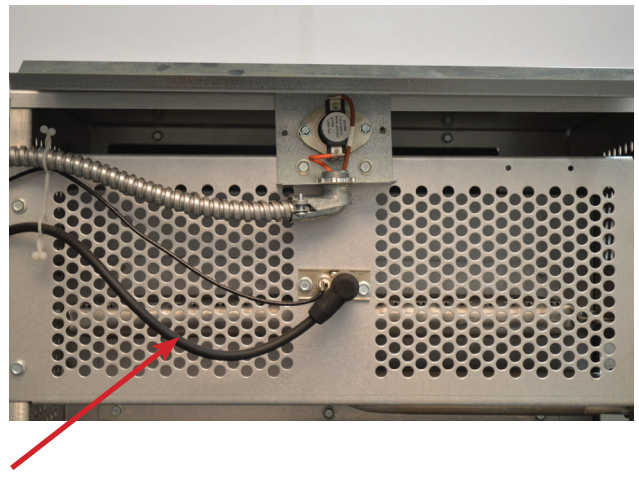
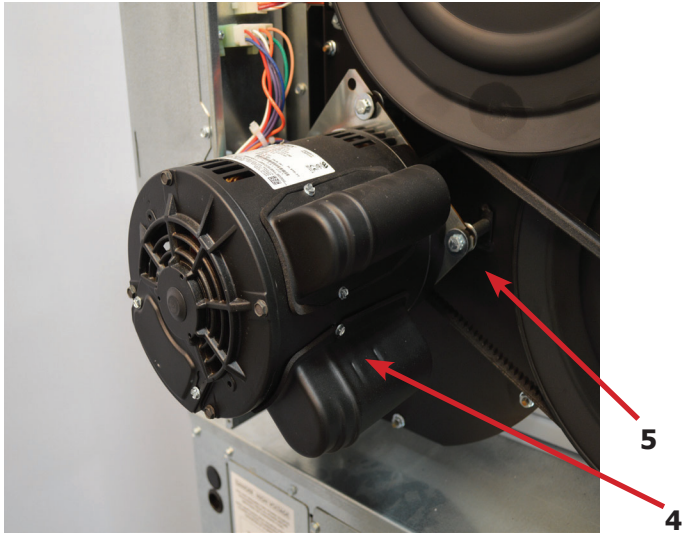

T-30 SWD -39 Gas Control Parts

Key	Description	Part Number	Qty
1	Kit-Honeywell VR86 Valve Flange	9732-162-001	1
*	Orifice, Main Burner #32	9425-069-009	2
2	Gas Control Valve	9857-132-004	1

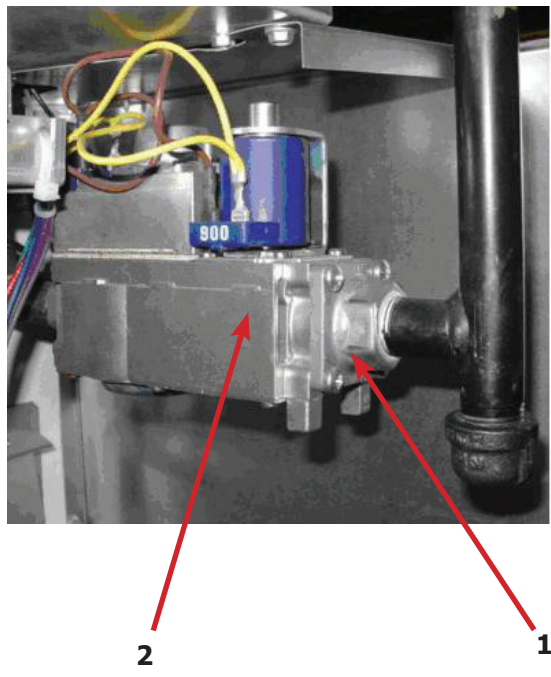

Air Flow Switch Assembly

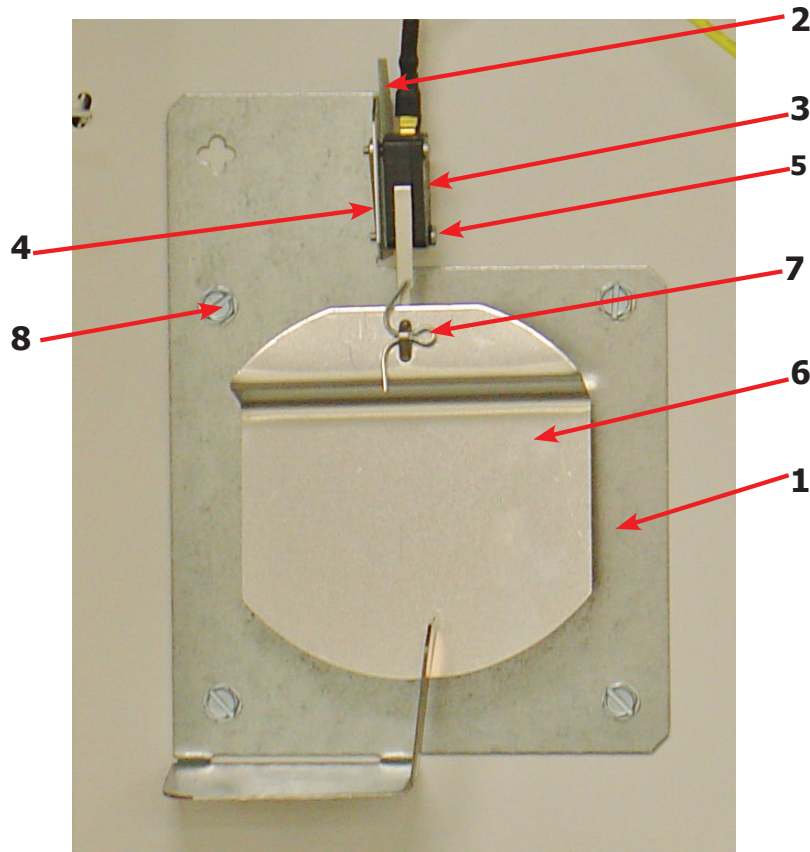

	Description	T-30 SWD-39	QTY
*	Air Flow switch Assy	9801-095-002	1
1	Bracket-Airflow switch	9029-174-001	1
2	Shield-Switch	9550-169-003	1
3	Switch-Micro	9539-461-009	1
4	Nut-Twin, 4-40	8640-401-001	1
5	Screw-.625, 4-40	9545-020-001	1
6	Actuator-Air Flow Switch	9008-007-001	1
7	Pin-Cotter, .09375x.75	9451-169-002	1
8	Screw, 10ABx1/4	9545-008-001	4
*	Harness Assembly, Overtemp/Airflow	9627-861-001	1

Wiring Schematic for Dryer 50hz 230V

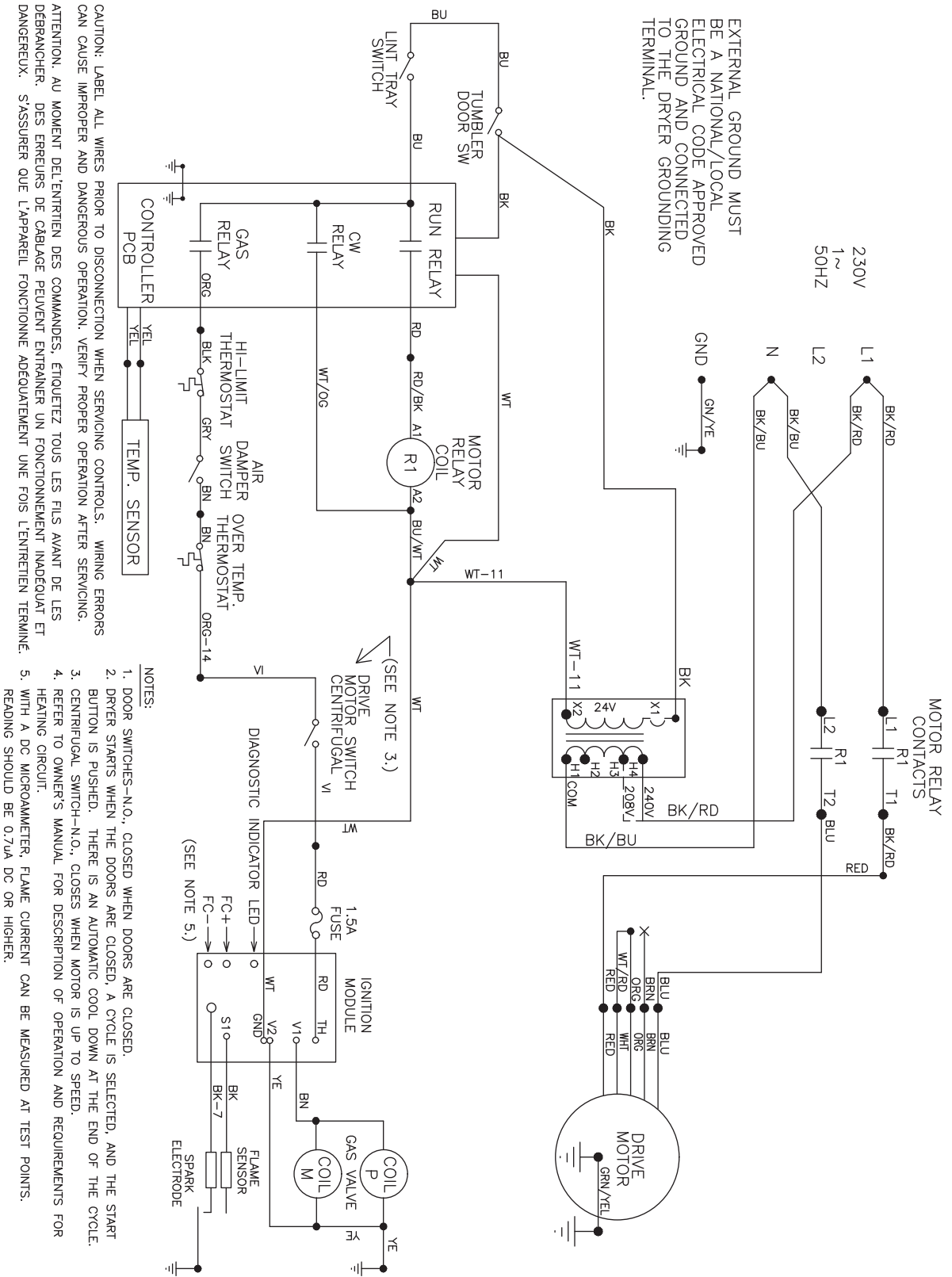

9506-832-001PR

SCHEMATIC

DNS030N_-39_B_X-____X

NOTES:

1. DOOR SWITCHES-N.O., CLOSED WHEN DOORS ARE CLOSED.
2. DRYER STARTS WHEN THE DOORS ARE CLOSED, A CYCLE IS SELECTED, AND THE START BUTTON IS PUSHED. THERE IS AN AUTOMATIC COOL DOWN AT THE END OF THE CYCLE.
3. CENTRIFUGAL SWITCH-N.O., CLOSES WHEN MOTOR IS UP TO SPEED.
4. REFER TO OWNER'S MANUAL FOR DESCRIPTION OF OPERATION AND REQUIREMENTS FOR HEATING CIRCUIT.
5. WITH A DC MICROAMMETER, FLAME CURRENT CAN BE MEASURED AT TEST POINTS. READING SHOULD BE 0.75A DC OR HIGHER.

Wiring Diagram for Dryer 50hz 230V

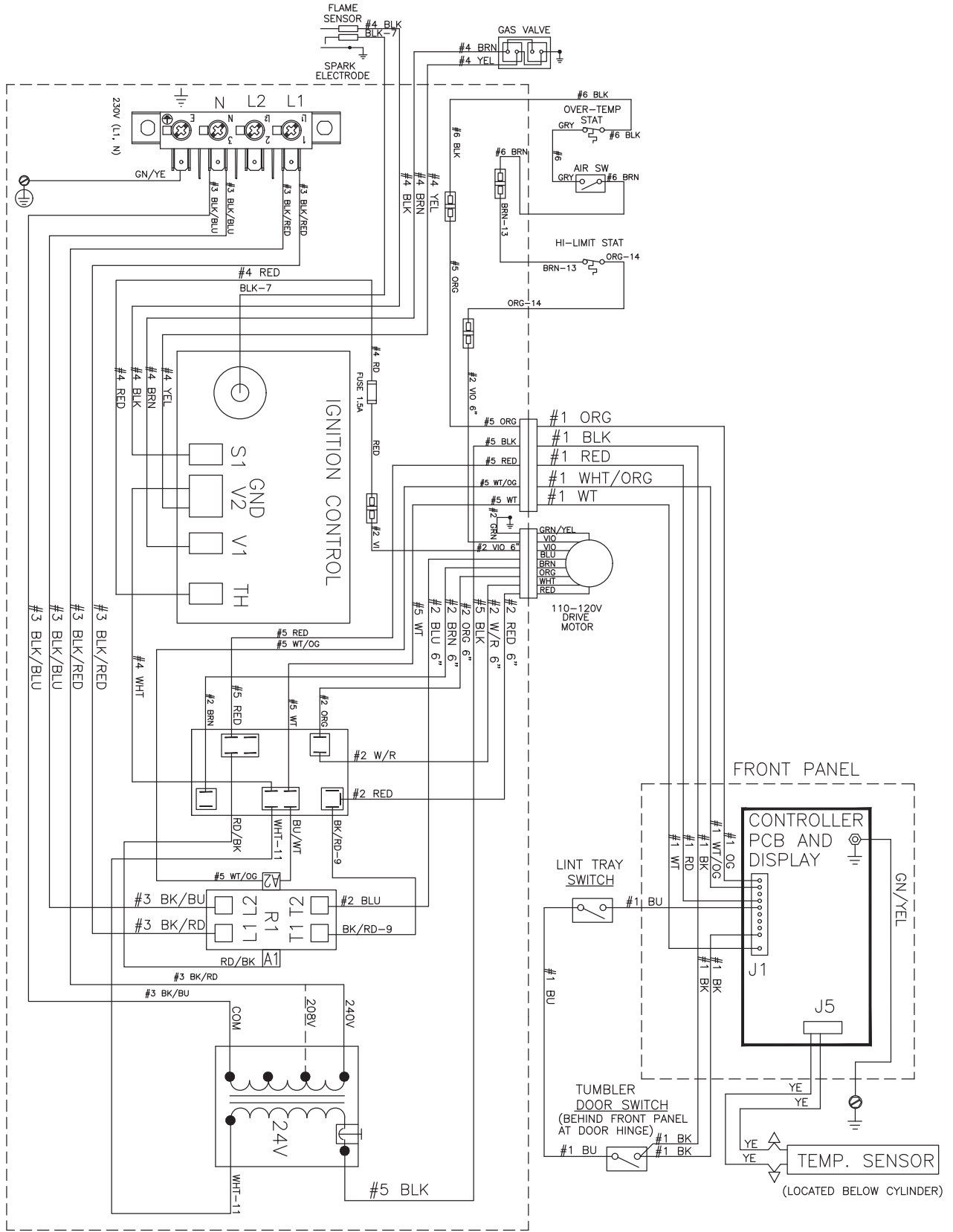

9506-832-001PR WIRING DIAGRAM DNS030N_-39_B_X-____-__X

IMPORTANT: RETAIN THIS ELECTRICAL DIAGRAM FOR SERVICE.

Section: 8

Electric Dryer Parts

Key	Description Electric Dryer Parts	Part Number	Qty
*	RELAY	5192-285-004	1
*	RELAY	5192-296-001	1
*	WIREASY-BLK,#13,8"	8220-057-016	3
*	WIREASY-WHT,#14,5 1/2"	8220-057-021	1
*	WIREASY-BLK,#18,9 1/2"	8220-057-023	6
*	WIREASY-BLK,36"	8220-057-031	1
*	WIREASY-RED,36"	8220-057-032	1
*	WIREASY-BLK,#19,17"	8220-061-011	6
*	WIREASY-WHT/BLK,#12,65"	8220-063-020	1
*	WIREASY-BLK,#15,22"	8220-078-014	1
*	WIREASY-BLK,#17,26"	8220-078-024	1
*	WIREASY-BRN,#7,54"	8220-095-023	1
*	WIREASY-RED,#8,19"	8220-103-002	1
*	MANUAL-OPERATORS,DNS030E	8514-289-001	1
*	DECAL-CLEARANCE	8527-152-001	1
*	TERMINAL-LUG,SOLDERLESS	8652-134-002	1
*	BAFFLE-HOUSING,HEATER	9049-078-001	1
*	BOTTOM-HOUSING,HEATER	9058-026-001	1
*	COVER-PLATE,HEATER	9074-293-001	3
*	COVER-TERMINAL,HEATER	9074-294-001	1
*	DEFLECTOR-BOTTOM,HOUSING	9114-044-001	1
*	DEFLECTOR-WRAPPER,HOUSING	9114-045-001	1
*	DEFLECTOR-BAFFLE	9114-046-001	6
*	FILLER-COVER,TERMINAL	9185-007-001	1
*	GUARD-TOP,RH,ELECHEAT	9208-142-001	1
*	INSULATION	9277-041-014	1
*	JUMPER-FORMED	9295-004-002	2
*	JUMPER-STRAIGHT	9295-005-002	2
*	VARISTOR-COILSUPPRESSOR	9377-003-001	1
*	PLATE-COVER,RECIRCULATION	9452-824-001	1
*	PANEL-LOWER,CONTROL BOX	9454-944-001	1
*	PCBASY-CONTROLLER,OPLDRY-ELECT	9471-016-003	1
*	RAIL-DIN,35X15MM	9488-011-002	1
*	SPACER	9538-049-002	4
*	SCREW-PNHDCR,6BX3/8	9545-031-005	2
*	SCREW-HXWSHDSLTD,8BX1/2	9545-045-002	6
*	SCREW-HXWSHD,8ABX3/8	9545-045-008	10
*	SIDE-HOUSING,CONTROL(RH)	9551-030-001	1
*	SIDE-HOUSING,CONTROL(LH)	9551-031-001	1

Key	Description Electric Dryer Parts	Part Number	Qty
*	SIDE-HOUSING,HEATER(RIGHTHAND)	9551-032-001	1
*	SIDE-HOUSING,HEATER(LEFTHAND)	9551-033-001	1
*	WIREHARNES-OVERTEMP/AIRSWITCH	9627-861-002	1
*	WRAPPER-HOUSING,CONTROL	9636-154-001	1
*	WRAPPER-HOUSING,HEATER	9636-155-001	1
*	BAFFLEASSEMBLY-HOUSING,HEATER	9812-014-001	1
*	CONTROLASSY-OPL,NONREV,ELEC	9857-227-003	1
*	CNTROLASY-T30SWD,ELEC,OPL60HZ	9857-234-003	1
*	BLOCK-POWER,3POLE	9897-037-001	1
*	BLOCK-POWER,1POLE	9897-038-001	1

Key	Description Additional Parts for -71 208 / 60 / 3 / 4 wire + ground 24 kW Electric	Part Number	Qty
*	CIRCUITBREAKER-3POLE	5198-213-002	2
*	INFORMATIVE-DNS030E_-71	6102-018-375	1
*	WIRINGLABEL-SCHEMATIC/DIAGRAM	9506-844-001	1
*	CONTROLSASSY-ELEC/HTR,-71	9857-253-001	1
*	HEATER-ELECTRICELEMENT	9870-093-004	3

Key	Description Additional Parts for -74 240 / 60 / 3 / 4 wire + ground 24 kW Electric	Part Number	Qty
*	CIRCUITBREAKER-3POLE	5198-213-001	2
*	INFORMATIVE-DNS030E_-74	6102-018-376	1
*	WIRINGLABEL-SCHEMATIC/DIAGRAM	9506-845-001	1
*	CONTROLSASSY-ELEC/HTR,-74	9857-253-002	1
*	HEATER-ELECTRICELEMENT	9870-093-003	3

Key	Description Additional Parts for -77 240 / 60 / 1 / 3 wire + ground 20 kW Electric	Part Number	Qty
*	RELAY-125AMP(REISTIVE)CONTACT	5192-294-001	1
*	CIRCUITBREAKER-2POLE	5198-214-001	2
*	INFORMATIVE-DNS030E_-77	6102-018-377	1
*	WIREASY-BLK,8"	8220-057-017	2
*	WIREASY-BLK,#18,91/2"	8220-057-023	4
*	WIREASY-BLK,#19,17"	8220-061-011	4
*	PLATE-REPLACEMENT,HEATER	9452-711-001	1
*	WIRINGLABEL-SCHEMATIC/DIAGRAM	9506-846-001	1
*	CONTROLSASSY-ELEC/HTR,-77	9857-253-003	1
*	HEATER-ELECTRICELEMENT	9870-093-002	2

Key	Description Additional Parts for -78 240 / 60 / 1 / 3 wire + ground 20 kW Electric	Part Number	Qty
*	RELAY-125AMP(RERESISTIVE)CONTACT	5192-294-001	1
*	CIRCUITBREAKER-2POLE	5198-214-002	2
*	INFORMATIVE-DNS030E_-78	6102-018-378	1
*	WIREASY-BLK,8"	8220-057-014	2
*	WIREASY-BLK,#18,91/2"	8220-057-023	4
*	WIREASY-BLK,#19,17"	8220-061-011	4
*	PLATE-REPLACEMENT,HEATER	9452-711-001	1
*	WIRINGLABEL-SCHEMATIC/DIAGRAM	9506-847-001	1
*	CONTROLSASSY-ELEC/HTR,-78	9857-253-004	1
*	HEATER-ELECTRICELEMENT	9870-093-001	2

Key	Description Additional Parts for -79 400 / 50 / 3 / 4 wire + ground 24 kW Electric	Part Number	Qty
*	RELAY-HEATERS,60AMP	5192-291-002	1
*	CIRCUITBREAKER-3POLE,415V,25A	5198-215-002	2
*	INFORMATIVE-DNS030E_-79	6102-018-380	1
*	WIREASY-BLK,#20,5"	8220-060-003	2
*	NUT-SPRING,U-TYPE10Z	8640-442-001	8
*	NUT-SPRING	8640-399-004	4
*	JUMPER-STRAIGHT	9295-005-002	4
*	MOTOR-MRTHON(30#STK),50HZ,LEAD	9376-318-002	1
*	PULLEY-DRIVE,MACHINED	9453-169-009	1
*	WIRINGLABEL-SCHEMATIC/DIAGRAM	9506-849-001	1
*	CNTLASYS-T30SWD,ELEC,OPL50HZ	9857-234-004	1
*	CONTROLSASSY-ELEC/HTR,-79	9857-253-005	1
*	HEATER-ELECELEMENTS,8KW,230V	9870-095-002	3