



DEXTER[®]
LAUNDRY

**USE THE BLUE TABS LOCATED ON THE
RIGHT AND LEFT SIDES OF THE FOLLOWING
DOCUMENT TO ADVANCE TO EACH SECTION.**

V-Series Accessories

WCVD18KCS-10	120 volt	60hz	Single Phase
WCVD18KCS-12	208-240 volts	60hz	Single Phase or Three Phase
WCVD25KCS-12	208-240 volts	60hz	Single Phase or Three Phase
WCVD40KCS-12	208-240 volts	60hz	Single Phase or Three Phase
WCVD55KCS-12	208-240 volts	60hz	Single Phase or Three Phase
WCVD75KCS-12	208-240 volts	60hz	Single Phase or Three Phase

Key	Description	T-300	T-400	T-600	T-900	T-1200	QTY
*	Kit, Door Gasket Expander (large)	9732-139-002	9732-139-002	9732-139-002	9732-139-002	9732-139-002	
*	Kit, Door Gasket Expander (small)	9732-139-001	9732-139-001	9732-139-001	9732-139-001	9732-139-001	
*	Hose, Water Supply 3/8" I.D. x 48" (furnished 18lb, 25lb, 40lb)	9990-027-011	9990-027-011	9990-027-011			2
*	Hose, Water Supply 5/8" I.D. x 48" (furnished 55lb, 75lb)				9990-027-013	9990-027-013	2
*	Washer, Inlet Hose (furnished)	8641-242-000	8641-242-000	8641-242-000	8641-242-000	8641-242-000	2
*	Strainer, Inlet Hose (furnished)	9565-003-001	9565-003-001	9565-003-001	9565-003-001	9565-003-001	2
*	Drain Hose 10ft length x 2-1/4" ID	9242-417-002	9242-417-002	9242-417-002	9242-417-002	9242-417-002	
*	Drain Hose 10ft length x 3" ID	9242-417-003	9242-417-003	9242-417-003	9242-417-003	9242-417-003	
*	Bevel Washer for 5/8" bolt used in installations using angle iron bases	8641-586-002	8641-586-002	8641-586-002	8641-586-002	8641-586-002	
*	Bevel Washer for 3/4" bolt used in installations using angle iron bases	8641-586-003	8641-586-003	8641-586-003	8641-586-003	8641-586-003	
*	Sealing compound	8538-151-001	8538-151-001	8538-151-001	8538-151-001	8538-151-001	
*	TORX#20	8545-051-002	8545-051-002	8545-051-002	8545-051-002	8545-051-002	
*	Special Tool for Removing Coin Acceptor Mtg Screws (T-10 Torx)	8545-051-003	8545-051-003	8545-051-003	8545-051-003	8545-051-003	
*	Flow Restrictors (in dispenser)	9475-002-002	9475-002-002	9475-002-002	9475-002-002	9475-002-002	2
*	Battery (used on Control PCB)	8612-001-001	8612-001-001	8612-001-001	8612-001-001	8612-001-001	
*	Trailer Hitch Tool (55lb, 75lb)				8545-056-001	8545-056-001	
*	VFD Filter options (1 phase) 120v	9732-233-001					
*	VFD Filter options (3 phase)	9732-234-001	9732-231-001	9732-231-001	9732-231-001	9732-231-001	
*	VFD Filter options (1 phase) 220VAC	9732-235-001	9732-232-001	9732-232-001	9732-232-001	9732-232-001	
*	Bearing & Seal Kit	9732-219-001	9732-219-003	9732-219-005	9732-219-007	9732-219-007	
*	E-Stop Conversion Kit (V to A-Series)	9732-226-001	9732-226-003	9732-226-005	9732-226-007	9732-226-009	
*	V & A-Series Conversion to Manual Start for Small Vault	9732-224-001	9732-224-001	9732-224-001	9732-224-001	9732-224-001	

Kits, Assemblies, & Common Parts

Component	Part Number
Coin Acceptor Components	
Mechanical Coin Acceptor	9021-001-010
Coin Drop Screws	9545-053-002
Retainer, Coin Acceptor	9486-149-001
Loading Door & Door Lock Components	
Door Glass Gasket (Standard Door)	9206-419-001
Door Glass Gasket (Small Door)	9206-411-002
Door Lock Solenoid Assembly	9922-011-001
Door Handle Only	9244-080-003
Kit - Door Latching Assy. & Cam (replaces original Door Latching Assembly)	9732-347-001
Kit - Door Cam Replacement	9732-346-002
Kit - Locking Pawl Replacement	9732-346-001
Kit - Door Gasket Expander Kit (Small)	9732-139-001
Kit - Door Gasket Expander Kit (Large)	9732-139-002
Electrical Components	
Transformer, Main	8711-004-001
Transformer, Control	8711-009-001
Main Control Board	9473-004-007
VFD & Breaking Resistors Components	
Breaking Resistor 200 Ohms	9483-004-002
Breaking Resistor 160 Ohms	9483-004-003
Delta E Drive Display	9150-044-001
MS 300 VFD Display	9150-058-001
Data Cable (56")	9806-015-003
Drain & Water Valve Components	
Kit - 3" Drain Valve Seal Replacement	9732-327-001
Drain Valve 3"	9379-202-001
Drain Valve 2"	9379-199-001
Water Valve (Dual)	9379-183-012
Water Valve (Single Mueller)	9379-194-001
Diaphragm (Dual)	9118-049-003
Diaphragm (Single Mueller)	9118-055-001
Cabinet Components	
Front Panel Screw	9545-008-014
Front Panel Finisher Washer	8641-585-001
Front Panel Spring Nut	8640-399-008
Top Soap Box Screw	9545-008-012
Top Soap Box Spring Nut	8640-399-007
5/16 Hex Screw, Common	9545-008-026
Top Lock Key #6324	9306-025-001
Cylinder Plug (1.5" Plastic)	9456-041-007



Section 8:

Parts Data

V-Series Vended

Wiring Harness Part # by Model

Part Number	Description	
9794-001-001	Wiring Harness, (Add Bleach Lite assy included) ALL.....	1
9627-791-003	Wiring Harness, DoorLock WCVD-18,WCVD-25.....	1
9627-791-004	Wiring Harness, Doorlock WCVD-40,WCVD-55, WCVD-75.....	1
9627-792-001	Wiring Harness,CoinDrop Mech ALL.....	1
9627-796-001	Wiring Harness, Drain,Thermo,DoorSol WCVD-18,WCVD-25,WCVSD-40....	1
9627-796-002	Wiring Harness, Drain,Thermo,Door Sol. WCVD-55,WCVD-75.....	1
8654-125-001	Clamp, Cable- 1/4 Dia. ALL.....	1
8653-074-001	Connector, Clear In-Line ALL.....	AR
9806-015-001	Data Cable ALL xcpt. 75Ib.....	1
9806-015-003	Data Cable WCVD-75.....	1
9627-793-001	Wiring Harness P20/P21 ALL.....	1
9627-794-001	Wiring Harness ,P8/P16 ALL.....	1
9627-795-001	Wiring Harness WaterValve/P19 WCVD-18,WCVD-25.....	1
9627-795-002	Wiring HarnessWaterValve/P19WCVD-55,WCVD-75,WCVD-40.....	1
9627-797-001	Wiring Harness ,LED PCB ALL.....	1
9627-800-001	Wiring Harness ,PS/pressure WCVD-18.....	1
9627-801-001	Wiring Harness ,PS/pressure WCVD-25.....	1
9627-802-001	Wiring Harness ,PS/pressure WCVD-40.....	1
9627-803-001	Wiring Harness, PS/pressure WCVD-55, WCVD-75.....	1
8220-064-023	Wiring Assembly Yel. 32" ALL except 75.....	2
8220-064-040	Wiring Assembly Yel. 64" WCVD-75.....	2
8220-062-025	Wiring Assembly Red 28" WCVD-40,WCVD-55.....	2
8220-062-032	Wiring Assembly Red 41" WCVD-75.....	2
8220-001-282	Wiring Assembly Red 20" WCVD-18,WCVD-40,WCVD-25.....	2
8220-118-001	Wiring Assembly Vio. 24" WCVD-18.....	2
8220-108-007	Wiring Assembly Wht/Brn 8" WCVD-75.....	1
8220-123-001	Wiring Assembly Jumper Yel WCVD-55,WCVD-18,WXCVD-40,WCVD-25....	1
8220-128-001	Wiring Assembly Jumper Yel WCVD-75.....	1
8220-062-025	Wiring Assembly Red 28" WCVD-55,WCVD-40.....	2
8220-062-028	Wiring Assembly Blk. 17" ALL.....	1
8220-062-027	Wiring Assembly Red 17" ALL.....	1
8220-063-008	Wiring Assembly Wht/Grn 16" WCVD-55,WCVD-40,WCVD-25.....	1
8220-063-009	Wiring Assembly Blu 16" WCVD-55,WCVD-40,WCVD-25.....	1
8220-117-001	Wiring Assembly Jumper BLK.WCVD-40,WCVD-75,WCVD-25.....	2
9631-381-018	Wiring Assembly Red 7" ALL.....	1
8220-090-009	Wiring Assembly Blu/Wht ALL.....	1
8220-001-231	Wiring Assembly Blk/Blu ALL.....	1
8220-001-478	Wire Assembly Green 7" WCVD-18.....	1
9627-747-002	Harness Power Terminal Block WCVD-55,WCVD-75.....	1
9627-747-003	Harness Power Terminal Block WCVD-25, WCVD-40.....	1
9627-831-001	Harness Power Terminal Block WCVD-18	1

Cabinet and Front Panel Group Part # by Model

Key	Part Number	Description	Qty
1	9454-656-001	Panel, Side (Left or Right) - stainless WCVD-25	2
1	9454-672-001	Panel, Side (Left or Right)-stainless WCVD-55	4
1	9454-635-005	Panel, Right Side-stainless WCVD-18	1
1	9454-635-006	Panel, Left Side - stainless WCVD-18	1
1	9989-449-001	Panel, Side (Left or Right)-stainless WCDV-40	2
1	9454-760-001	Panel, Side (Left or Right)-stainless WCVD-75	4
2	9545-018-013	Screw, (Side Panel to Base) WCVD-25	6
2	9545-018-013	Screw, (Side Panel to Base) WCVD-40/55/75	8
2	9545-018-018	Screw, (Side Panel to Base) WCVD-18	6
2	8640-414-006	Nut, Hex 1/4-20 UNC WCVD-18/25	6
2	8640-414-006	Nut, Hex 1/4-20 UNC WCVD-40/55/75	8
3	9029-066-001	Bracket, Side Panel WCVD-18/25/40	1
*	8640-413-002	Nut, Hex WCVD-18/25/40	2
*	9545-008-031	Screw WCVD-18/25/40	2
4	9454-659-001	Panel Assy, Front WCVD-25	1
4	9454-671-001	Panel Assy, Front WCVD-55	1
4	9454-763-001	Panel Assy, Front WCVD-75	1
4	9454-728-001	Panel Assy, Front WCVD-18	1
4	9454-669-001	Panel Assy, Front WCVD-40	1
5	9059-063-002	Band, Edge Protector WCVD-25/40/55/75	1
5	9059-063-004	Band, Edge Protector WCVD-18	1
*	9051-053-001	Bumper Loading Door WCVD-75	1
*	9545-008-024	Screw, Hex- To Control Panel	2
*	8640-399-005	Nut, Spring- To Control Panel 10/32	2
6	9545-008-014	Screw, Flat Head- Front to Sides	2
6	8641-585-001	Washer, Finish	2
*	8640-399-008	Nut, Spring- To Front Panel	2
*	9545-008-023	Screw, Guide	2
7	8502-624-002	Label, Door Opening	1
8	9989-474-001	Panel, Control (Mounts Nameplate) WCVD-25	1
8	9989-476-001	Panel, Control (Mounts Nameplate) WCVD-55, WCVD-75	1
8	9989-473-001	Panel, Control (Mounts Nameplate) WCVD-18	1
8	9989-475-001	Panel, Control (Mounts Nameplate) WCVD-40	1
*	9545-008-026	Screw, Control Panel to Sides	4
9	9412-113-001	Nameplate Decal, Control Panel (one piece) WCVD-25	1
9	9412-112-001	Nameplate Decal, Control Panel (one piece) WCVD-18	1
9	9412-114-001	Nameplate Decal, Control Panel (one piece) WCVD-40	1
9	9412-115-001	Nameplate Decal, Control Panel (one piece) WCVD-55	1
9	9412-130-001	Nameplate Decal, Control Panel (one piece) WCVD-75	1
10	9454-761-001	Panel Top Front WCVD-75	1
10	9454-762-001	Panel Top Rear WCVD-75	1
10	9454-736-001	Panel Top WCVD-55	1
10	9454-733-001	Panel Top WCVD-18	1
10	9454-735-001	Panel Top WCVD-40	1
10	9454-734-001	Panel, Top WCVD-25	1
11	8650-012-003	Lock, Top (w/Key) WCVD-18,WCVD-25,WCVD-40	1
11	8650-012-003	Lock, Top (w/key) WCVD-55, WCVD-75	2
*	6292-006-007	Key, Top- # 6324	1
*	9095-038-001	Cam, Lock-Top	1
*	8640-426-001	Nut, 9/32	1
*	8641-581-008	Washer	1
12	9108-096-001	Door, Lower Service WCVD-18	1
12	9108-099-001	Door, Lower Service WCVD-55,WCVD-75	1
*	9108-097-001	Door, Lower Service WCVD-40	1
12	9108-097-001	Door, Lower Service WCVD-25	1

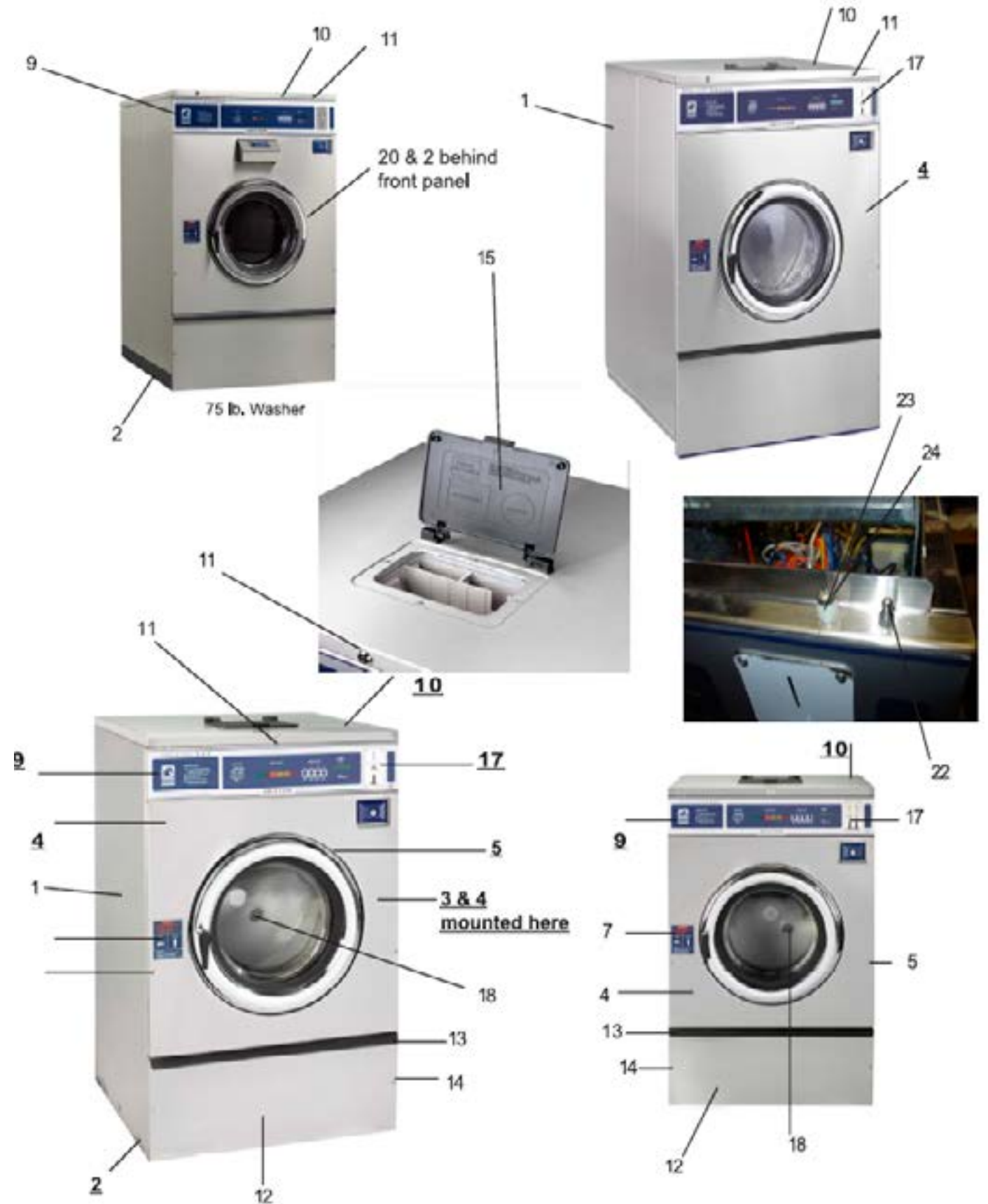

Rear View Access Part # WCVD-18, WCVD-25, WCVD-40

Key	Part Number	Description.....	Qty
1	9376-305-001	Drive Motor, 3 Phase (Inverter duty) WCVD-25,WCVD-40.....	1
1	9376-304-001	Drive Motor, 3 Phase (Inverter duty) WCVD-18.....	1
2	9497-222-002	Rod, Motor Mtg WCVD-18,WCVD-25.....	1
2	9497-222-004	Rod, Motor Mtg WCVD-40	1
*	9545-029-005	Screw (end of motor rod) WCVD-18,WCVD-25,WCVD-40.....	1
*	8641-582-014	Lockwasher (end of motor rod)WCVD-18,WCVD-25,WCVD-40.....	1
3	9076-052-002	Collar, Shaft (w/set screws).....	2
4	9453-170-003	Pulley, Motor WCVD-25,WCVD-40.....	1
4	9453-169-012	Pulley, Motor WCVD-18.....	1
*	9545-028-015	Set Screw,Sq.Hd(motor pulley)WCVD-18,WCVD-25,WCVD-40.....	2
*	9487-234-001	Tolerance Ring WCVD-25.....	1
*	9487-234-002	Tolerance Ring WCVD-18.....	1
*	9487-234-003	Tolerance Ring WCVD-40.....	1
5	9453-168-003	Pulley, Driven WCVD-40.....	1
5	9453-168-004	Pulley, Driven WCVD-25.....	1
5	9908-041-002	Pulley,Ass'y Driven WCVD-18.....	1
6	9545-017-009	Screw 1/2-13x1 1/4" WCVD-18,WCVD-25.....	1
7	8641-581-026	Washer, Flat 1/2" WCVD-18,WCVD-25.....	1
6	8641-582-016	Lockwasher 1/2" WCVD-18,WCVD-25.....	1
6	9545-060-001	Screw 5/8-11x1 1/2" WCVD-40.....	1
7	8641-581-032	Washer, Flat 5/8x2 1/4" WCVD-40.....	1
6	8641-582-018	Lockwasher 5/8" WCVD-40.....	1
8	9040-076-004	Drive Belt WCVD-18.....	1
8	9040-076-005	Drive Belt WCVD-25,WCVD-40.....	2
9	9081-135-001	Channel, Rear WCVD-25.....	1
9	9081-132-001	Channel, Rear WCVD-18.....	1
9	9081-134-001	Channel, Rear WCVD-40.....	1
10	9545-008-026	Screw.....	4
*	8640-399-008	Nut, Spring.....	4
11	9242-449-002	Hose, Overflow to drain WCVD-25 WCVD-40,WCVD-18.....	1
12	9242-463-003	Hose, Overflow Vent 12 1/4" WCVD-40.....	1
12	9242-463-001	Hose, Overflow Vent 9" WCVD-18.....	1
12	9242-463-002	Hose, Overflow Vent 11" WCVD-25.....	1
13	8654-117-008	Clamp, Hose Vent.....	1
13	8654-029-000	Clamp, Hose overflow to drain.....	2
*	9610-001-001	Vacuum Breaker ALL MODELS.....	1
*	9989-446-002	Panel Assy., Back WCVD-25.....	1
*	9989-446-001	Panel Assy., Back WCVD-40.....	1
*	9454-632-001	Panel, Back WCVD-18.....	1
*	9545-008-026	Screw Panel Mtg.#10Bx1/2".....	10
*	8640-399-004	Nut, Spring WCVD-18,WCVD-25.....	10
*	8640-399-008	Nut, Spring WCVD-40.....	6
*	9545-030-002	Screw, to Base WCVD-40.....	3
14	9242-175-000	Hose, Pressure Switch WCVD-18,WCVD-25.....	1
14	9242-175-002	Hose, Pressure Switch WCVD-40.....	1
*	8654-117-015	Clamp, Pressure Sw. Hose.....	1
15	5198-211-004	Circuit Breaker, 1.5 amp optional.....	0
*	9200-001-002	Fuseholder.....	1
*	8636-018-001	Fuse 1.5 amp.....	1
16	9242-458-001	Hose, Vacuum Breaker to tub WCVD-18.....	1
16	9242-458-002	Hose, Vacuum Breaker to Tub WCVD-25, WCVD-40.....	1
*	8654-117-014	Clamp, Hose to Vacuum Breaker WCVD-18, WCVD-40.....	1
*	8654-117-008	Clamp, Hose to Vacuum Breaker WCVD-25.....	1
17	9029-027-003	Strap Bracket, Motor Tension.....	1

* Not Illustrated

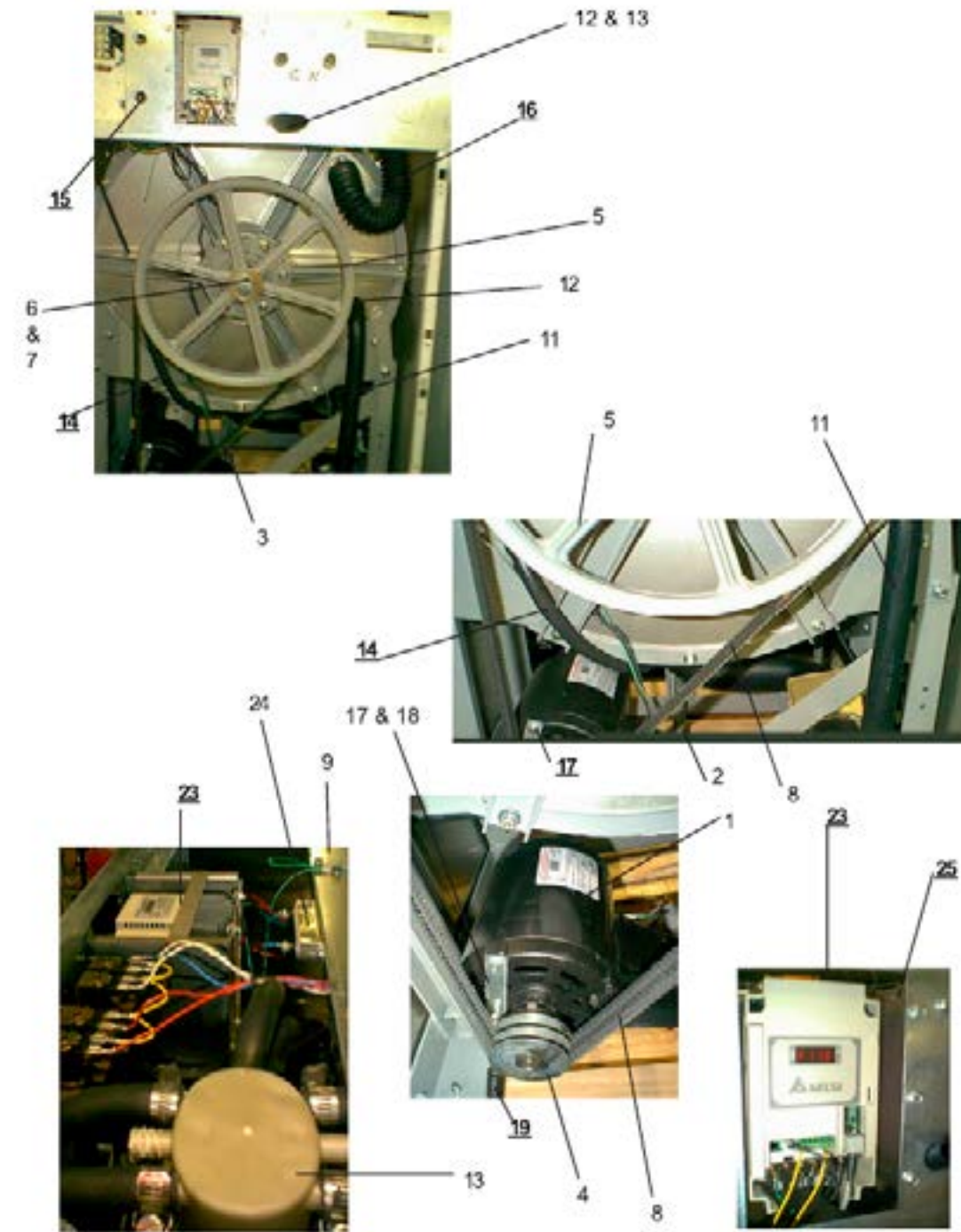

Key	Part Number	Description.....	Qty
18	8640-413-002	Nut, Strap to Motor.....	1
18	8641-581-006	Washer.....	1
19	9534-319-002	Spring, Belt Tension.....	1
20	9545-055-001	Bolt, Eye (1/4"-20x1/2").....	1
21	8640-414-003	Nut, 1/4 Elastic Stop.....	1
23	9375-004-002	VFD Delta "S" drive WCVD-18-10 120 volt.....	1
23	9375-005-002	VFD Delta "S" drive WCVD-18-12.....	1
23	9375-007-002	VFD Delta "S" drive WCVD-25.....	1
23	9375-007-003	VFD Delta "S" drive WCVD-40.....	1
24	9483-004-002	Braking resistors (200 ohm) WCVD-18.....	1
24	9483-004-002	Braking resistors (200 ohm) WCVD-25,WCVD-40.....	2
25	9985-177-001	Bracket ass'y(drive mounting) WCVD-25,WCVD-40,WCVD-18.....	1

Rear View Access Part # WCVD-55, WCVD-75

Key	Part Number	Description.....	Qty
2	9242-449-003	Hose, Overflow Vent 14" WCVD-75,WCVD-55.....	1
*	9242-463-004	Hose, Overflow to drain WCVD-75, WCVD-55.....	1
3	9453-176-005	Pulley, Driven WCVD-55,WCVD-75.....	1
4	9053-078-002	Bushing, TaperWCVD-55,WCVD-75.....	1
5	9545-029-011	Screw.....	3
6	8641-582-003	Lockwasher.....	3
7	9040-079-003	Drive Belt WCVD-75.....	1
7	9040-079-002	Drive Belt WCVD-55.....	1
8	9081-140-001	Channel, Rear WCVD-75.....	1
8	9081-109-001	Channel, Rear WCVD-55.....	1
9	9545-008-026	Screw.....	4
9	8640-399-008	Nut, Spring.....	4
10	8654-029-000	Clamp, Hose.....	2
11	9341-046-001	Link, Chain.....	1
11	9099-012-003	Chain (Spring Tension) WCVD-55.....	1
11	9099-012-004	Chain (Spring Tension) WCVD-75.....	1
12	9497-222-004	Rod, Motor Mtg WCVD-55,WCVD-75.....	1
12	9545-029-005	Screw (end of motor rod).....	1
12	8641-582-014	Lockwasher (end of motor rod).....	1
15	8640-399-008	Nut, Spring WCVD-55.....	6
15	8640-399-008	Nut, Spring WCVD-75.....	10
16	9545-030-002	Screw, to Base 1/4x3/4" WCVD-55,WCVD-75.....	3
17	9242-175-003	Hose, Pressure Switch WCVD-55.....	1
17	9242-175-006	Hose, Pressure Switch WCVD-75.....	1
*	8654-117-015	Clamp, Pressure Sw. Hose.....	1
19	5198-211-004	Circuit Breaker, 1.5 amp WCVD-55 (optional).....	0
*	9200-001-002	Fuseholder.....	1
*	8636-018-001	Fuse 1.5 amp WCVD-55.....	1
*	8636-018-004	Fuse 2.5 amp WCVD-75.....	1
20	9242-458-003	Hose, Vacuum Breaker to tub WCVD-55, WCVD-75.....	1
*	8654-117-014	Clamp, Hose to Vacuum Breaker WCVD-75, WCVD-55.....	1
22	9534-151-000	Spring, Belt Tension.....	1
23	9545-055-001	Bolt, Eye (1/4"-20 x 2 1/2").....	1
24	8640-414-003	Nut, 1/4 Elastic Stop.....	1
25	9375-009-002	VFD Delta "S" drive WCVD-55.....	1
25	9375-009-005	VFD Delta "S" drive WCVD-75.....	1
*	9483-004-003	Braking resistors (160 ohm) WCVD-55, WCVD-75.....	2
*	9985-115-001	Bracket ass'y(drive mounting) WCVD-55.....	1
*	9029-150-001	Bracket ass,y (drive mounting) WCVD-75.....	1
27	9376-298-001	Drive Motor WCVD-55, WCVD-75 3 phase inverter dot.....	1
28	9076-052-002	Collar, Shaft (w/set screws).....	2
29	9453-175-002	Pulley, Motor WCVD-75,WCVD-55.....	1
30	9053-077-001	Bushing, Split Taper WCVD-55,WCVD-75.....	1
31	9545-018-021	Screw WCVD-75.....	3
31	9545-018-024	Screw WCVD-55.....	3
*	9989-455-001	Panel Assy., Back WCVD-55.....	1
*	9989-491-001	Panel Assy, Back WCVD-75.....	1
*	9545-008-026	Screw Panel Mtg.#10Bx1/2" WCVD-55.....	9
*	9545-008-026	Screw Panel Mtg.#10Bx1/2" WCVD-75.....	13

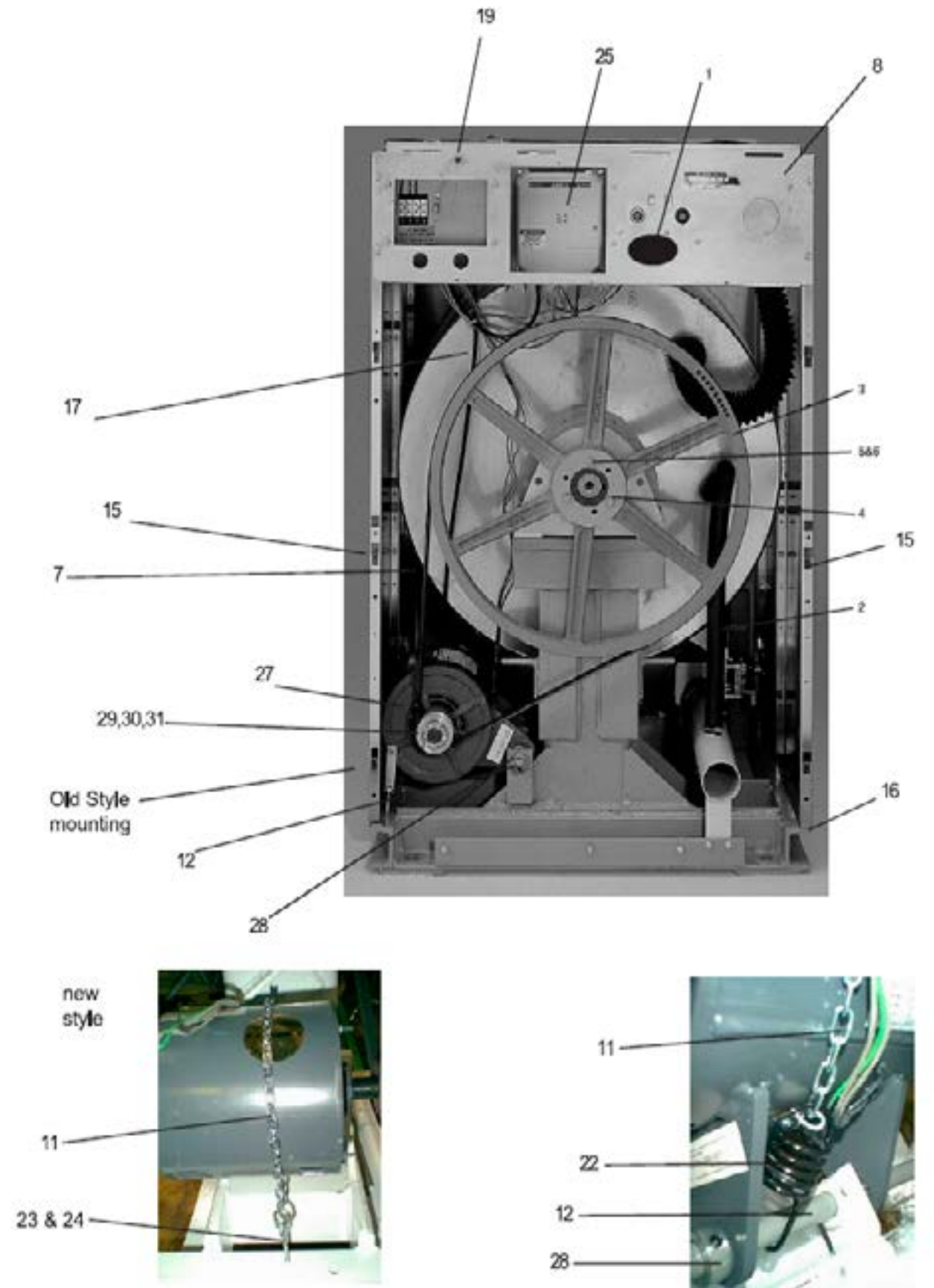

Cylinder, Seals, & Bearings Part # WCVD-18, WCVD-25, WCVD-40

Key	Part Number	Description.....	Qty
*	9803-179-002	Housing, Bearing- Assembly (includes items #2-#6)WCVD-25.....	1
2	9241-169-002	Housing, Bearing.....	1
3	9036-159-002	Bearing, Front (LARGE).....	1
4	9036-159-001	Bearing, Rear (SMALL).....	1
5	9538-158-001	Spacer, Bearing.....	1
6	9487-238-001	Ring, Bearing Retainer (internal type).....	1
*	9803-182-001	Housing, Bearing-Assembly (includes items #2-#6) WCVD-18.....	1
2	9241-174-002	Housing, Bearing.....	1
3	9036-159-001	Bearing, Front (LARGE).....	1
4	9036-159-003	Bearing, Rear (SMALL).....	1
5	9538-161-001	Spacer, Bearing.....	1
6	9487-238-002	Ring, Bearing Retainer.....	1
*	9803-186-001	Housing, Bearing-Assembly (includes items #2-#6) WCVD-40.....	1
2	9241-180-002	Housing, Bearing.....	1
3	9036-159-005	Bearing, Front (LARGE).....	1
4	9036-159-004	Bearing, Rear (SMALL).....	1
5	9538-167-001	Spacer, Bearing.....	1
6	9487-238-003	Ring, Bearing Retainer (Internal).....	1
7	9732-137-001	BackAssy, Tub 2 piece WCVD-18.....	1
7	9732-137-002	BackAssy, Tub 2 piece WCVD-25.....	1
7	9732-137-003	BackAssy, Tub 2 piece WCVD-40.....	1
9	9532-140-004	Seal, Primary WCVD-18.....	1
8	9532-140-005	Seal, Secondary WCVD-18.....	1
8	9532-140-003	Seal, Secondary WCVD-25.....	1
9	9532-140-002	Seal, Primary WCVD-25, WCVD-40.....	1
8	9532-140-006	Seal, Secondary WCVD-40.....	1
10	9950-047-001	Ring, Seal Mounting WCVD-18.....	1
10	9950-042-001	Ring, Seal Mounting WCVD-25.....	1
10	9950-048-001	Ring, Seal Mounting WCVD-40.....	1
11	9487-261-001	Tub Back Mating Ring WCVD-18.....	1
11	9487-261-002	Tub Back Mating Ring, WCVD-25.....	1
11	9487-261-003	Tub Back Mating Ring, WCVD-40.....	1
12	9545-017-009	Bolt, 1/2" Tub End of Bearing Housing (1/2" x 1 1/4") WCVD-25.....	6
12	8640-417-002	Nut 1/2".....	6
12	8641-582-016	Lockwasher 1/2" (ext. tooth).....	6
12	9545-060-001	Bolt 5/8-11x1 1/2" Tub end of bearing housing WCVD-40.....	6
12	8640-425-001	Nut 5/8".....	6
12	8641-582-018	Lockwasher 5/8".....	6
13	9991-049-002	SupportArmAssy, Bearing Housing WCVD-18.....	6
13	9991-048-002	Support Arm Assy., Bearing Housing WCVD-25.....	6
13	9991-056-002	SupportArmAssy, Bearing Housing WCVD-40.....	6
16	9545-029-003	Bolt Pulley End of Bearing Housing (3/8" x 1 1/2") WCVD-25.....	6
16	8640-415-004	Nut, Flange Locking 3/8" WCVD-25.....	6
16	9545-059-003	Bolt Pulley end of bearing housing 7/16-14x2" WCVD-40.....	6
16	8640-416-005	Nut, Flange Locking 7/16" WCVD-40.....	6
15	9453-168-003	Puley, Driven WCVD-40.....	1
15	9453-168-004	Pulley, Driven WCVD-25.....	1
15	9908-041-002	Pulley, Driven WCVD-18.....	1
*	9487-234-001	Ring, Tolerance WCVD-25 Between shaft and pulley.....	1
*	9487-234-002	Ring, Tolerance WCVD-18 Between shaft and pulley.....	1
*	9487-234-003	Ring, Tolerance WCVD-40 Between shaft and pulley.....	1
16	8641-581-026	Washer 1/2" WCVD-18,WCVD-25.....	1
17	9545-017-009	Bolt 1/2-13 x 1 1/4".....	1
18	8641-582-016	Lockwasher 1 /2" Ext. tooth.....	1
16	8641-060-001	Bolt 5/8-11x1 1/2" WCVD-40.....	1
17	8641-581-032	Washer 5/8".....	1
18	8641-582-018	Lockwasher 5/8 Ext. tooth	1

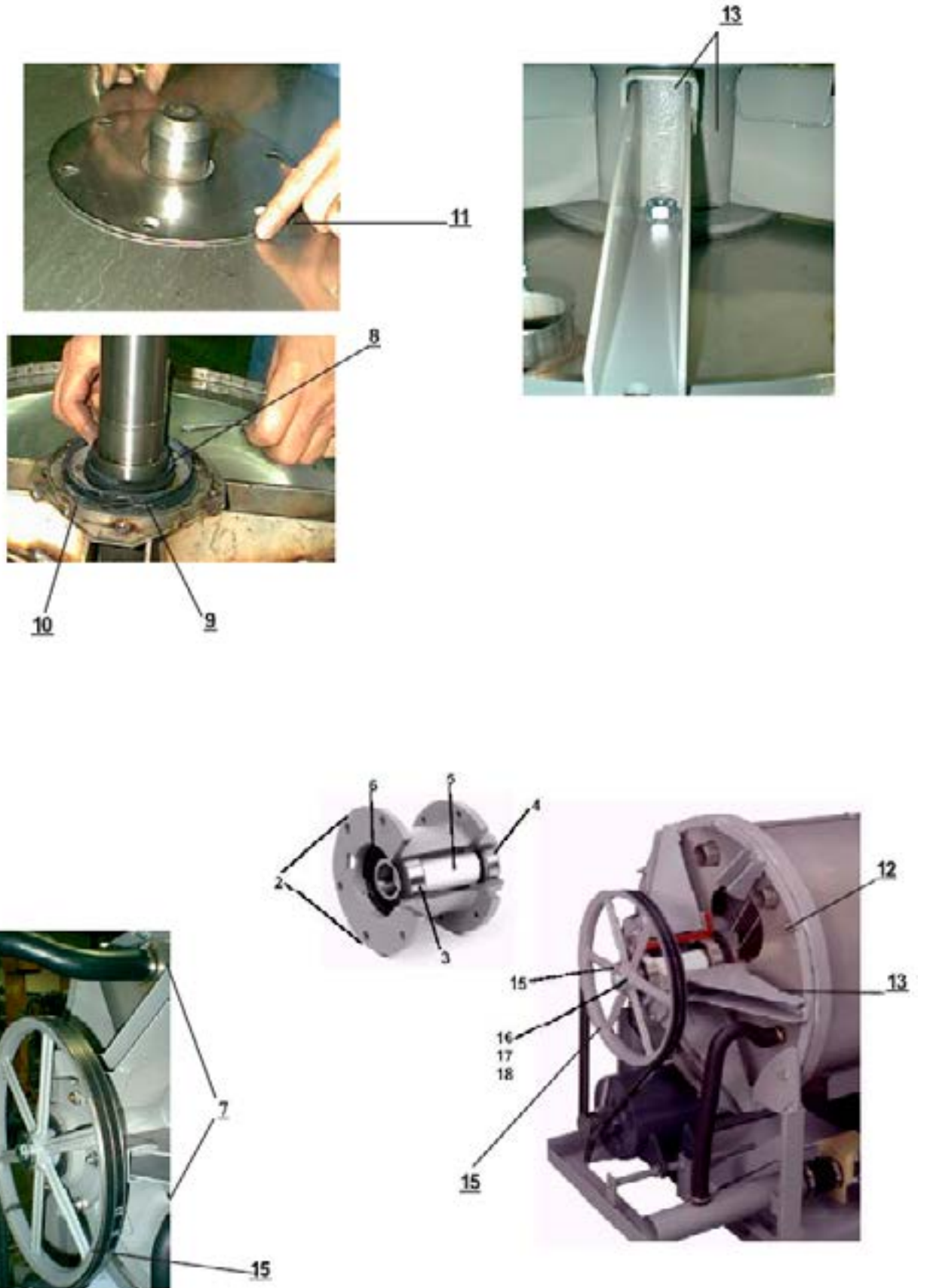

Cylinder, Seals, & Bearings Part # WCVD-55, WCVD-75

Key	Part Number	Description.....Qty
1	9848-116-001	Cylinder, Assy WCVD-55.....1
1	9848-125-001	Cylinder, Assy WCVD-75.....1
*	9869-009-001	Tub and Cylibnder Assy. WCVD-55.....1
*	9869-015-001	Tub and Cylinder Assy. WCVD-75.....1
*	9803-187-001	Housing&Bearing Assembly WCVD-55,WCVD-75 (includes items #2-#6).....1
2	9241-181-004	Housing, Bearing.....1
3	9036-159-006	Bearing, Front.....1
4	9036-159-005	Bearing, Rear.....1
5	9538-170-001	Spacer, Bearing.....1
6	9487-238-004	Ring-Retainer, Internal.....1
7	9545-057-002	Screw, Bearing Housing, 3/4-10 x 3 WCVD-55,WCVD-75.....6
7	8641-581-033	Washer, Flat- To Frame WCVD-55.....6
7	8641-582-020	Washer, External Tooth WCVD-55.....6
7	8640-418-003	Nut 3/4-10 WCVD-55,WCVD-75.....6
8	9532-140-008	Seal, Secondary (small) WCVD-55,WCVD-75.....1
9	9532-140-007	Seal, Primary (large) WCVD-55,WCVD-75.....1
10	9950-052-001	Ring, Seal Mtg WCVD-55,WCVD-75.....1
11	9487-261-004	Ring, Seal Tub Back WCVD-55,WCVD-75.....1
12	9545-059-004	Screw, 7/16-14 x 1 SS (Tub Back to Bearing Housing) WCVD-55, WCVD-75.....6
12	8641-581-034	Washer, Flat WCVD-55,WCVD-75.....6
13	9453-176-005	Pulley, Driven WCVD-55,WCVD-75.....1
14	9053-078-002	Bushing, Taper WCVD-55,WCVD-75.....1
15	9545-029-011	Screw 3/8-16-2.....3
15	8641-582-003	Lockwasher spring 3/8.....3
16	9241-466-002	Hose, Fill 19" WCVD-75.....2
17	8654-117-017	Clamp.....4
18	8641-588-001	Washers Spherical 3/4 (Male half) WCVD-75 Required.....6
18	8641-588-002	Washers Spherical 3/4 (Female half) WCVD-75 Required.....6

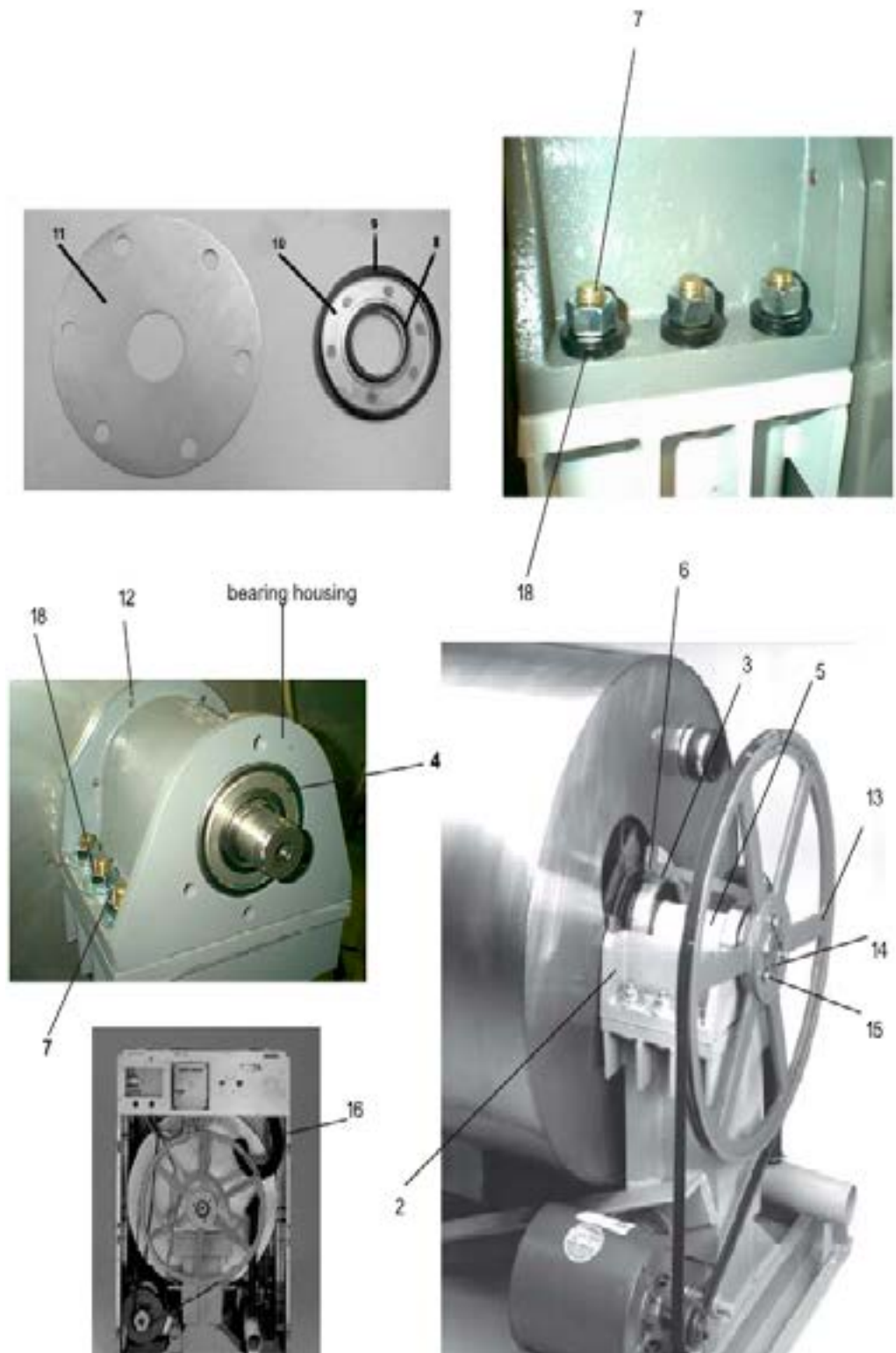

Door Latching & Lock Group (All Models)

Key	Part Number	Description.....	Qty
*	9885-023-001	Lock Assy, Complete (includes #1 thru #22).....	1
*	9732-347-001	Door Lock & Cam Kit (replaces 9885-023-001).....	1
1	9982-284-001	Plate Assy, Door Lock.....	1
2	8641-581-030	Washer, Flat.....	1
3	9008-005-001	Actuator, Latching Switch.....	1
4	9450-002-002	Pawl, Locking.....	1
5	8641-569-003	Washer, Spring.....	1
6	9487-200-004	Ring, Retaining.....	1
7	9029-035-001	Bracket, Switch.....	1
8	8640-413-002	Nut, Hex 10-32 UNF.....	2
9	9534-364-002	Spring, Actuating.....	1
10	9545-012-020	Screw, Hx. 10-32 x 1".....	1
11	8640-413-004	Nut, Elastic Stop 10-32.....	2
12	9534-364-001	Spring, Return.....	2
13	9451-193-001	Pin, Guide.....	1
14	9487-200-005	Ring, Retaining.....	1
15	8641-581-031	Washer.....	2
16	9539-461-008	Switch, Latching Sensing.....	1
17	9550-169-003	Shield, Switch.....	3
18	9545-020-001	Screw 4-40 x 5/8".....	2
18	8640-401-001	Nut, Twin.....	1
19	9539-461-007	Switch, Locking Sensing.....	2
20	9008-006-002	Actuator, Switch.....	2
21	9545-020-003	Screw 4-40 x 1 1/8".....	2
21	8640-401-001	Nut, Twin 4-40.....	1
22	9451-181-004	Pin, Dowel.....	1
*	9552-037-001	Shim, Door Lock, Thin.....	AR
*	9552-037-002	Shim, Door Lock, Thick.....	AR
*	9545-018-004	Screw, Lock mtg 1/4"-20 x 3/4".....	3
*	8641-582-007	Lockwasher 1/4" Ext tooth.....	3
*	9922-011-001	Solenoid Ass'y, Door Locking (includes 23 thru 32).....	1
23	9029-073-001	Bracket, (Door Locking Solenoid).....	1
24	9985-169-001	Bracket Ass'y, Solenoid Slide.....	1
25	9536-074-001	Solenoid 120V 60 hz.....	1
26	9545-008-001	Screw, Solenoid Mtg.....	4
27	9540-033-002	Stop, Door Lock Solenoid.....	1
28	9545-061-001	Screw, Shoulder.....	1
28	8640-411-003	Nut, Keps #6.....	1
29	9586-001-001	Thermoactuator 120 V.....	2
30	9545-031-011	Screw #6 x 5/16".....	4
31	9538-157-004	Spacer, Plastic.....	1
31	9538-166-004	Spacer, Metal.....	1
31	9545-010-001	Screw, Cross Recessed.....	1
31	8640-412-005	Nut, Keps #8.....	1
32	8640-411-003	Nut, Keps #6.....	1
*	8640-412-005	Nut, Sol. Brkt. to Control Panel.....	3
*	9497-225-006	Rod, Pull.....	1

* Not Illustrated

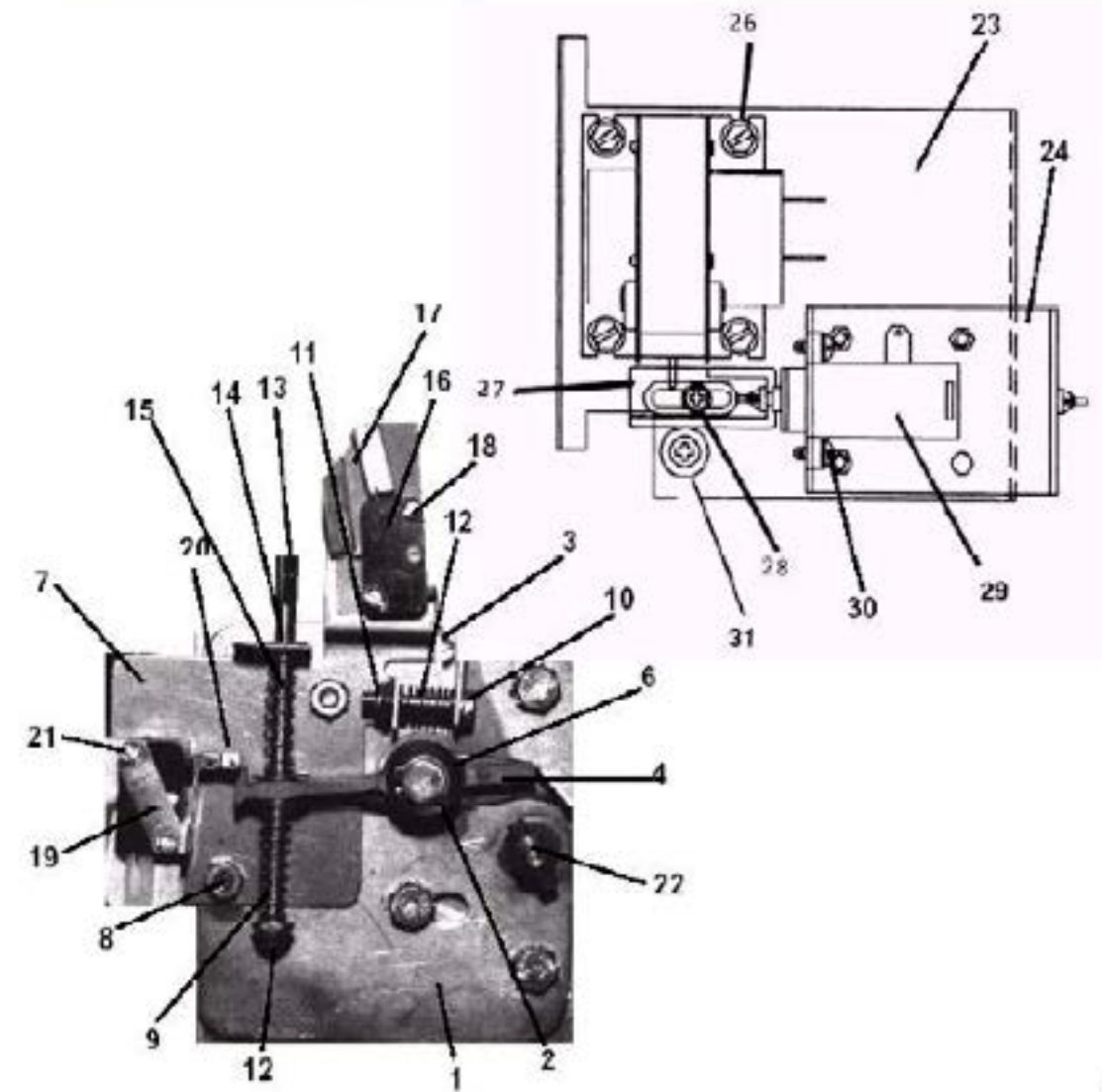
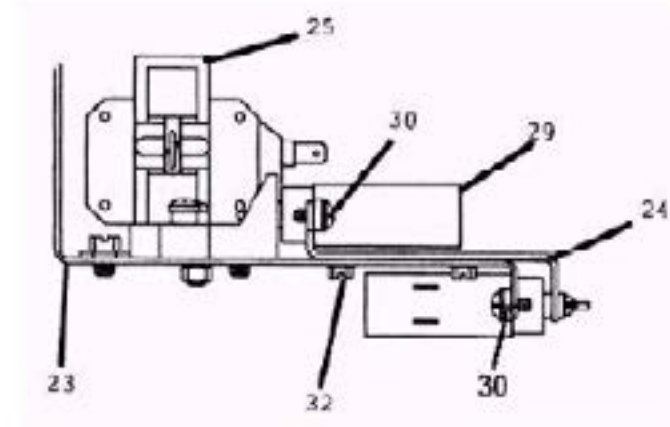

7

Loading Door Group by Part # WCVD-18

Key	Part Number	Description.....	Qty
*	9960-273-001	Loading Door, Complete (includes 1 thru 10).....	1
1	9487-264-001	Loading Door, Ring.....	1
2	9206-411-002	Gasket, Loading Door.....	1
3	9635-018-001	Window, Loading Door.....	1
*	9913-134-003	Shaft Assy, Locking (includes 4 thru 7).....	1
4	9537-195-002	Shaft, Door Locking.....	1
5	9095-040-001	Cam, Locking.....	1
6	9451-181-005	Pin, Groove (1 1/4).....	1
7	9451-181-004	Pin, Groove (3/4).....	1
8	9534-360-002	Spring, Lock Cam.....	1
9	9244-080-003	Handle, Door.....	1
*	9451-181-006	Pin, Door Handle (groove).....	1
10	9955-029-002	Loading Door Hinge Assy (mounts to Tub Front).....	1
*	9545-014-009	Screw, Hinge Mtg 5/16" x 3/4".....	3
*	8641-582-009	Lockwasher 5/16" Ext tooth.....	3
*	9552-036-001	Shim, Loading Door Hinge, Thin.....	AR
*	9552-036-002	Shim, Loading Door Hinge, Thick.....	AR
11	9451-184-004	Door Hinge Pin (mounts inside Loading Door Hinge Assy).....	1
*	8649-031-000	Ring, Retaining (snap ring ext).....	1
12	9079-122-002	Loading Door Hinge Clamp (mounts to door ring).....	1
13	9545-056-001	Screw, Loading Door Mtg (5/16" Theard Forming).....	3
14	9950-059-001	Ring, Masking.....	1
*	9059-063-002	Band, Edge (mounts to Front Panel).....	1
*	8640-413-002	Nut, Keps.....	4
15	9539-461-007	Switch, Safety.....	1
16	9550-159-001	Shield, Safety Switch.....	1
17	8220-062-027	Wires-Red.....	1
18	8220-062-028	Wires-Black.....	1
19	9801-089-001	Switch Assembly Complete Door Closure (includes 20-26).....	1
D1	9041-087-001	Switch Box.....	1
21	9053-067-003	Bushing Insulating.....	1
D3	9539-461-007	Switch, Micro.....	1
D2	9550-159-001	Switch, Shield.....	1
D4	8640-401-001	Nut Special Twin #4-40.....	1
D8	9545-020-001	Screw 4-40x5/8.....	2
D7	9008-004-001	Door Switch Actuator.....	1

* Not Illustrated

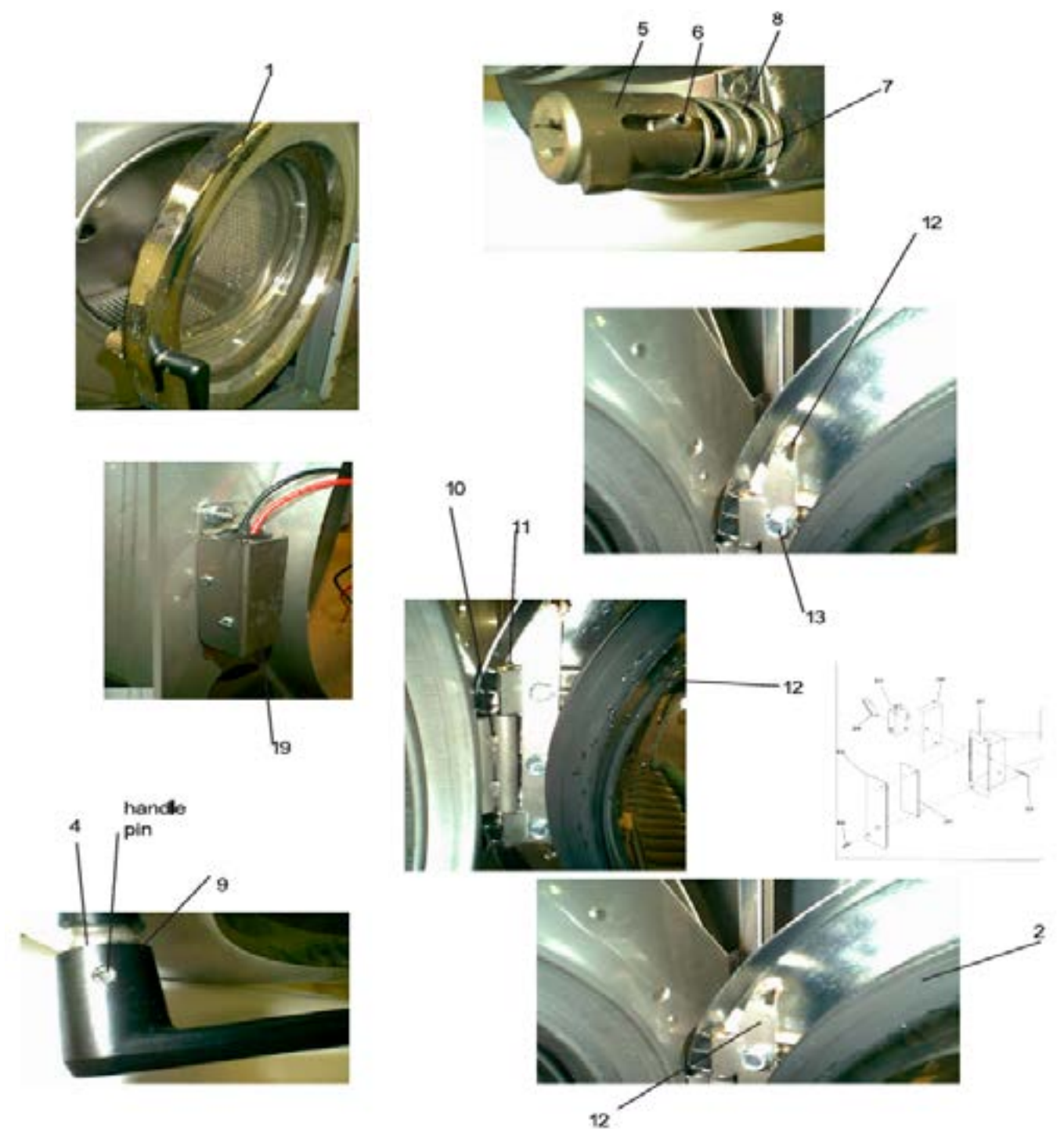

Loading Door Group by Part # WCVD-25, WCVD-40, WCVD-55

Key	Part Number	Description.....	Qty
*	9960-274-002	Loading Door, Complete (includes 1 thru 10).....	1
1	9487-265-001	Loading Door, Ring.....	1
2	9206-419-001	Gasket, Loading Door.....	1
3	9635-016-001	Window, Loading Door.....	1
*	9913-134-003	Shaft Assy, Locking (includes 4 thru 7).....	1
4	9537-195-002	Shaft, Door Locking.....	1
5	9095-040-001	Cam, Locking.....	1
6	9451-181-005	Pin, Groove (1 1/4).....	1
7	9451-181-004	Pin, Groove (3/4).....	1
8	9534-360-002	Spring, Lock Cam.....	1
9	9244-080-003	Handle, Door.....	1
*	9451-181-006	Pin, Door Handle (groove).....	1
10	9955-029-002	Loading Door Hinge Assy (mounts to Tub Front).....	1
*	9545-014-009	Screw, Hinge Mtg 5/16" x 3/4".....	3
*	8641-582-009	Lockwasher 5/16" Ext tooth.....	3
*	9552-036-001	Shim, Loading Door Hinge, Thin.....	AR
*	9552-036-002	Shim, Loading Door Hinge, Thick.....	AR
11	9451-184-004	Door Hinge Pin(mounts inside Loading Door Hinge Assy).....	1
*	8649-031-000	Ring, Retaining (snap ring ext).....	1
12	9079-122-002	Loading Door Hinge Clamp (mounts to door ring).....	1
13	9545-056-001	Screw, Loading Door Mtg 5/16" Theard Forming).....	3
14	9950-060-001	Ring, Masking.....	1
*	9059-063-002	Band, Edge (mounts to Front Panel).....	1
*	8640-413-002	Nut, Kepsfor mounting masking ring.....	4
*	9627-791-003	Wiring Harness doorlock safety switch.....	1
*	9801-089-001	Switch assembly Door Closure includes all **.....	1
D1	9041-087-001	Switch Box.....	1
**	9053-067-003	Bushing Insulating.....	1
D3	9539-461-007	Switch, Micro.....	1
D2	9550-159-001	Switch, Shield.....	1
D4	8640-401-001	Nut Special Twin #4-40.....	1
D8	9545-020-001	Screw 4-40x5/8.....	2
D7	9008-004-001	Door Switch Actuator.....	1

* Not Illustrated

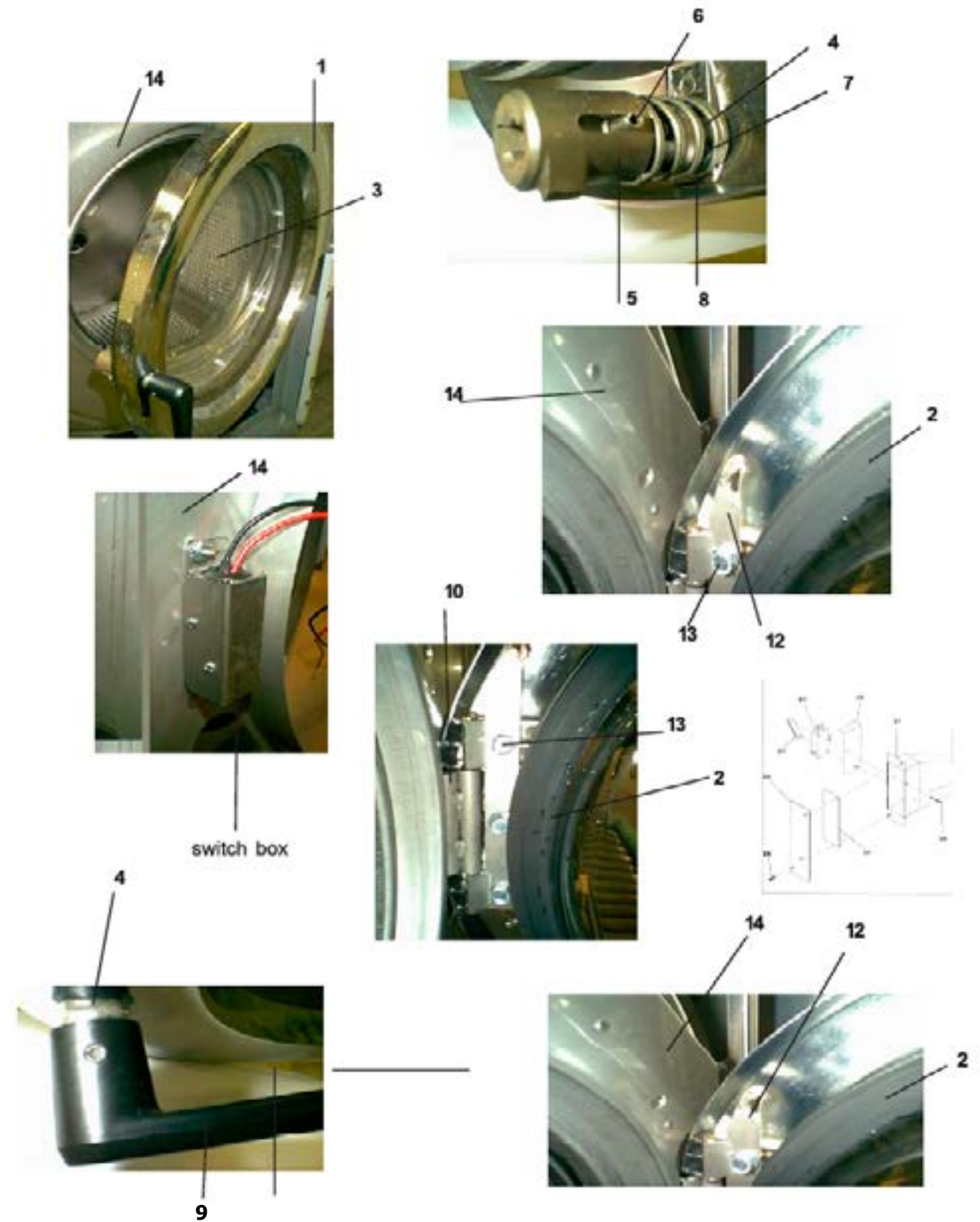

Loading Door Group by Part # WCVD-75 (180 Door)

Key	Part Number	Description.....	Qty
*	9960-274-004	Loading Door, Complete (includes #1thru #10)	1
1	9487-265-002	Loading Door Ring 180 degree.....	1
2	9206-419-001	Gasket, Loading Door.....	1
3	9635-016-001	Window, Loading Door.....	1
4	9913-134-003	Shaft Assy. Locking (includes #5 thru #8).....	1
5	9537-195-002	Shaft, Door Locking.....	1
6	9095-040-001	Cam, Locking.....	1
7	9451-181-005	Pin, Groove (1 1/4).....	1
8	9451-181-005	Pin, Groove (3/4).....	1
9	9534-360-002	Spring, Lock Cam.....	1
10	9244-080-003	Handle, Door.....	1
17	9451-181-006	Roll Pin, Door Handle (groove).....	1
11	9955-030-001	Hinge Assy, Loading Door (mounts to tub front).....	1
*	9545-014-009	Screw, Hinge Mtg.....	3
*	8641-582-009	Lockwasher.....	3
*	9552-036-001	Shim, Loading Door Hinge, Thin.....	AR
*	9552-036-002	Shim, Loading Door Hinge, Thick.....	AR
12	9845-005-003	Top, Loading Door Leaf Hinge.with pin.....	1
13	9845-005-002	Bottom, Loading Door Leaf Hinge.....	1
16	9545-056-002	Screw, Loading Door Hinge Mtg.....	3
15	9950-060-002	Ring, Masking w door switch hole.....	1
*	8640-413-002	Nut.....	4
*	9059-063-002	Band Edge Protector.....	1
*	9801-089-001	Door Closure Switch Assembly.....	1
D1	9041-087-001	Switch Box.....	1
*	9053-067-003	Bushing Insulating.....	1
D3	9539-461-007	Switch, Micro.....	1
D2	9550-159-001	Switch, Shield.....	1
D4	8640-401-001	Nut Special Twin #4-40.....	1
D8	9545-020-001	Screw 4-40x5/8.....	2
D7	9008-004-001	Door Switch Actuator.....	1

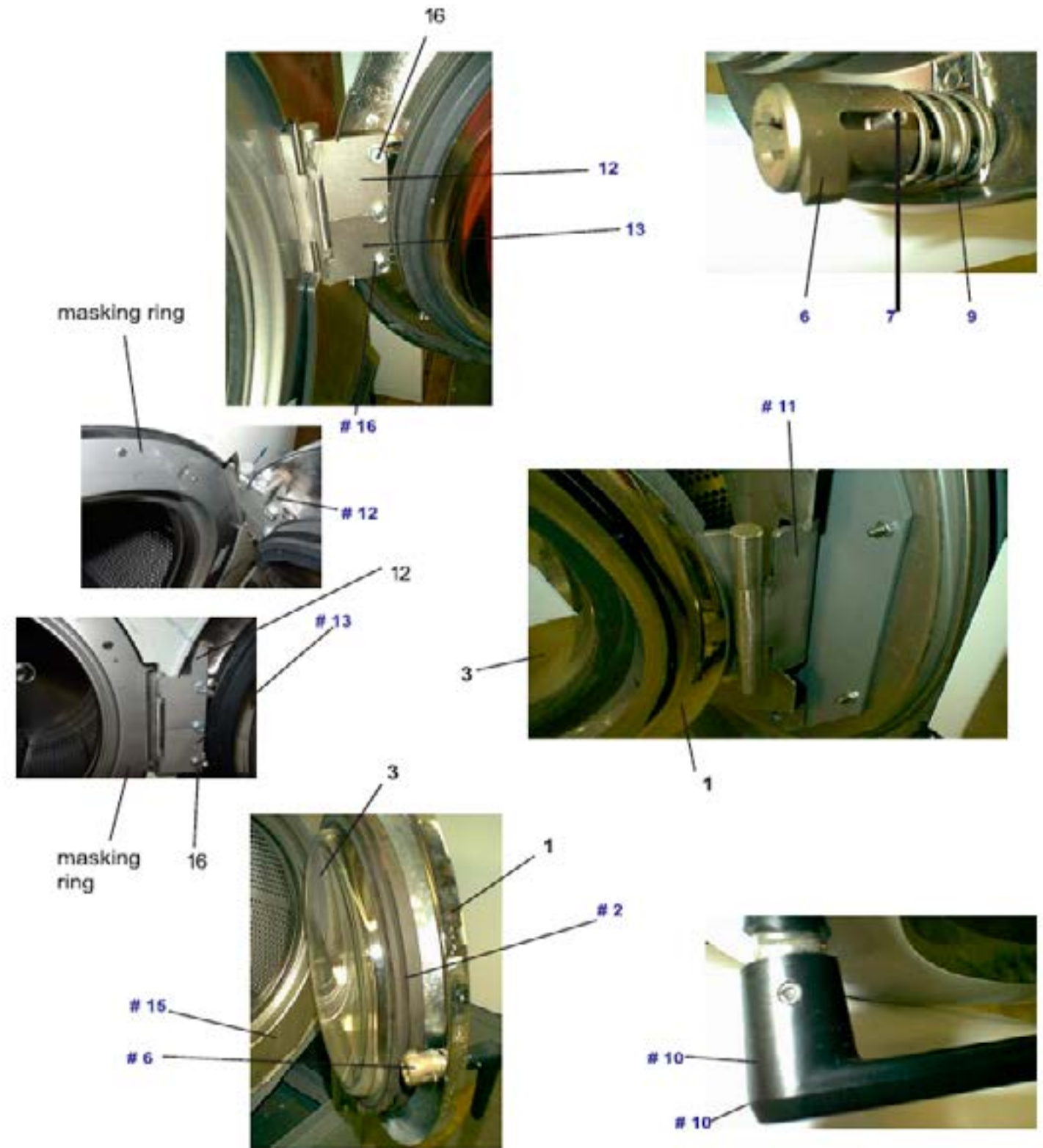
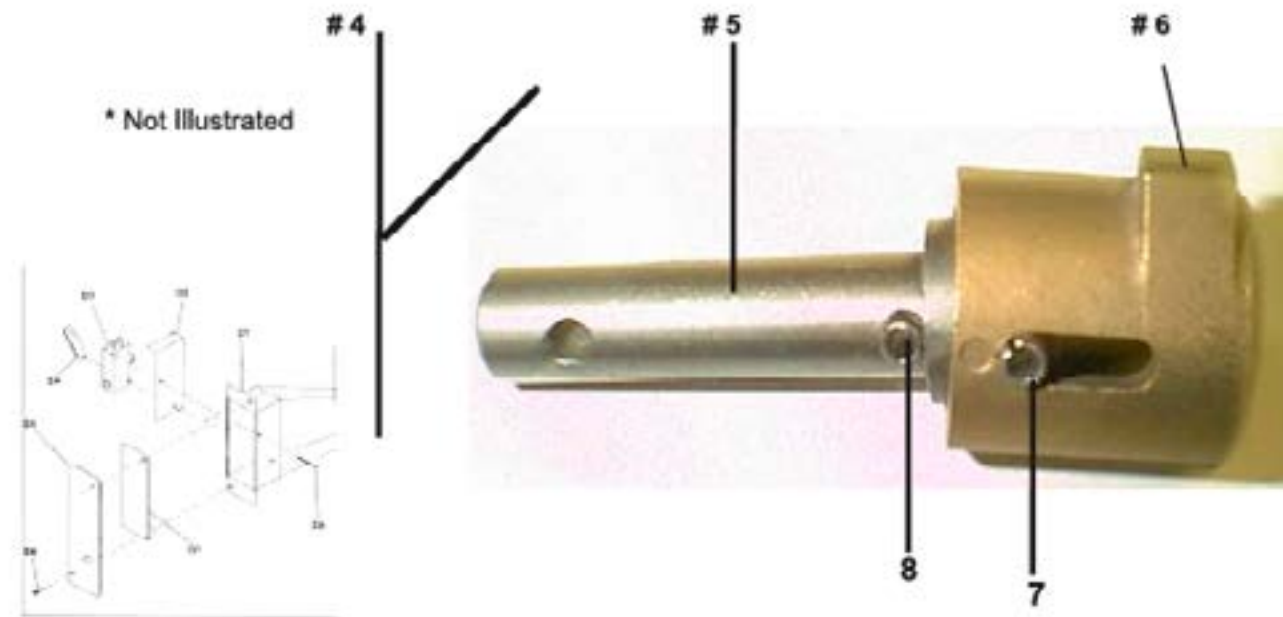

Drain Valve Group by Part

Key	Part Number	Description.....	Qty
*	9379-187-001	Valve, Drain (includes 2-11) (3") WCVD-25, WCVD-40, WCVD-55, WCVD-75.....	1
2	9064-070-001	Body, Valve (w/ball) WCVD-25, WCVD-40, WCVD-55, WCVD-75.....	1
3	9914-137-001	Motor & Gear Train.....	1
4	9452-538-001	Plate, Motor Mtg.....	1
5	8639-994-001	Screw.....	3
6	9534-339-001	Spring, Drive WCVD-25, WCVD-40, WCVD-55, WCVD-75.....	1
7	9545-054-001	Screw.....	2
8	9545-054-002	Screw.....	1
9	9532-134-001	Seal, V Packer.....	2
10	8641-584-001	Washer.....	1
11	9451-196-001	Pin, Main Drive.....	1
12	9538-149-001	Plate (spacers needed for replacement motor mtg. plate).....	4
*	9379-177-006	Valve, Drain (includes #2 thru #11) WCVD-18.....	1
2	9064-068-001	Body, Valve (w/ball) WCVD-18.....	1
3	9914-137-001	Motor & Gear Train.....	1
4	9452-538-001	Plate, Motor Mtg.....	1
5	8639-994-001	Screw.....	3
6	9534-340-001	Spring, Drive WCVD-18.....	1
7	9545-054-001	Screw.....	2
8	9545-054-002	Screw.....	1
9	9532-134-001	Seal, V Packer.....	2
10	8641-584-001	Washer.....	1
11	9451-196-001	Pin, Main Drive.....	1
12	9538-149-001	Plate (spacers needed for replacement motor mtg. plate).....	4

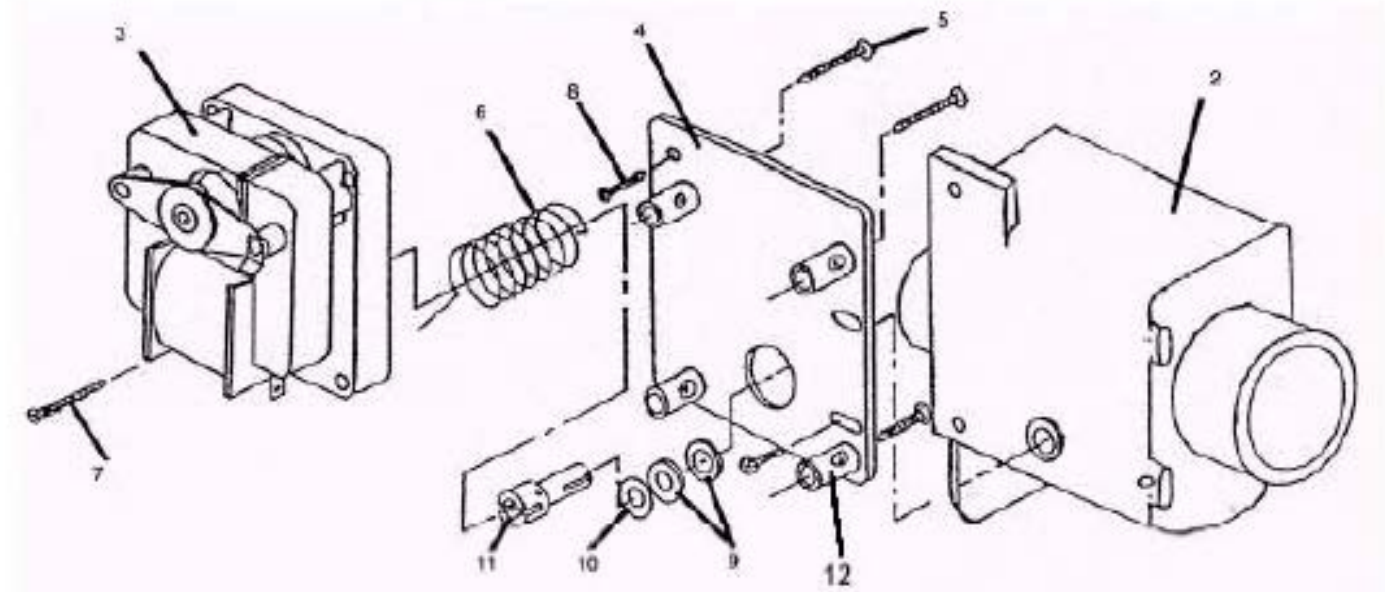

Chassis and Drain Group by Part # WCVD-55, WCVD-75

Key	Part Number	Description	
1	9945-105-002	Base Assy, Frame WCVD-55.....	1
1	9945-125-002	Base Assy, Frame WCVD-75.....	1
2	9930-138-001	Outer Tub Assy WCVD-55.....	1
2	9930-144-001	Outer Tub Assy WCVD-75.....	1
3	9950-053-002	Ring Assy, Tub Mtg-Front WCVD-55, WCVD-75.....	1
4	9545-017-013	Screw Hexhead 1/2 x 2 WCVD-75,WCVD-55.....	1
4	8640-417-005	Nut Whizlok WCVD-75.....	1
4	8640-417-002	Nut Hex, 1/2 -13 WCVD-55.....	3
4	8641-582-016	Lockwasher Exttooth 1/2" WCVD-55.....	3
5	9545-017-013	Bolt, 1/2-13x2, Grd 5 Tub to Base WCVD-75, WCVD-55.....	2
5	8641-581-026	Washer, Flat WCVD-55.....	2
5	8641-581-026	Washer, Flat WCVD-75.....	4
5	9552-013-001	Shim, Thin.....	4
5	9552-013-002	Shim, Thick.....	4
6	9379-187-001	Valve, Drain 3" OD WCVD-55,WCVD-75.....	1
9	9915-126-002	Tube Assy, Drain WCVD-75.....	1
9	9915-120-002	Tube Assy, Drain WCVD-55.....	1
10	9545-030-002	Screw, Tube Mtg.....	2
11	9242-459-001	Hose, Tub to Drain Valve.....	1
12	9242-457-001	Hose, Drain Valve to Tube WCVD-55,WCVD-75.....	1
13	8654-117-014	Clamp, Hose.....	5
*	9610-001-001	Vacuum Breaker WCVD-55, WCVD-75.....	1
*	9029-069-001	Bracket, Vacuum Breaker WCBVD-55, WCVD-75.....	1
*	9545-008-026	Screw #10Bx 1/2.....	4
*	8654-117-001	Clamp.....	4
16	9732-108-002	DispenserWCVD-55.....	1
16	9475-002-002	Flow restrictor (All except 75).....	2
17	9475-002-003	Flow restrictor WCVD-75.....	3
17	9206-416-001	Gasket, Dispenser WCVD-55.....	1
18	9242-450-001	Hose, Dispenser to Tub WCVD-55.....	1
19	8654-117-008	Clamp, Dispenser Hose WCVD-55.....	2
20	9807-091-001	Soap Box Assembly Complete SS WCVD-75.....	1
21	9206-425-001	Soap Box mounting Gasket WCVBD-75.....	1
22	9987-104-001	Lid Assembly soap box WCVD-75.....	1
23	9545-012-017	Lid screws #10-32x1/2 SS WCVD-75.....	1
24	8640-413-006	Nut Hex Elasticstop #10-32 SS WDCV-75.....	4
25	9538-157-019	Spacer Plastic #10x1/2 WCVD-75.....	4
26	9029-148-001	Bracket Soap box mounting WCVD-75.....	1
27	9574-252-002	Softner siphon tube WCVD-75.....	1
28	9475-002-003	Flow restrictors WCVD-75.....	3
29	9974-007-002	FrontAss'y, Tub WCVD-55, WCVD-75.....	1
30	9950-055-001	RingAss'y, Clamp (tub front to outer tub) WCVD-55,WCVD-75.....	1
31	9545-029-009	Screw, 3/8-16x3 WCVD-55, WCVD-75.....	1
32	8640-415-001	Nut, Hex 3/8-16 WCVD-55, WCVD-75.....	1
33	9206-421-002	Gasket, Tub Front WCVD-55, WCVD-75.....	1
34	8615-104-039	Pipe Plug WCVD-55, WCVD-75.....	2
35	9242-449-003	Hose, OverflowWCVD-55, WCVD-75.....	1
36	8654-029-000	Clamp, Hose WCVD-55, WCVD-75.....	2

* Not Illustrated

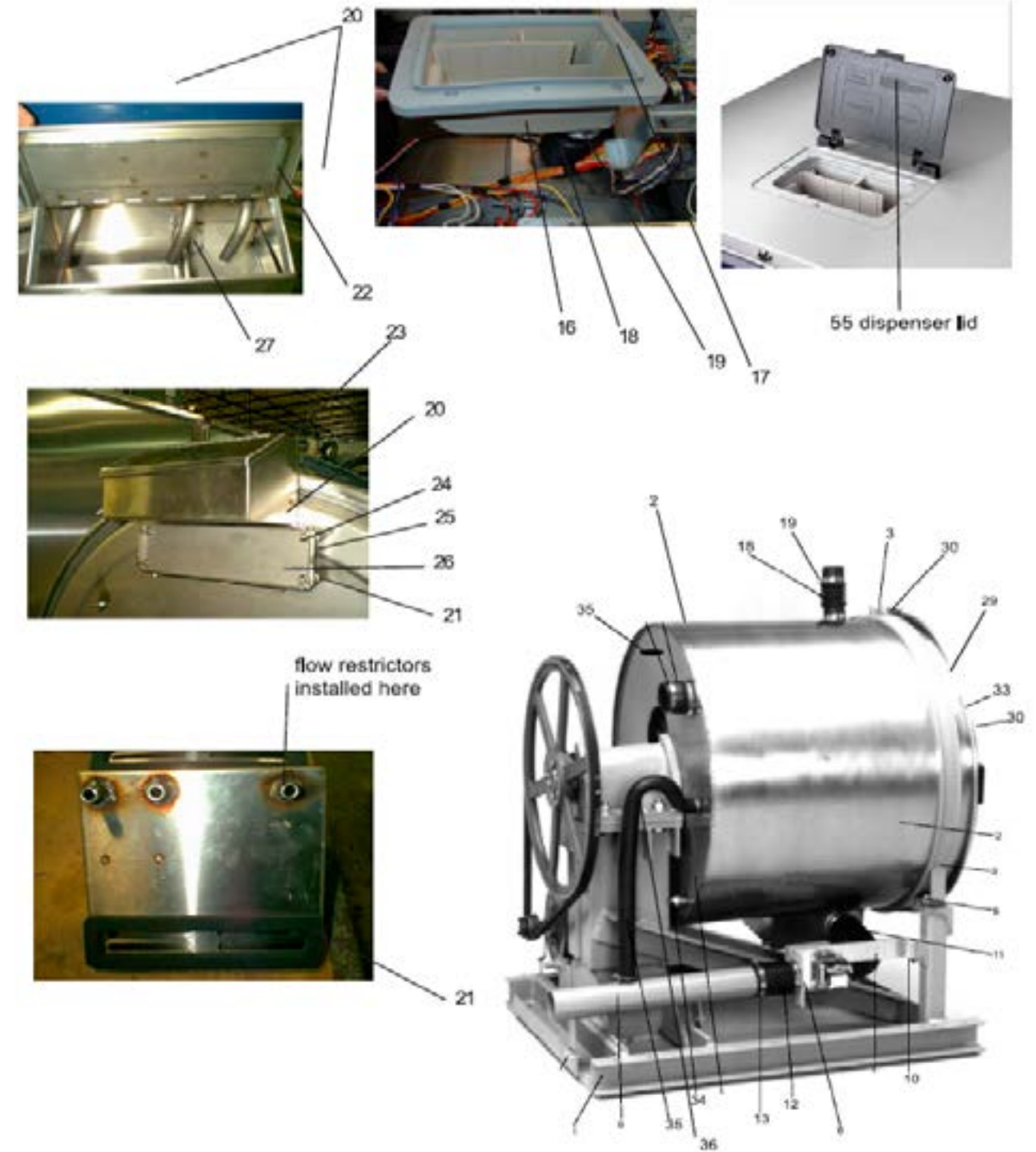

Chassis and Drain Group by Part # WCVD-18, WCVD-25, WCVD-40

Key	Part Number	Description	
1	9945-097-002	Base Assy, Frame WCVD-40.....	1
1	9945-093-002	Base Assy,Frame WCVD-18.....	1
1	9945-105-002	Base Assy, Frame WCVD-55.....	1
1	9945-087-002	Base Assy,Frame WCVD-25.....	1
2	9930-136-001	Tub Assy WCVD-40,.....	1
2	9930-135-001	Tub Assy WCVD-18.....	1
2	9930-137-001	Tub Assy WCVD-25.....	1
2	9930-138-001	Tub Assy WCVD-55.....	1
*	9869-006-001	Tub & Cylinder Assy WCVD-18.....	1
*	9869-008-001	Tub & Cylinder Assy WCVD-25.....	1
*	9869-007-001	Tub & Cylinder Assy WCVD-40.....	1
*	9869-009-001	Tub & Cylinder Assy WCVD-55.....	1
3	9967-009-002	Cradle Assy, Tub WCVD-40.....	1
4	9950-050-002	Ring Assy, Tub Mtg-Front WCVD-40.....	2
5	9545-060-003	Bolt, Top Front Ring 5/8" x 3" WCVD-40.....	1
5	8640-425-001	Nut WCVD-40.....	1
5	8641-582-018	Lockwasher WCVD-40.....	1
6	9545-060-002	Bolt,5/8 x 2 1/2 Frnt Rng to Crdl (double nuts used) WCVD-40.....	2
6	8640-425-001	Nut, Hex WCVD-40.....	4
7	9950-041-004	Ring Assy.Clamp Tub Mtg.- Rear.....	2
8	9545-060-001	Bolt, 5/8 x 1 1/2 Rings to Base (front and rear).....	4
8	8641-582-018	Lockwasher.....	4
8	8640-425-001	Nut, Hex 5/8-11.....	4
9	9379-187-001	Valve, Drain.....	1
10	9029-052-001	Bracket, Drain Valve.....	1
*	9545-048-001	Screw, Valve to Bracket 12ABx1/2.....	1
*	8641-581-018	Washer.....	1
11	9545-030-002	Screw, Bracket to Base 1/4Bx3/4.....	2
12	9915-118-002	Tube Assy, Drain.....	1
13	9545-030-002	Screw, Tube Mtg.....	2
14	9242-456-001	Hose, Tub to Drain Valve.....	1
15	9242-457-001	Hose, Drain Valve to Tube.....	1
16	8654-117-014	Clamp, Hose.....	4
17	9552-038-001	Shim, Support Assembly (thin).....	AR
18	9242-458-002	Hose, Vacuum Brkr. to Tub.....	1
19	9610-001-001	Vacuum Breaker.....	1
20	9029-077-001	Bracket, Vacuum Breaker.....	1
21	9545-008-026	Screw #10Bx 1/2.....	4
*	9732-108-002	Dispenser.....	1
*	9206-416-001	Gasket, Dispenser.....	1
*	8640-399-007	Nut Spring.....	4
*	9242-450-001	Hose, Dispenser to Tub.....	1
*	8654-117-008	Clamp, Dispenser Hose.....	2
27	9732-137-003	Back Ass'y, Tub.....	1
28	9991-056-002	SupportArmAss'y, Bearing Housing.....	6
29	9545-059-002	Bolt, 7/16" x 2" Tub Back to Tub.....	12
29	8640-416-005	Nut, Flange Lock.....	12
*	9552-038-003	Shim (thick).....	AR

* Not Illustrated

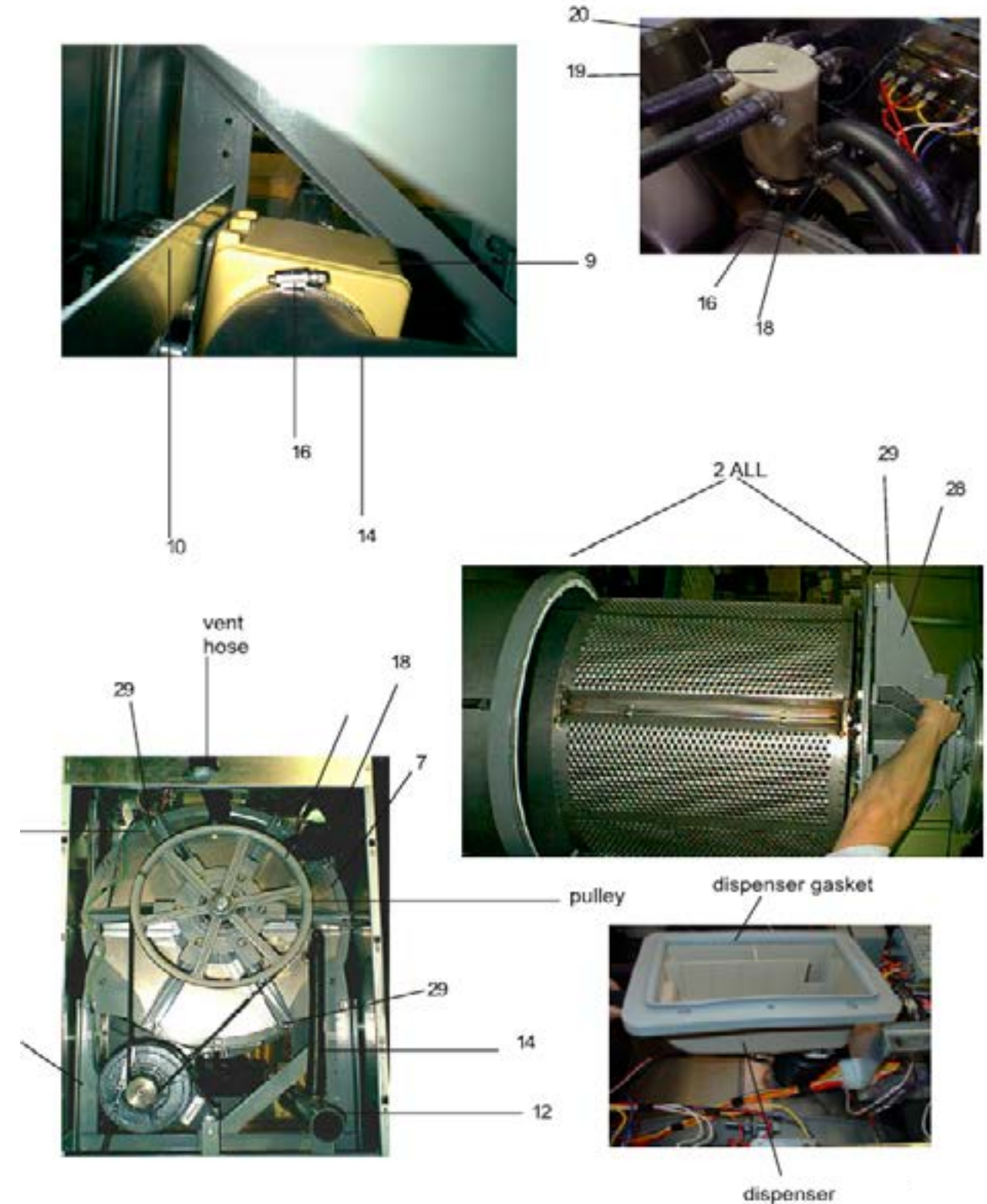

Water Inlet & Rear Channel Group by Part

Water Inlet Breakdown

Key	Part Number	Description.....Qty
*	9379-183-003	Valve, Water Inlet (includes 1 thru 6).....2
1	9555-056-001	Screen, Inlet end of valve.....2
2	9089-017-001	Coil Assy., 120 V.....2
3	9118-049-001	Diaphragm.....2
4	9211-021-002	Guide, Solenoid.....2
5	9015-008-001	Armature.....2
6	9534-298-001	Spring, Armature.....2

Water Inlet & Rear Channel

*	9379-192-001	Valve, Water Inlet (dual outlet) WCVD-75.....2
*	9379-194-001	Valve, Water Inlet (single outlet) WCVD-75.....2
*	9545-008-026	Screw, Valve Mtg WCVD-18, WCVD-25, WCVD-40, WCVD-55.....2
3	8640-399-009	Nut, Spring WCVD-18, WCVD-25, WCVD-40, WCVD-55.....4
*	9545-064-001	Screw, Valve M4x0.7x8mm WCVD-75.....8
4	9208-049-001	Guard, Water valve Terminal.....1
5	9610-001-001	Vacuum Breaker.....1
6	9029-069-001	Bracket, Vacuum Breaker.....1
7	9545-008-026	Screw.....4
*	9550-186-001	Shield over Water Valves Plastic WCVD-18, WCVD-25, WCVD-40, WCVD-55.....1
9	9242-458-003	Hose, Vacuum Breaker to Tub.....1
10	8654-117-014	Clamp, Vacuum Breaker End1
11	8654-117-009	Clamp, Tub End.....1
12	9242-453-018	Hose, Vac. Brkr. to Disp.29" WCVD-55.....1
12	9242-453-019	Hose, Vac. Brkr. to Disp.26" WCVD-55.....1
13	9242-453-020	Hose, Hot Valve to Vac. Brkr 18"1
13	9242-453-020	Hose, Hot Valve to Tub 18"1
14	9242-453-020	Hose, Cold Valve to Vac. Brkr 18".....1
14	9242-453-020	Hose, Cold Valve to Tub 18"1
12	9242-453-022	Hose, Vac. Brkr. dispenser 43" WCVD-75.....3
13	9242-453-009	Hose, (valve to vac. Brkr) 23" WCVD-75.....4
*	8654-029-000	Clamp, Hose-Spring (overflow from drain to tub back).....2
15	8654-117-015	Clamp, Hose-Worm.....10
18	5198-211-004	Circuit Breaker (optional).....1
18	9200-001-002	Fuseholder.....1
18	8636-018-001	Fuse 1.5 amp WCVD-18, WCVD-25, WCVD-40, WCVD-55.....1
18	8636-018-004	Fuse 2.5 amp WCVD-75.....1
19	8502-716-001	Label Fuse 1.5 amp WCVD-18, WCVD-25, WCVD-40, WCVD-55.....1
*	8502-716-002	Label Fuse 2.5 amp WCVD-75.....1

* Not Illustrated

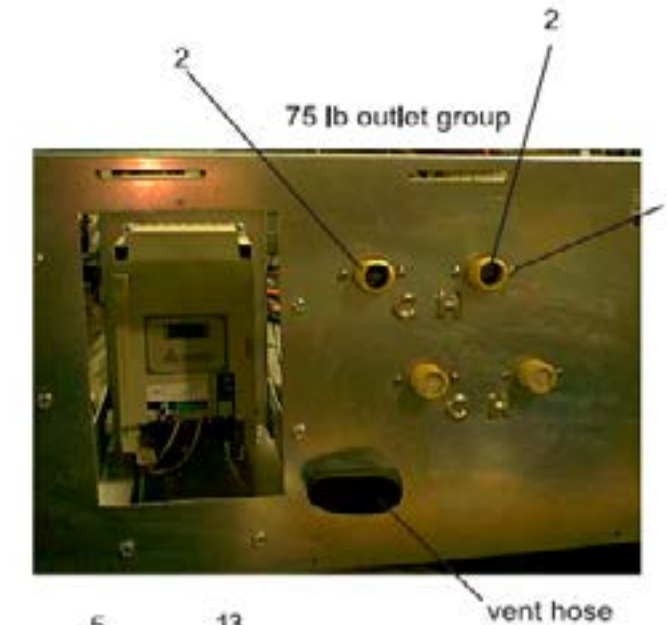
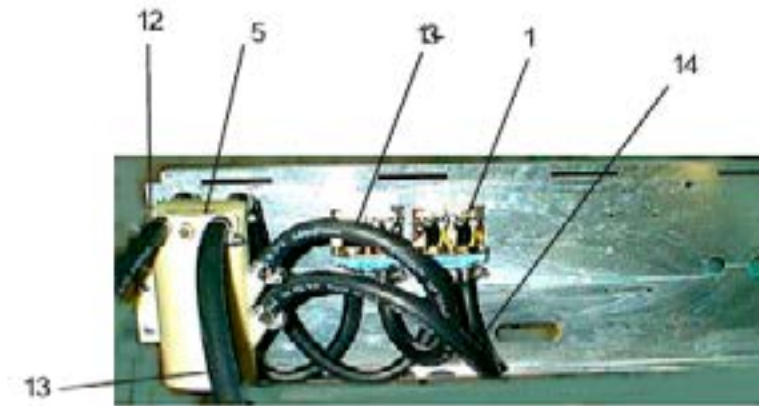

high voltage label

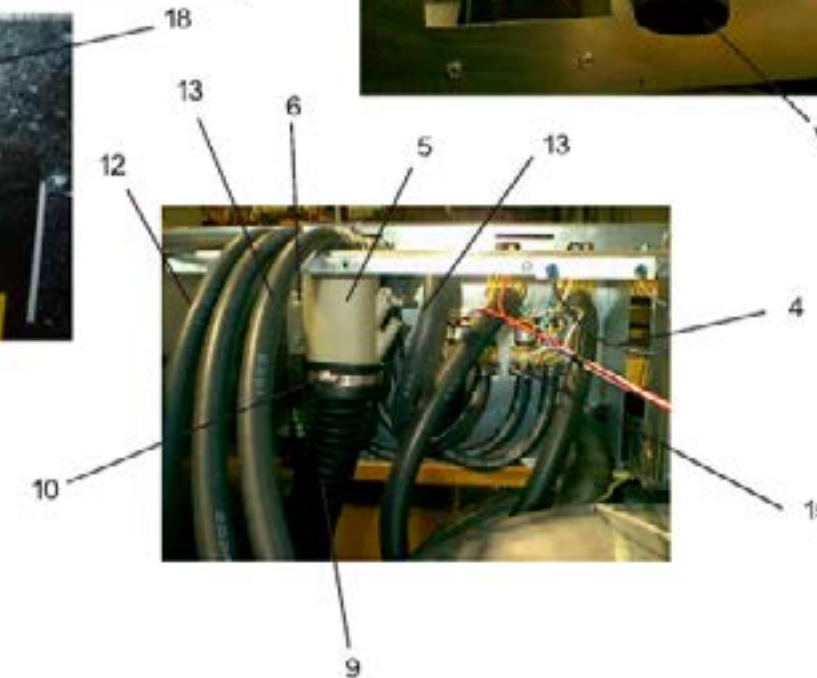

Electrical Components - Top Compartment

Key	Part Number	Description	
1	9857-154-001	Trough Assy, Controls (all parts below #2 - #43 & trough).....	WCVD-55
1	9857-151-001	Trough Assy,Controls(all parts below #2-#43 & trough)	WCVD-25
1	9857-150-001	Trough Assy,Controls(all parts below #2-#43 & trough)	WCVD-18-12
1	9857-149-001	Trough Assy,Controls(all parts below #2-#43 & trough)	WCVD-18-10
1	9857-152-001	Trough Assy, Controls (all parts below #2 - #43 & trough)	WCVD-40
1	9857-160-001	Trough Assy, Controls (all parts below #2 - #43 & trough)	WCVD-75
2	9839-015-001	Trough only ALL.....	1
3	9545-008-026	Screw, Trough Sides ALL.....	4
4	8641-582-006	Lockwasher Exttooth #10 ALL.....	4
5	9003-270-001	Angle Support Trough WCVD-18,WCVD-25.....	1
5	9003-271-001	Angle Support Trough WCVD-40,WCVD-55.....	1
6	9545-008-026	Screw, Trough Bracket WCVD-18,WCVD-25,WCVD-40,WCVD-55.....	4
7	8711-004-001	Transformer, Control (Operating Voltage to 115 volts) ALL except WCVD18-10...	
9	9545-045-001	Screw, Mtg #8Bx1/4".....	2
10	8641-582-005	Lockwasher.....	2
11	8220-001-282	Wire Assembly Red 20" WCVD-18, WCVD-25.....	2
11	8220-062-025	Wire Assembly Red 28" WCVD-40, WCVD-55.....	2
11	8220-062-032	Wire Assembly Red 41" WCVD-75.....	2
12	8639-621-007	Screw GRN. #10-32x 1/2".....	1
13	8641-582-006	Lockwasher #10.....	1
14	8652-130-037	Lug, Grounding.....	1
15	9473-006-001	PCB assembly Relay Main	1
16	9538-157-011	Spacer Plastic #8x3/8".....	6
17	8640-411-003	Nuts Hexkeps #6-32.....	6
*	9627-796-001	Harness Drain/Therm/Sol WCVD-18,WCVD-25.....	1
*	9627-796-002	Harness Drain/Therm/Sol WCVD-40,WCVD-55,WCVD-75.....	1
19	9627-795-001	Harness P19/Water Valve WCVD-18,WCVD-25.....	1
19	9627-795-002	Harness P19/Water Valve WCVD-40,WCVD-55,WCVD-75.....	1
*	9627-794-001	Harness P8/P16 ALL.....	1
*	9627-793-001	Harness P20/P21 ALL.....	1
*	8220-064-023	Wire Assembly Yel 32" WCVD-18,WCVD-25,WCVD-40,WCVD-55.....	2
*	8220-064-040	Wire Assembly Yel 64" WCVD-75.....	2
23	9053-067-002	Bushing, Wire 7/8 ALL.....	2
*	9527-002-002	Standoff Twistlock ALL.....	3
*	9527-002-003	Standoff Twistlock ALL.....	2
26	9483-004-002	Dynamic Braking Resistor WCVD-18-10,WCVD-18-12.....	1
26	9483-004-002	Dynamic Braking Resistor WCVD-25,WCVD-40,.....	2
26	9483-004-003	Dynamic Braking Resistor WCVD-55, WCVD-75.....	2
27	9545-012-008	Screws #10-32x1/2" (pnhdcr).....	4
28	8640-413-002	Nuts, #10-32 UNF 2B.....	4
29	8220-117-001	Wire Assembly Jumper Blk. ALL except WCVD-18.....	2
29	8220-118-001	Wire Assembly Jumper BLK. WCVD-18.....	2
30	9545-044-006	Screw #6-32x5/16".....	4
31	8640-411-003	Nuts Hex #6-32.....	4
32	9897-034-001	Terminal Block Assy, POWER ALL.....	1
33	9545-045-007	Screw, Mtg 8Bx3/8".....	2
*	9558-027-001	Strip, Terminal Marker WCVD-18,WCVD-40,WCVD-55,WCVD-75.....	1
*	9558-027-002	Strip, Terminal Marker WCVD-25.....	1
35	9539-457-002	Switch, Pressure WCVD-18.....	1
35	9539-457-001	Switch, Pressure WCVD-40,WCVD-25,WCVD-55.....	1
35	9539-488-001	Switch, Pressure WCVD-75.....	1
36	9545-045-001	Screw, Mtg #8Bx1/4" WCVD-18,WCVD-25,WCVD-40.....	2
36	9545-008-026	Screw, Mtg. WCVD-55, WCVD-75.....	2

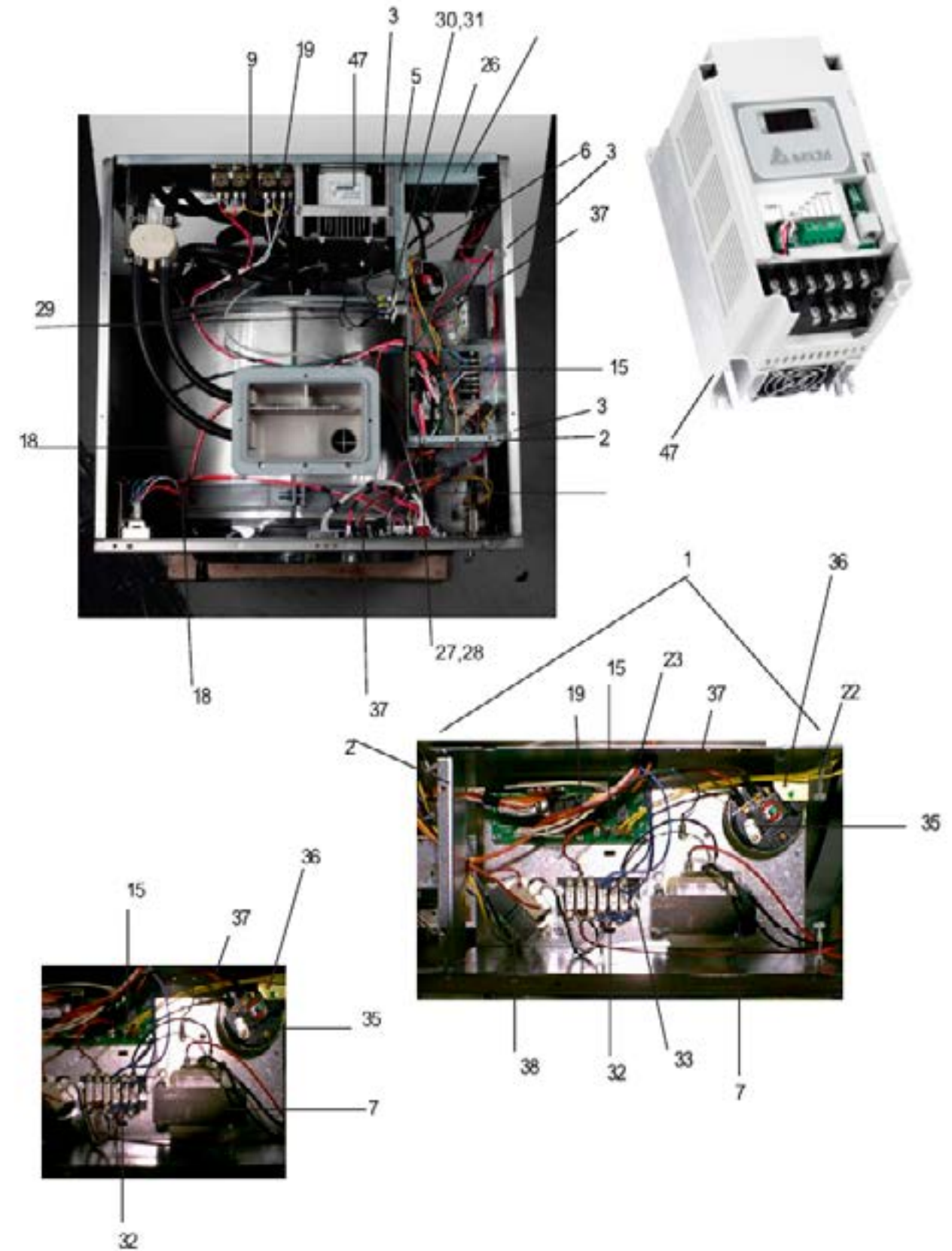

Control Panel Group by Part

Key	Part Number	Description
1	9989-473-001	Panel Control Assembly(panel only)WCVD-18-10,WCVD-18-12.....1
1	9989-474-001	Panel Control Assembly (panel only) WCVD-25.....1
1	9989-475-001	Panel Control Assembly (panel only) WCVD-40.....1
1	9989-476-001	Panel Control Assembly (panel only) WCVD-55,WCVD-75.....1
*	9545-008-026	Screw, Hxwshrdundct #10Bx 1/2".....4
*	9467-024-001	Post Locator Top of panel.....2
*	8640-411-003	Nut Hexkeys #6-32.....2
*	9355-001-001	Locator Panel.....2
*	9545-008-023	Screw FillHDCR 10Bx1/2".....2
7	9538-178-001	Spacer Pushbutton (Micro).....1
8	9486-150-001	Retainer Pushbutton (Micro).....1
9	8640-424-002	Nut Hexelasticstop #4-40.....2
10	9035-060-001	Pushbutton Control (coin).....1
2	9185-008-001	Filler Pushbutton Control.....4
11	9473-004-001	PCB assembly Control /Display.....1
12	9538-157-018	Spacer Plastic #6x9/16.....5
13	8640-411-003	Nut Elasticstop #6-32.....5
14	9627-797-001	Harness LED PCB.....1
15	9627-791-003	Harness Doorlock WCVD-18,WCVD-25.....1
15	9627-791-004	Harness Doorlock WCVD-40,WCVD-55,WCVD-75.....1
16	9473-005-001	PCB assembly Mode lights.....1
*	9635-022-001	Mode Lights Backing Window (Optional).....1
17	9538-157-018	Spacer Plastic #6x9/16.....2
18	8640-411-003	Nut Hexkeys #6-32.....2
19	9794-001-001	Light, LED.ADD BLEACH Assembly.....1
20	9538-157-018	Spacer Plastic #6x9/16.....2
21	8640-411-003	Nut Hexeps #6-32.....2
*	9732-122-001	Kit, Coin Box W/Hardware.....1
22	9412-114-001	Nameplate, Control Panel (one piece) WCVD-40.....1
22	9412-113-001	Nameplate.Control Panel (one piece) WCVD-25.....1
22	9412-112-001	Nameplate.Control Panel (one piece) WCVD-18.....1
22	9412-115-001	Nameplate.Control Panel (one piece) WCVD-55.....1
22	9412-130-001	Nameplate.Control Panel (one piece) WCVD-75.....1
*	9922-011-001	Solenoid Ass'y, Door Locking (see Door Lock Group for parts breakdown)..1
*	8640-412-005	Hex Nuts (mounting solenoid assy. to control panel).....4
23	8612-001-001	Battery.....1
24	9021-001-001	Coin Acceptor Single Complete w/Blocking1

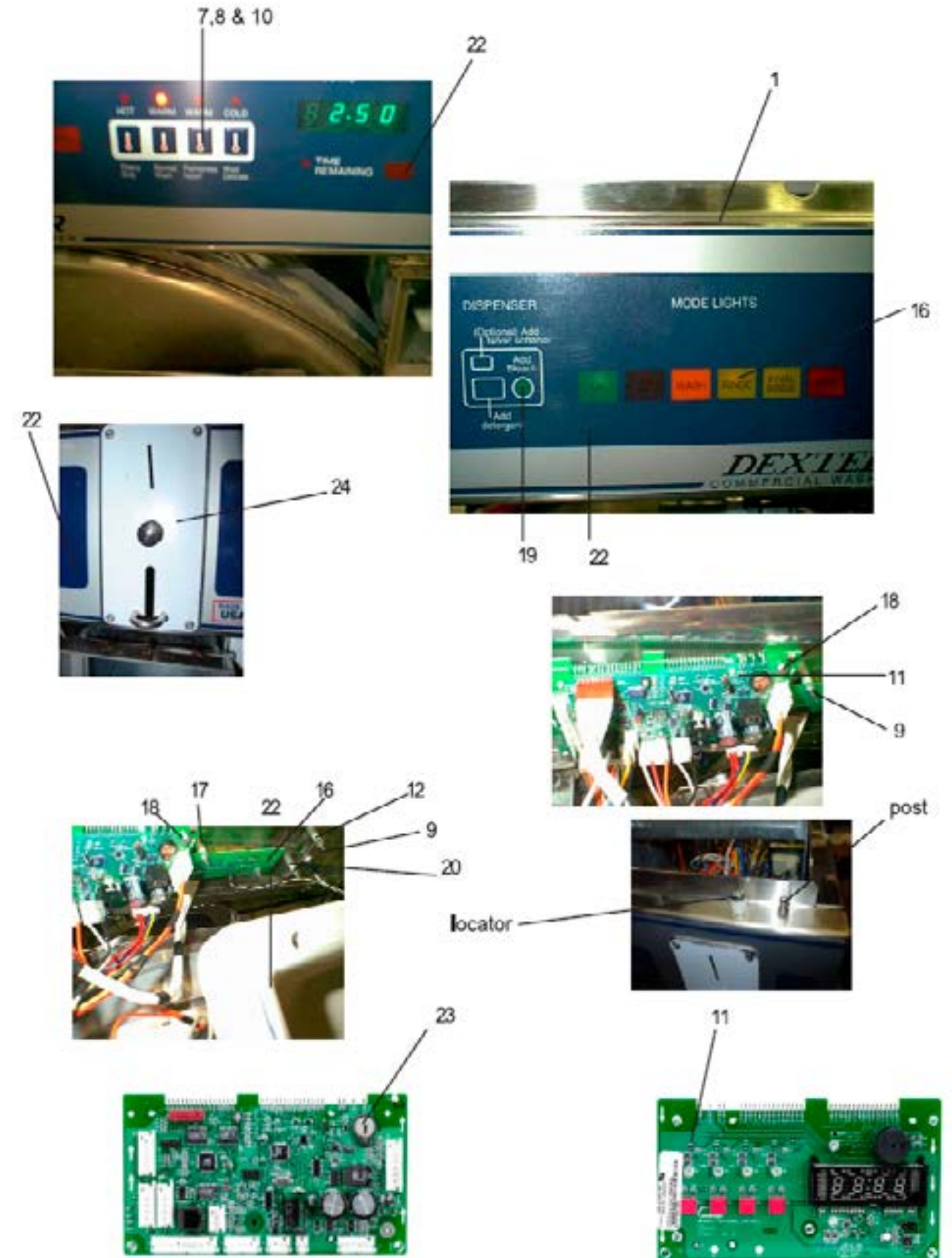

Labels and Diagrams

Part Number	Description
9506-001-001	Wiring Diagram, WCVD-18-10
9506-003-001	Wiring Diagram, WCVD-25
9506-037-001	Wiring Diagram,WCVD-75
9506-009-001	Wiring Diagram, WCVD-55
9506-005-001	Wiring Diagram, WCVD-40
9506-007-001	Wiring diagram, WCVD-18-12
8507-330-001	Transient Voltage Surge Suppressor Infomational
8507-275-001	Instructions Spin Direction WCVD-55,WCVD-75
8507-274-001	Instructions Spin Direction WCVD-25, WCVD-40
8507-273-001	Instructions Spin Direction WCVD-18
9506-002-001	Wiring Schematic WCVD-18-10
9506-004-001	Wiring Schematic WCVD-25
9506-038-001	Wiring Schematic WCVD-75
9506-010-001	Wiring Schematic WCVD-55
9506-006-001	Wiring Schematic WCVD-40
9506-008-001	Wiring Schematic WCVD-18-12
8502-614-004	Label High Voltage Warning
8502-619-003	Label Fusing & Installation
8502-624-002	Label Door Opening Warning
8511-001-002	Label Quality

Section 9:

Coin Handling

Parts:

Wiring Diagrams
& Schematics &
maintenance Procedures

Coin Handling Group by Part

Key	Part Number	Description	
1	9942-029-001	Vault, Assy WCVD-18.....	1
1	9942-030-001	Vault, Assy WCVD-25.....	1
1	9942-030-002	Vault, Assy WCVD-40.....	1
1	9942-030-003	Vault, Assy WCVD-55.....	1
1	9942-030-004	Vault, Assy WCVD-75.....	1
*	9545-008-026	Screw, 10Bx 1/2" Vault Mtg.....	2
*	9545-008-031	Screw, 10AB x 1/2" Vault Mtg.....	2
2	9732-122-001	Kit, Coin Box W/Hardware (includes 3 thru 6).....	1
3	9349-033-001	Latch, Coin Box.....	1
4	8641-569-002	Washer, Wave.....	1
5	8641-583-001	Washer, Keeper.....	1
6	8641-581-008	Washer, Spacer- Thick.....	2
6	8641-581-010	Washer, Spacer- Thin.....	4
7	8650-012-003	Lock, Coin Box (w/key not included with 9732-122-001).....	1
*	9545-008-001	Screw, Chute Mtg.....	1
11	9119-025-002	Coin Acceptor chute without penny rejector (standard).....	1
*	8640-424-002	Nut.....	4
10	9732-126-001	Switch, Coin (fits single coin drop).....	1
12	9119-025-001	Coin Acceptor chute with penny rejector (optional).....	1
13	9486-133-001	Button Coin Return Retainer.....	1
*	9922-008-001	Coin Blocking Solenoid assy (** included).....	1
**	9536-079-001	Solenoid coin blocking.....	1
**	9534-362-001	Spring coin blocking.....	1
**	9545-039-001	Screw.Blocking assy mtg.....	2
**	8641-579-001	Lockwashers.....	2
8	9119-028-001	Chute Assy.WCVD-75.....	1
8	9119-029-001	Chute Assy.WCVD-18,WCVD-25,WCVD-40,WCVD-55.....	1
9	9021-001-001	Coin Acceptor Complete w/coin blocking solenoid.....	1
	9732-001-001	Electronic Acceptor Kit for U.S.A. models w/coin blocking.....	1
14	9545-020-004	Screws - Coin Acceptor Mounting Torx Head.....	4
15	8640-424-002	Nuts - Coin Acceptor Mounting Nuts.....	4

* Not Illustrated

NOTE: COIN BOX AND HARDWARE KIT AND COIN BOX LOCK NOT INCLUDED WITH MACHINE.

For other countries coinage call Dexter P&S or contact your local distributor.

