

REVISION HISTORY		
REV	DESCRIPTION	APP
PR	RELEASE FOR PRODUCTION - 001	S
ECN 00541	11/10/22	

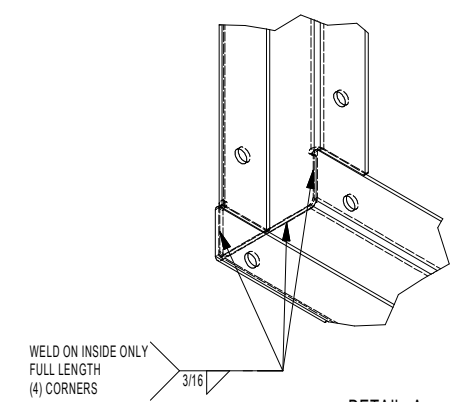
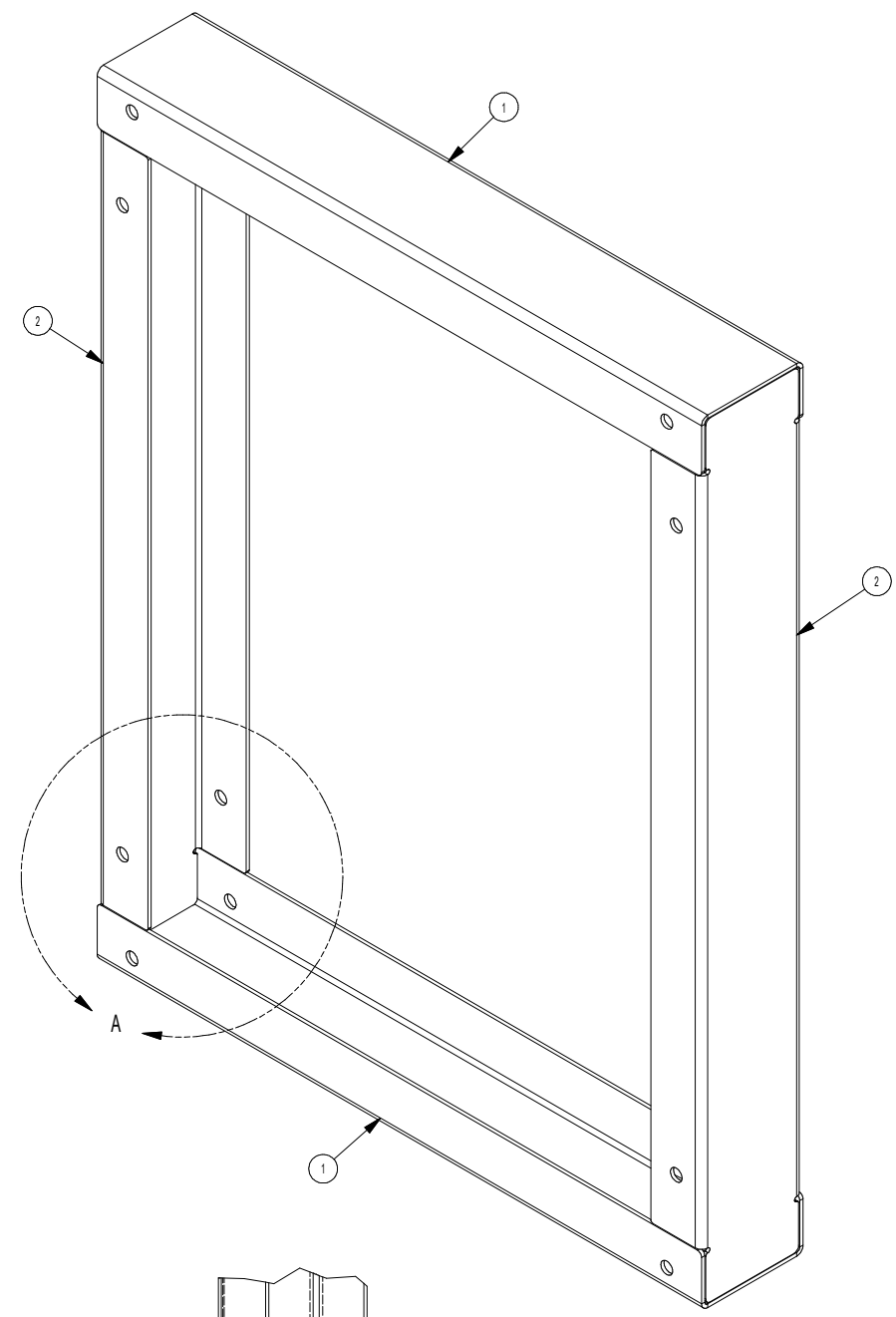
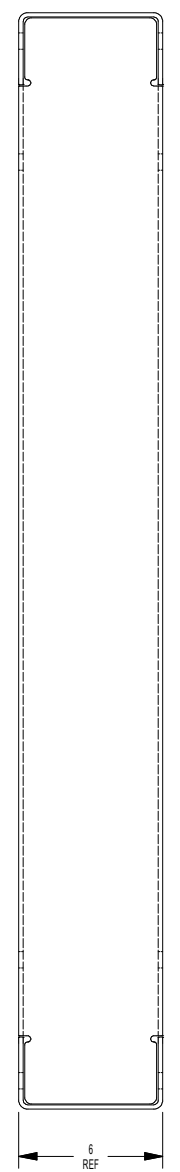
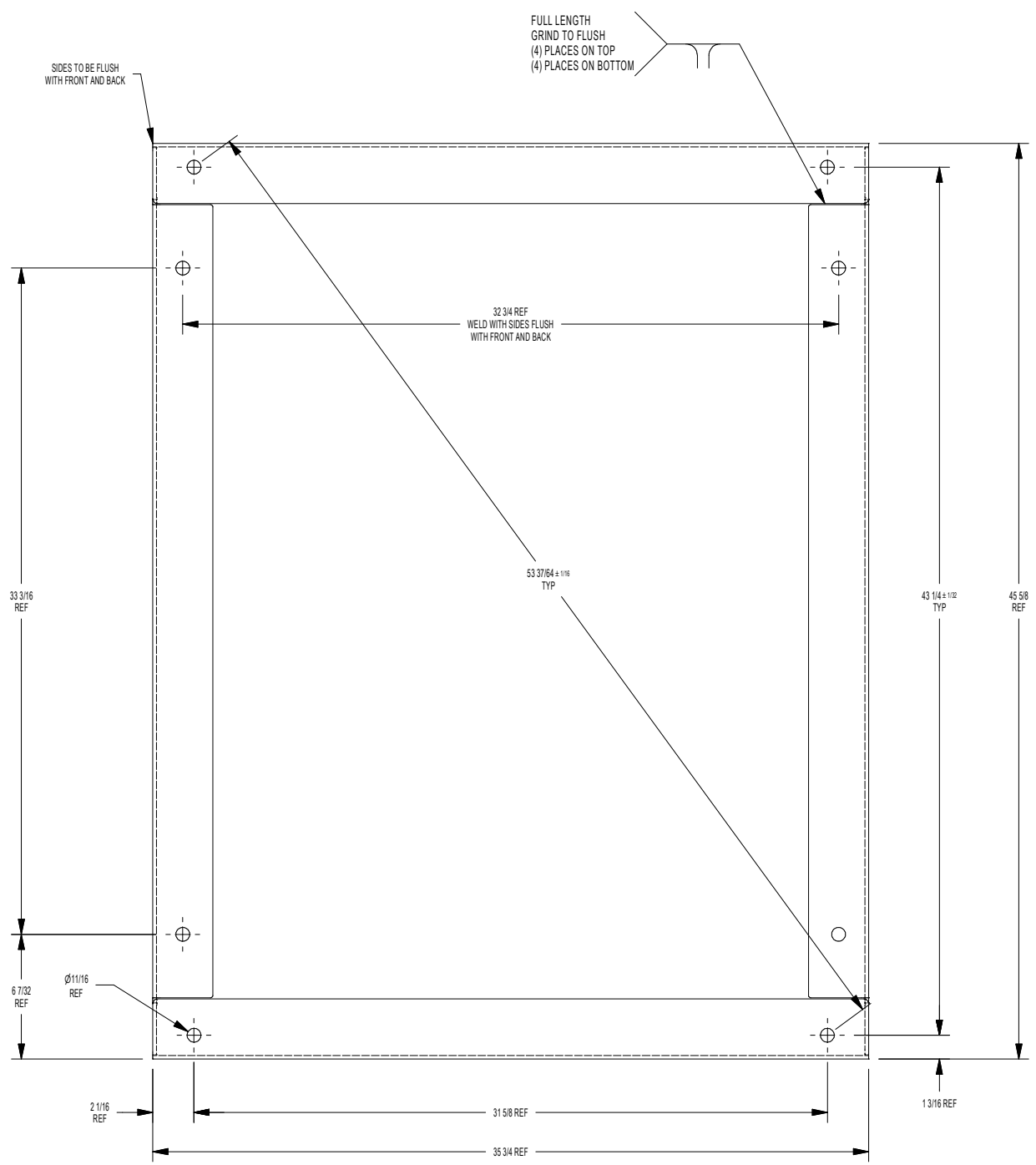

NOTES:  
 1. BASE TO BE FLAT WITHIN 1/8"  
 2. APPLY (1) COAT FLAT BLACK PAINT

QTY	PART NUMBER	ITEM	DESCRIPTION
1	8685-023-011	3	WELDWIRE-MS_045DIA
2	9081-219-001	2	CHANNEL-BASE, SIDE
2	9081-218-001	1	CHANNEL-BASE, FRONT/BACK
9945-163-001 BASE ASSY - 1 PLACE, 6" (S-975)			
STANDARD RAW STOCK COMMERCIAL TOLERANCES APPLY UNLESS EXCEPTED:			<b>DEXTER LAUNDRY INC.</b>
			FAIRFIELD, IOWA
FRACTIONS ± 1/64	DECIMAL ± 0.05	ANGULAR ± 7'	REFERENCE (XXX)
DATE: 11/10/2022	DWG. NO: 9945-163	SCALE: D	SIZE: 1 OF 1
REV: S	APP: S		

1 2 3 4 5 6 7 8 9 10

REVISION HISTORY		
REV	DESCRIPTION	APP
PR	RELEASE FOR PRODUCTION -001. ECN 005041	SC
	11/10/22	

A  
B  
C  
D  
E  
F  
G

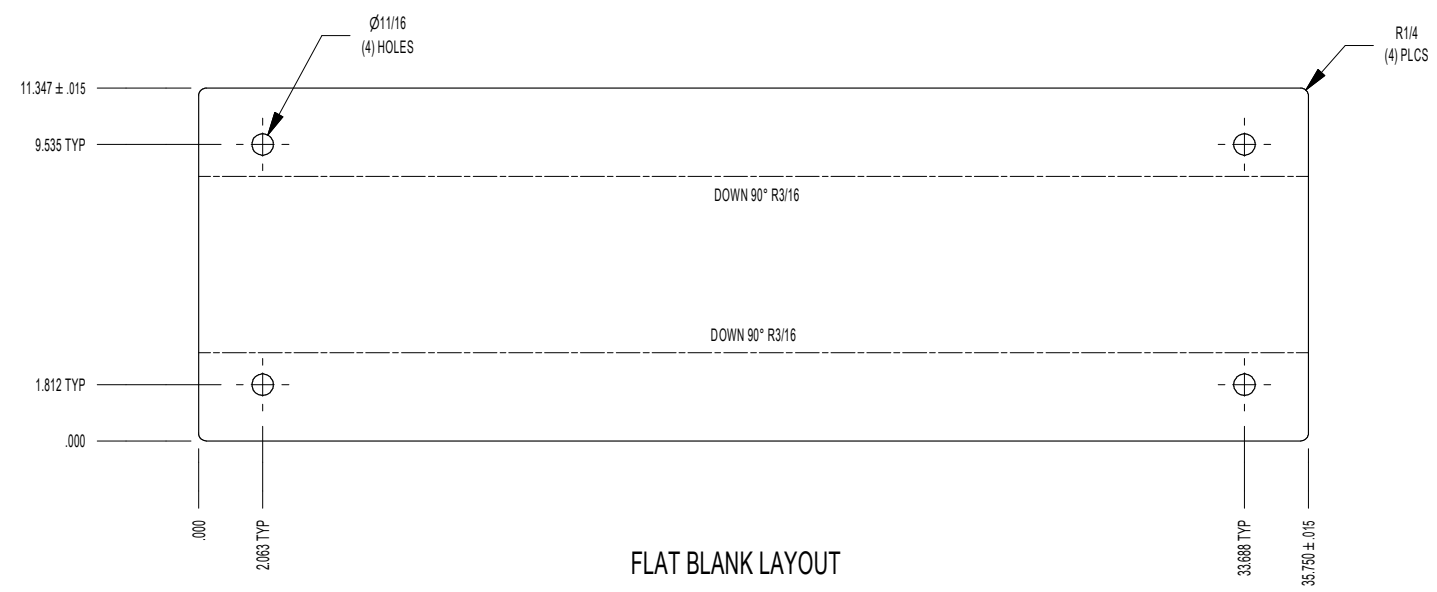
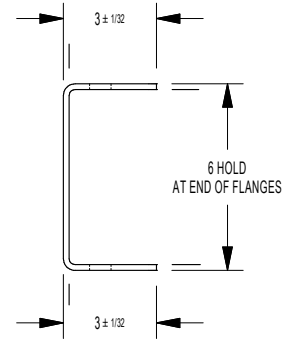
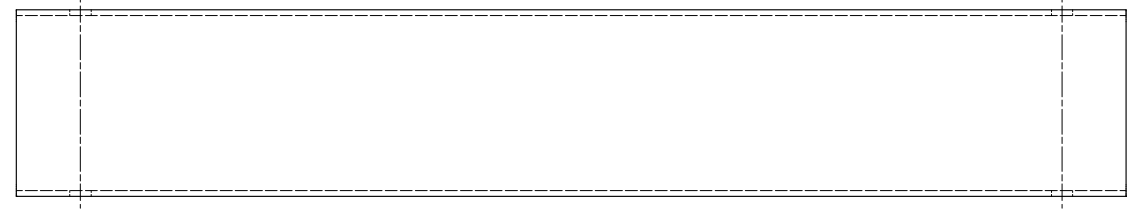
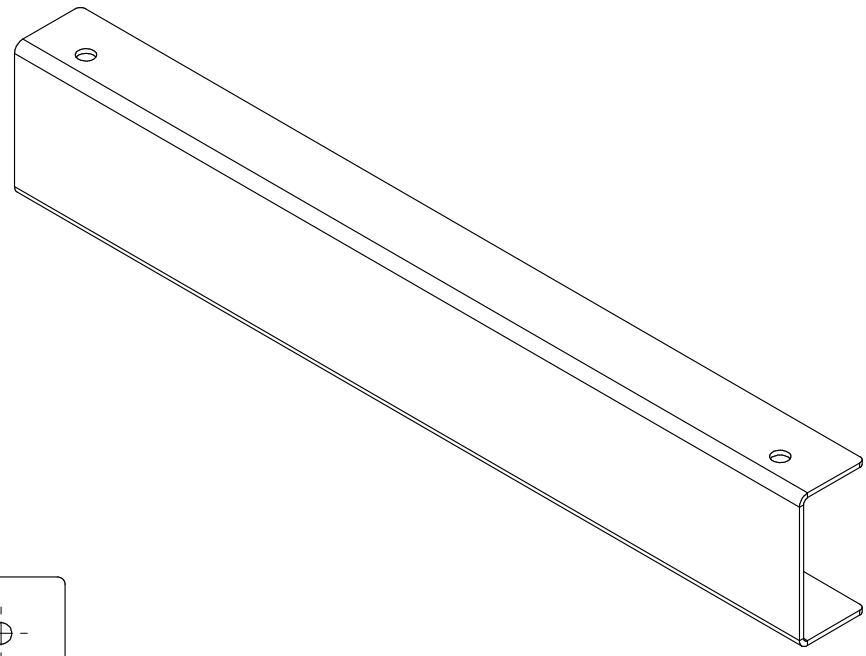

FLAT BLANK LAYOUT

9081-218-001	CHANNEL-BASE, FRONT/BACK	HRS, 3/16
PART NUMBER	DESCRIPTION	MATERIAL
STANDARD RAW STOCK COMMERCIAL TOLERANCES APPLY UNLESS EXCEPTED.		
<b>DEXTER LAUNDRY INC.</b>		
FAIRFIELD, IOWA		
FRACTIONS ± 1/64	SCALE	SIZE
TOLERANCES UNLESS OTHERWISE SPECIFIED	DECIMAL ± .005	ANGULAR ± 2
REFERENCE (XXX)	DATE: 11/10/2022	SHEET 1 OF 1
DWG. NO	9081-218	REV PR

1 2 3 4 5 6 7 8 9 10

REVISION HISTORY		
REV	DESCRIPTION	APP
PR	RELEASE FOR PRODUCTION -001. ECN 005041	SC
	11/10/22	

A  
B  
C  
D  
E  
F  
G

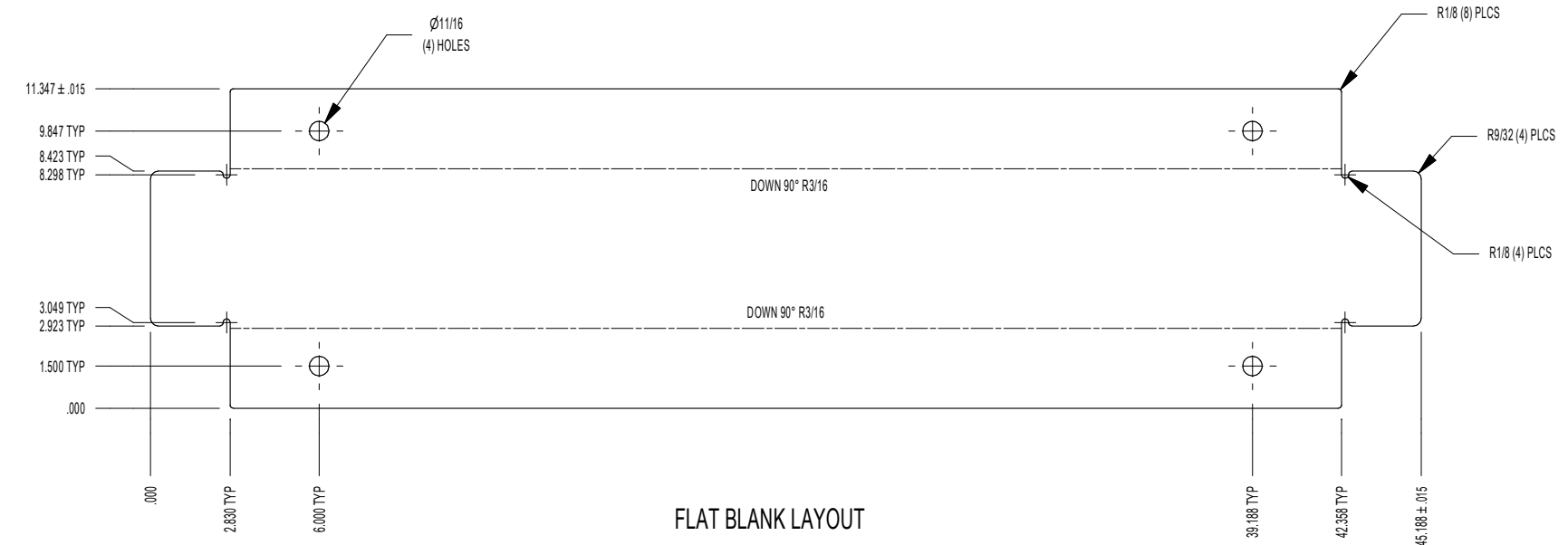
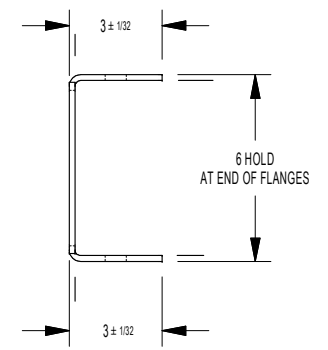
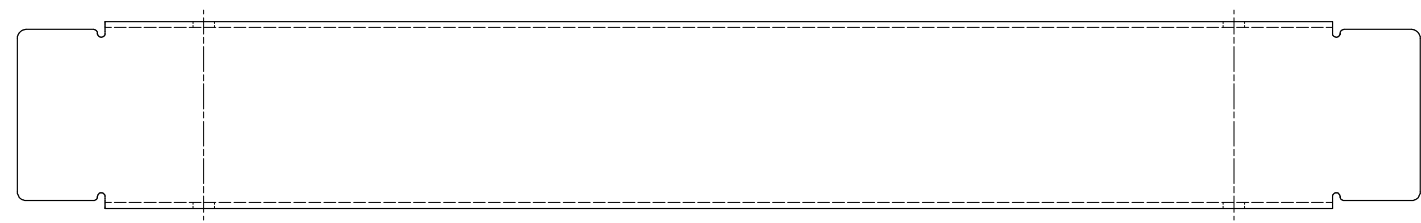
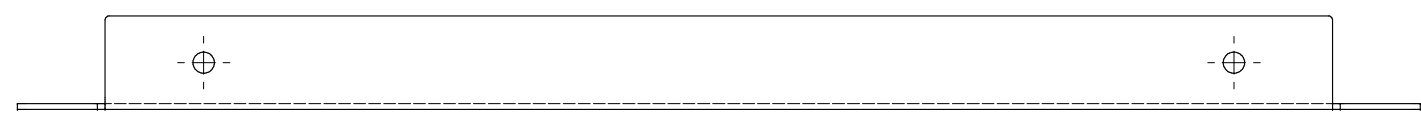
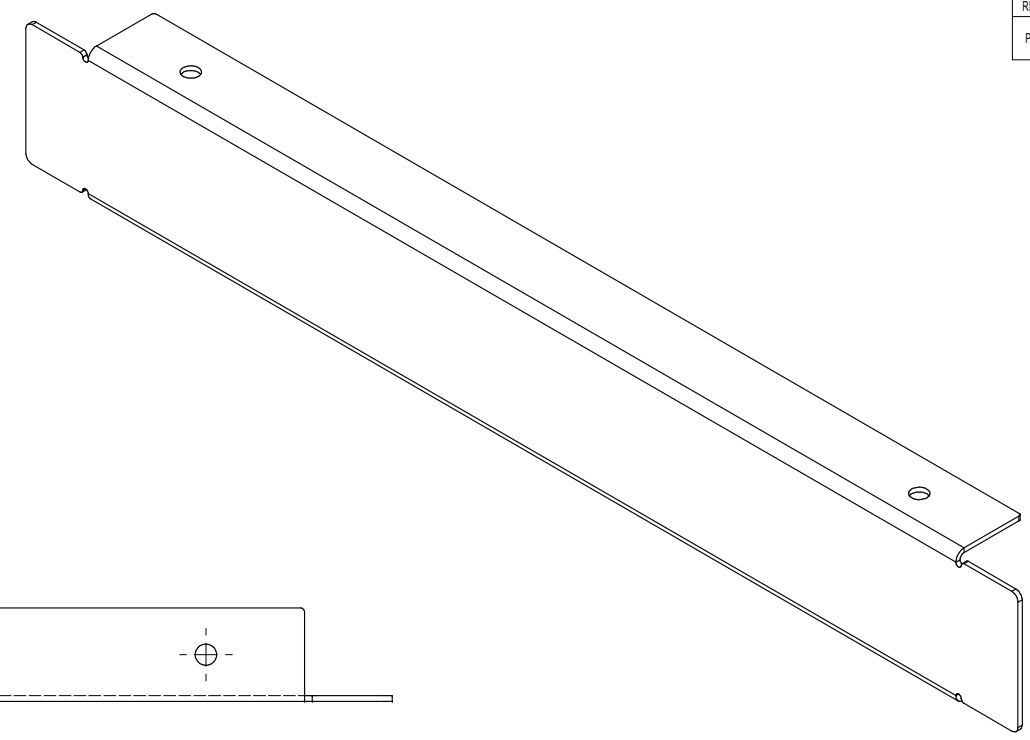

FLAT BLANK LAYOUT

9081-219-001	CHANNEL-BASE, SIDE	HRS, 3/16
PART NUMBER	DESCRIPTION	MATERIAL
STANDARD RAW STOCK COMMERCIAL TOLERANCES APPLY UNLESS EXCEPTED.		
<b>DEXTER LAUNDRY INC.</b>		
FAIRFIELD, IOWA		
FRACTIONS ± 1/64	SCALE	SIZE
TOLERANCES UNLESS OTHERWISE SPECIFIED	DECIMAL ± .005	ANGULAR ± 2
REFERENCE (XXX)	DRAWN: SC	DATE: 11/10/2022
DWG. NO	9081-219	REV PR
		SHEET 1 OF 1