

SERIES



**X-Series Vended Stack & Single Pocket Dryers
Reversing and Non-Reversing Parts Manual**



X-Series Series Vended Dryers
Reversing & Non-Reversing
Parts Manual

Table of Contents

Section 1: Stack Dryers Parts Data.....4
 Kits & Assemblies.....4
 Cabinet Group.....6
 Control Parts.....8
 Loading Door.....10
 Bearing Housing.....12
 Tumbler Group.....13
 Burner Housing.....14
 Rear View.....16
 Control Assembly.....18
 Coin Acceptor.....20

**Section 2: Single Pocket Dryers Parts Data...
21**
 Kits & Assemblies.....21
 Cabinet Group.....23
 Bearing Housing & Tumbler Group.....25
 Burner Housing.....27
 Rear View.....29
 Electrical Box.....31
 Airflow Switch.....33
 Coin Acceptor.....35

Section 3: T-120 Dryer Parts Data.....36
 Kits & Assemblies.....36
 Cabinet Group.....38
 Bearing Housing.....40
 Tumbler Group.....41
 Burner Housing.....42
 Airflow Switch.....44
 Control Assembly.....46
 Coin Acceptor.....48



DEXTER[®]
LAUNDRY



Section 3:
Touch Series Vended
T-120 Reversing Parts Data

Cabinet Parts Group

Key	Description	T-120	QTY
1	Loading Door Complete SS/Chrome/Blk Assembly	9960-331-002	1
*	Door Assy, Loading (Ring only) Chrome	9960-330-002	1
2	Plate Assy, Hinge	9982-398-001	1
*	Screw Hinge to Door	9545-018-018	5
*	Nut, Hinge to Door	8640-414-006	5
3	Glass, Door	9212-002-006	1
*	Adhesive-Door Glass, 10.3 oz. tube (24-Hour Cure Time)	8561-138-004	1
4	Coin Acceptor	9021-094-001	1
*	Payment Wiring Harness	9628-024-006	1
*	Retainer-coinacceptor	9486-145-001	1
5	Gasket, Door Outer Rim (Black)	9206-420-007	1
6	Handle, Loading Door	9244-093-001	1
*	Screw, Handle	9545-018-017	2
7	Stud Door Catch 7/8"	9551-033-002	1
8	Nut-Hex, #10-32	8640-413-001	1
9	Nut, Acorn	8640-413-003	1
*	Catch, Loading Door	9086-015-002	1
*	Rivet	9491-009-004	2
10	Strap, Hinge (Black)	9966-023-002	1
*	Channel Assy.-Front Panel	9982-397-001	1
*	Screw-Phillips, 10-32x1/2 Chrome	9545-012-003	2
*	Screw-Phillips-Counter sink, 10-32x1/2 Chrome	9545-012-028	4
11	Screw-Special, Hinge to Door	9545-052-001	1
*	Nut-Allen, 1/4-20S	8640-439-001	1
12	Washer-Fiber/Plastic	8641-436-003	1
13	SS Front Panel Assy (Blk)	9989-753-001	1
13	SS Front Panel Assy (Blu)	9989-753-002	1
*	Insulation-Front Panel	9277-065-001	1
*	Label-Warning	8502-758-002	1
14	Screw-Phillips, 10Bx1 3/4	9545-008-014	8
15	Washer-Finish	8641-585-001	8
*	Nut-Expansion	8640-442-001	8
*	Switch-Door (Square)	9539-501-001	1
17	Vaultassy-coin,black	9942-039-002	1
*	Coin Vault Cover	9825-064-001	1
18	Controlasy-t120coin (Blk)	9857-298-002	1
*	Controlasy-t120coin (Blu)	9857-298-001	1
19	Overlay-Controltrim,-t-120, (Blk)	9435-069-001	1
19	Overlay-Controltrim,-t-120, (Blu)	9435-069-002	1

Cabinet Parts Group



Cabinet Parts Group Continued

Key	Description	T-120 Reversing	QTY
1	Assembly-Door-Lower Service (Number 2 thru 7)	9960-345-001	1
2	Door-Lower Service	9108-148-003	1
*	Reinforcement-Lower Service Door	9489-053-001	1
*	Cam-lock	9095-047-001	1
*	Washer-flat	8641-581-006	2
*	Key, 6324	6292-006-007	1
3	Lockassemblyandkey	8650-012-004	2
4	Trim-Lower Kick, Black	9578-101-002	1
5	Screw-Phillips, 10Bx3/8, Black	9545-008-010	4
*	Bracket, Lower door switch, (Hinge Bracket)	9029-226-001	1
*	Rivet, 1/8 Low Profile	9491-009-004	10
6	Screw, Lower Service Door Mounting	9545-012-015	4
7	Nut, Lower Service Door Mounting	8640-413-002	4
8	Switch-Door (Square)	9539-501-001	1
9	Screen Assy, Lint	9822-033-001	1
*	Footing Foot	9188-016-001	4

Cabinet Parts Group

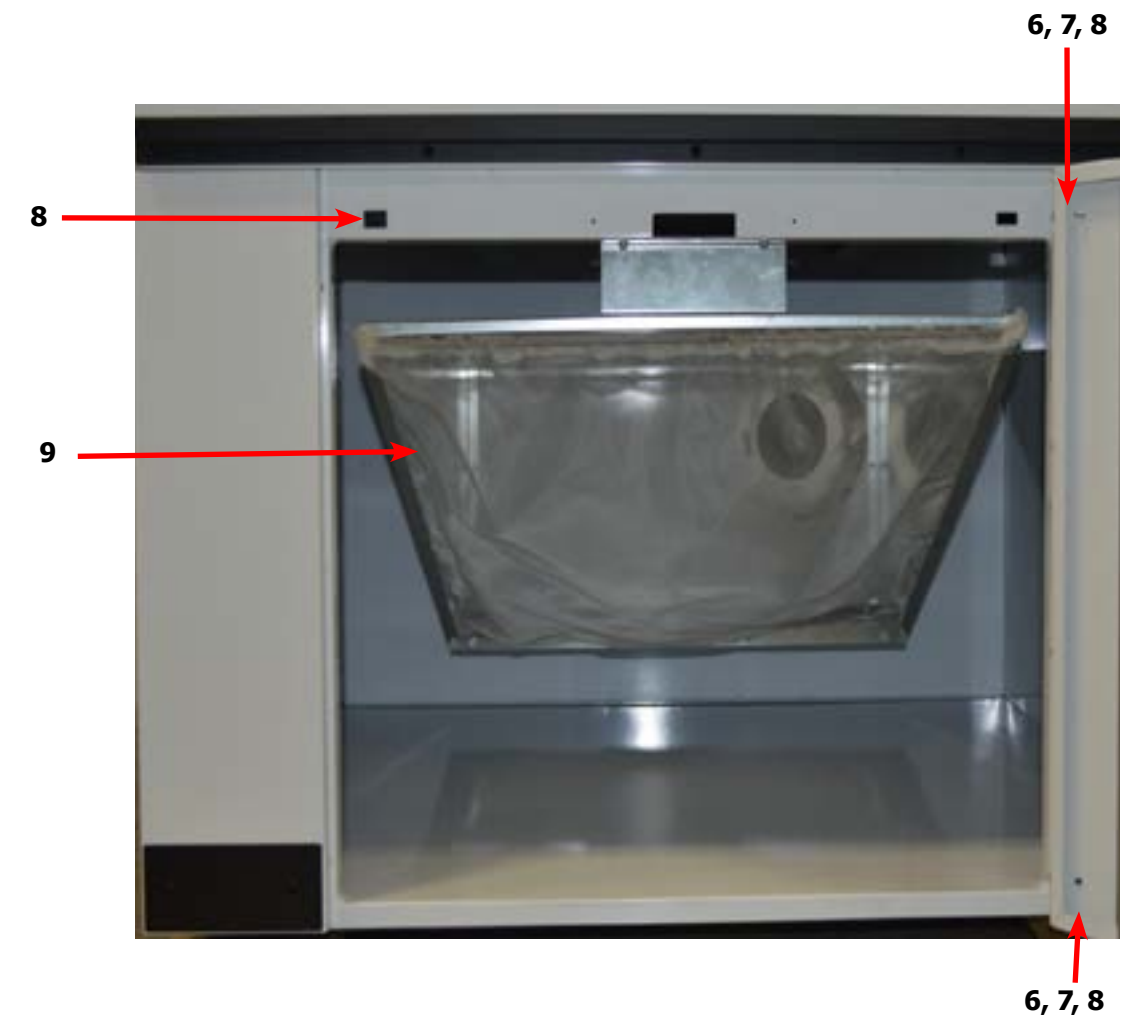
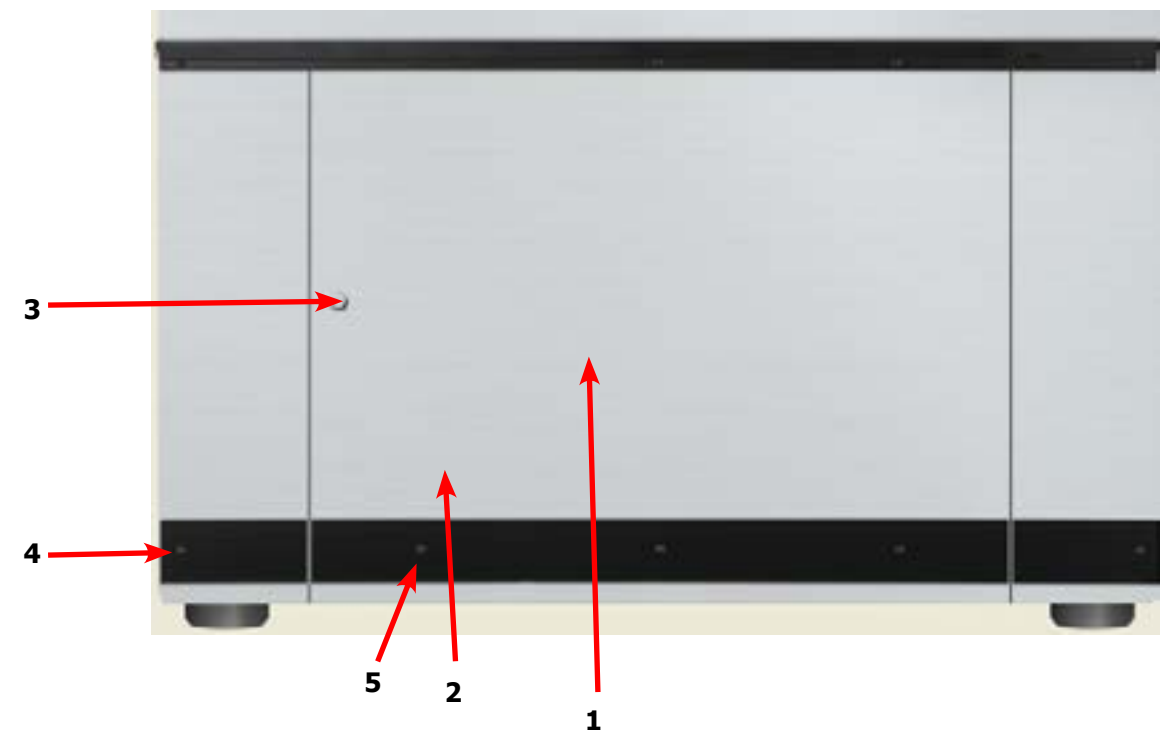

Cabinet Parts Group Continued

Key	Description	T-120 Reversing	QTY
1	Panel Assy.-Upper Right	9989-549-002	1
*	Screw, 5/16- 10ABx3/8	9545-008-024	2
2	Insulation-Right Upper, Burner Area	9277-041-022	1
3	Panel Assy.-Upper Left	9989-550-002	1
*	Screw, 5/16- 10ABx3/8	9545-008-024	2
4	Insulation Tumbler Area, Right (Front & Back)	9277-051-005	2
4	Insulation Tumbler Area, Right (Center)	9277-051-006	1
5	Insulation Tumbler Area, Left (Front & Back)	9277-051-005	2
5	Insulation Tumbler Area, Left (Center)	9277-051-006	1
6	Switch-Door (Round)	9539-492-001	2
*	Switch-Door (Square)	9539-501-001	
*	Screen Assy, Lint	9822-033-001	1
*	Lint Hood Assembly	9834-012-001	1
7	Lint Hood, Top	9240-048-001	1
*	Lint Hood, side left	9240-049-001	1
*	Link Hood, side right	9040-049-002	1
8	Lint Hood, Bottom	9058-030-001	1
9	Lint Hood, Angle	9003-333-001	1
10	Screw, 5/16- 10ABx3/8	9545-008-024	22
11	Hinge-Door, Lower	9243-083-002	1
*	Screw-5/16, 10ABx3/8	9545-008-024	5
12	Impeller, w/set screws	9278-041-001	1
13	Harness -Temp Probe	9627-949-001	1
14	Wire Nut, #71B	8640-276-005	2
15	Temp Probe	9501-004-003	1
16	Screw-Phillips, 8Bx1/4	9545-045-005	1
17	Bracket, Temp Probe	9029-111-001	1
18	Screw, 8AB x 3/8	9545-045-008	4
19	Trim-Edge, Lint Hood	9578-092-003	2
20	Lowerservicedoor-Hinge, black	9243-084-003	
21	Strapasy-hinge, lwrservdr	9966-022-001	11

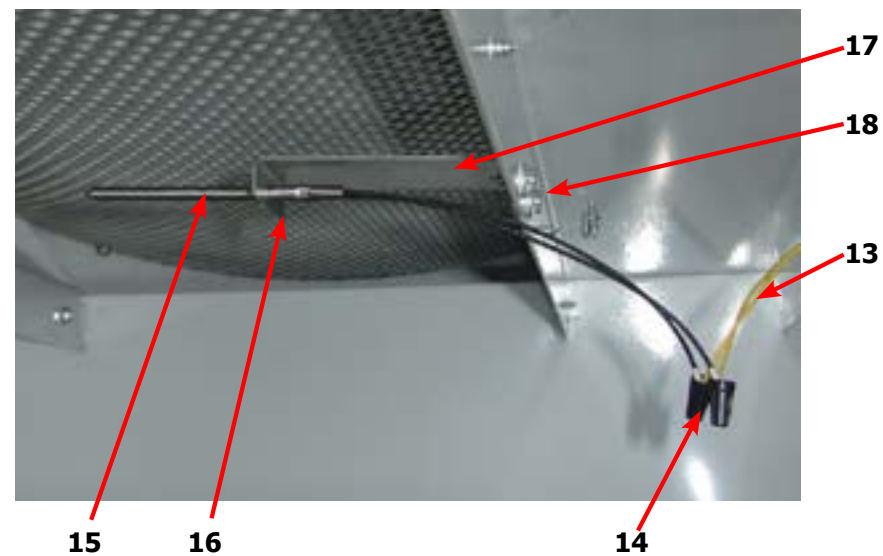

Cabinet Parts Group

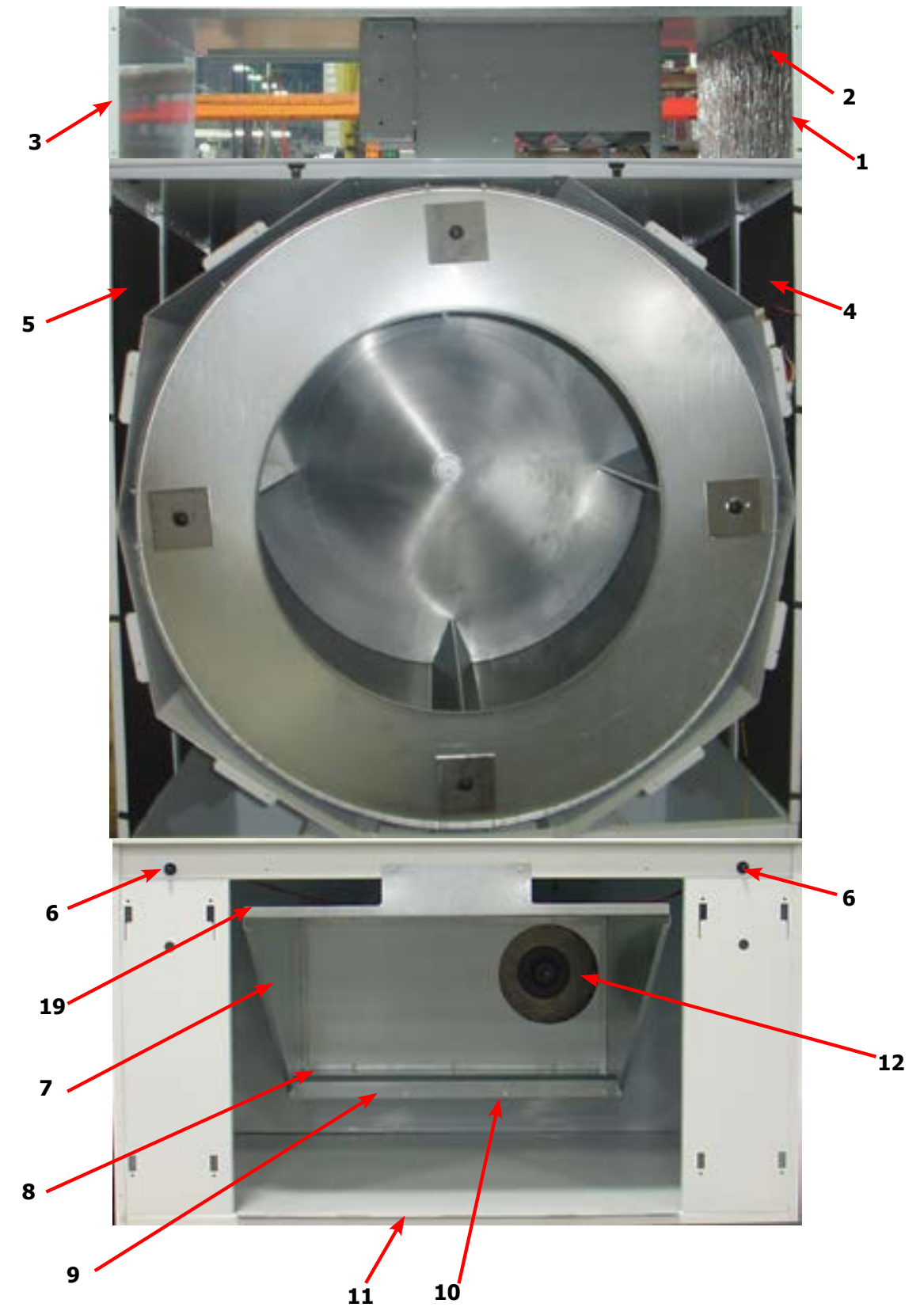

Modular Cabinet Parts Group

Key	Description	T-120 Reversing	QTY
1	Cabinet Base Assembly	9945-172-001	1
*	Lower Back Panel Assembly	9989-754-002	1
2	Lower Cabinet RH Side Panel	9444-125-003	1
3	Lower Cabinet LH Side Panel	9444-125-004	1
4	Lower Cabinet Front Channel	9081-217-001	1
*	Upper Back Panel Assembly	9989-717-002	1
5	RH Middle Side Panel Assembly	9989-543-003	1
6	LH Middle Side Panel Assembly	9989-543-004	1
7	Cabinet Top Cover	9074-356-001	1
8	Baffle	9049-135-001	4
*	Baffle Stiffener Angle	9003-388-001	2
9	RH Upper Side Panel Assembly	9989-549-002	1
10	LH Upper Side Panel Assembly	9989-550-002	1
*	10abx3/8 Screw	9545-008-024	92
*	3/16 Blind Rivet	9491-009-001	131
*	Wht 3/16 Blind Rivet	9491-009-005	58
*	Hex kep Nut 1/4-20unc, 2b	8640-414-006	10
*	Upper Service Door Assembly, Wht/Blk	9960-361-001	1
*	Upper Service Door Assembly, Wht/Blu	9960-361-002	1
*	Upper Service Door Assembly, SS/Blk	9960-361-003	1
*	Upper Service Door Assembly, SS/Blu	9960-361-004	1
*	Screw	9545-008-014	2

Modular Cabinet Parts Group

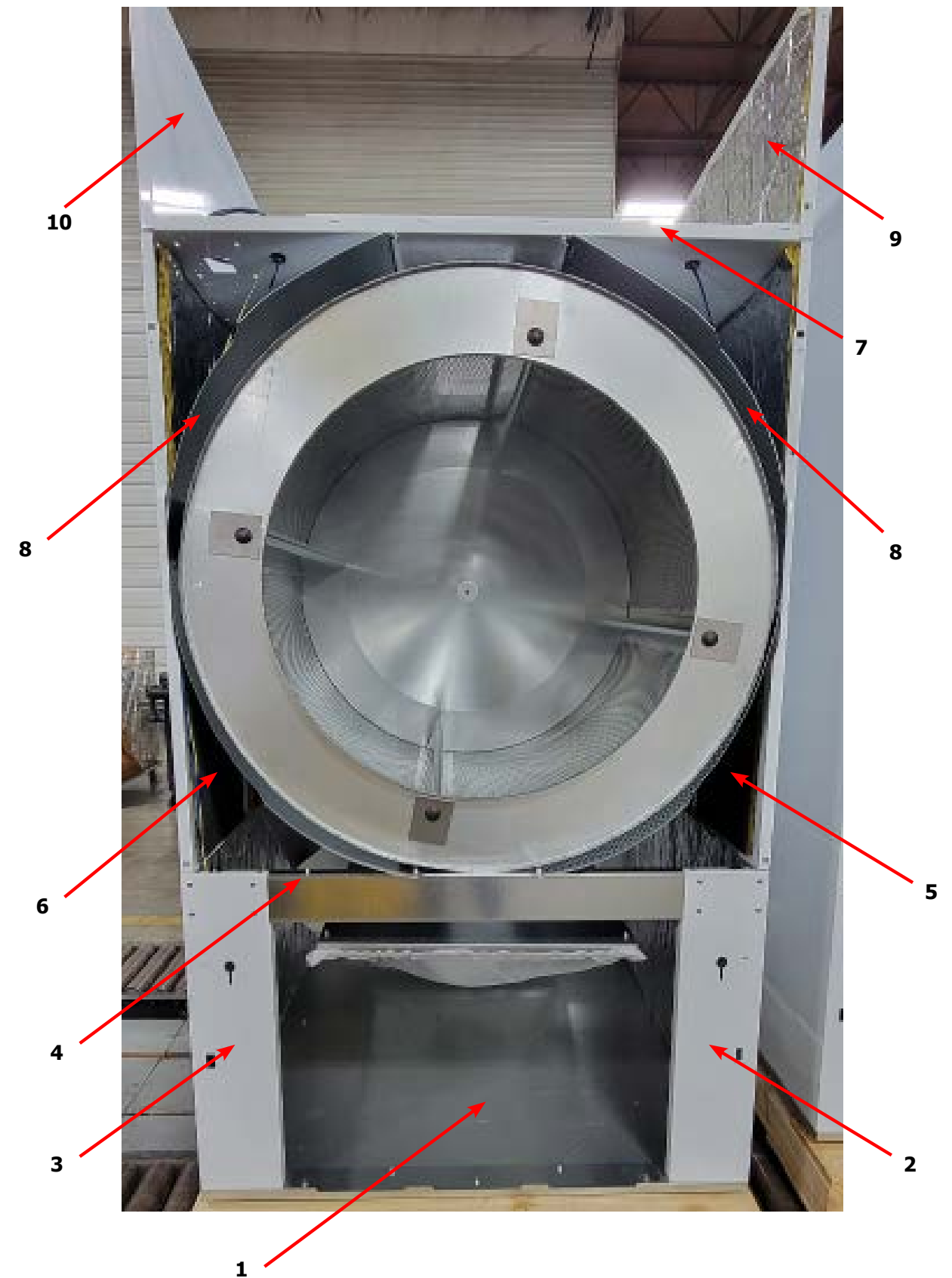

Rear View Parts Group

Key	Description	T-120 Reversing	QTY
1	Pulley, Driven	9453-168-003	1
2	Tolerance Ring	9487-234-006	1
3	Washer -Flat	8641-581-032	1
4	LockWasher - IntTooth, 1"	8641-582-018	1
5	Screw, 5/8-11 x 1 1/2	9545-060-001	1
6	Belt-Driven	9040-076-005	2
*	Impeller, 5" x 16"	9278-041-001	1
7	Plate Assembly-Impeller	9982-375-002	1
8	Nut-Wiz Lock, 5/16-18	8640-400-003	6
*	Gasket-Impeller Housing	9206-428-002	1
9	Motor-Blower, -10	9376-334-001	1
*	Run Capicator	5191-108-005	1
*	Start Capicator	5191-109-005	1
10	Screw, 5/16-18 x 5/8	9545-014-004	4
11	Nut-Wiz Lock, 5/16-18	8640-400-003	4
12	Thermostat-Overtemp	9576-207-006	1
13	Screw-10AB x 3/8	9545-008-006	2
14	Pulley, Intermediate, w/Bearings	9908-051-001	1
*	Bearings-Ball	9036-159-011	2
*	Spacer-Bearings	9538-186-001	1
*	Ring-Retaining, Internal	9487-238-006	1
15	Washer-Flat	8641-581-039	1
16	Nut, 5/8-11	8640-425-002	1
17	Belt, Motor	9040-076-008	1
18	Motor, Drive	9376-307-003	1
19	Pulley-Motor	9453-169-012	1
20	Bushing, Motor -Support	9053-074-002	2
21	Rod-Motor Mounting, Black	9497-222-008	1
22	Collar-Shaft, w/Set Screws	9076-052-002	1
23	Chain-Belt tension	9099-012-004	1
*	Hook-S Type	9248-022-002	1
24	Spring, Belt Tension	9534-151-000	1
25	Duct-Transition, 12" to 10"	9109-124-001	1

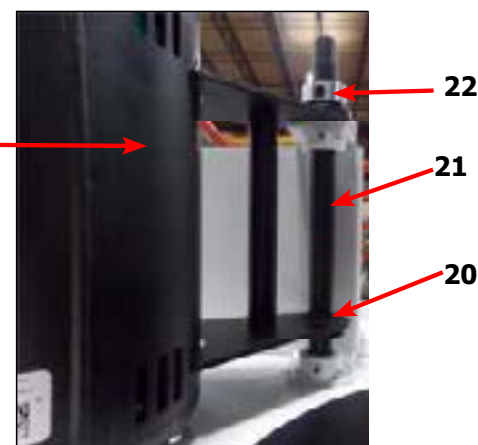
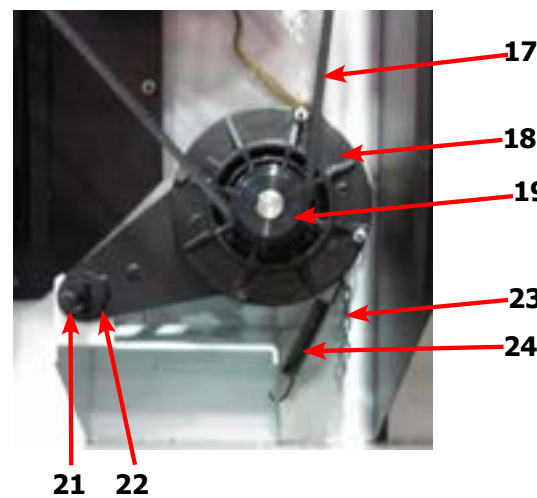

21 22

Rear View Parts Group

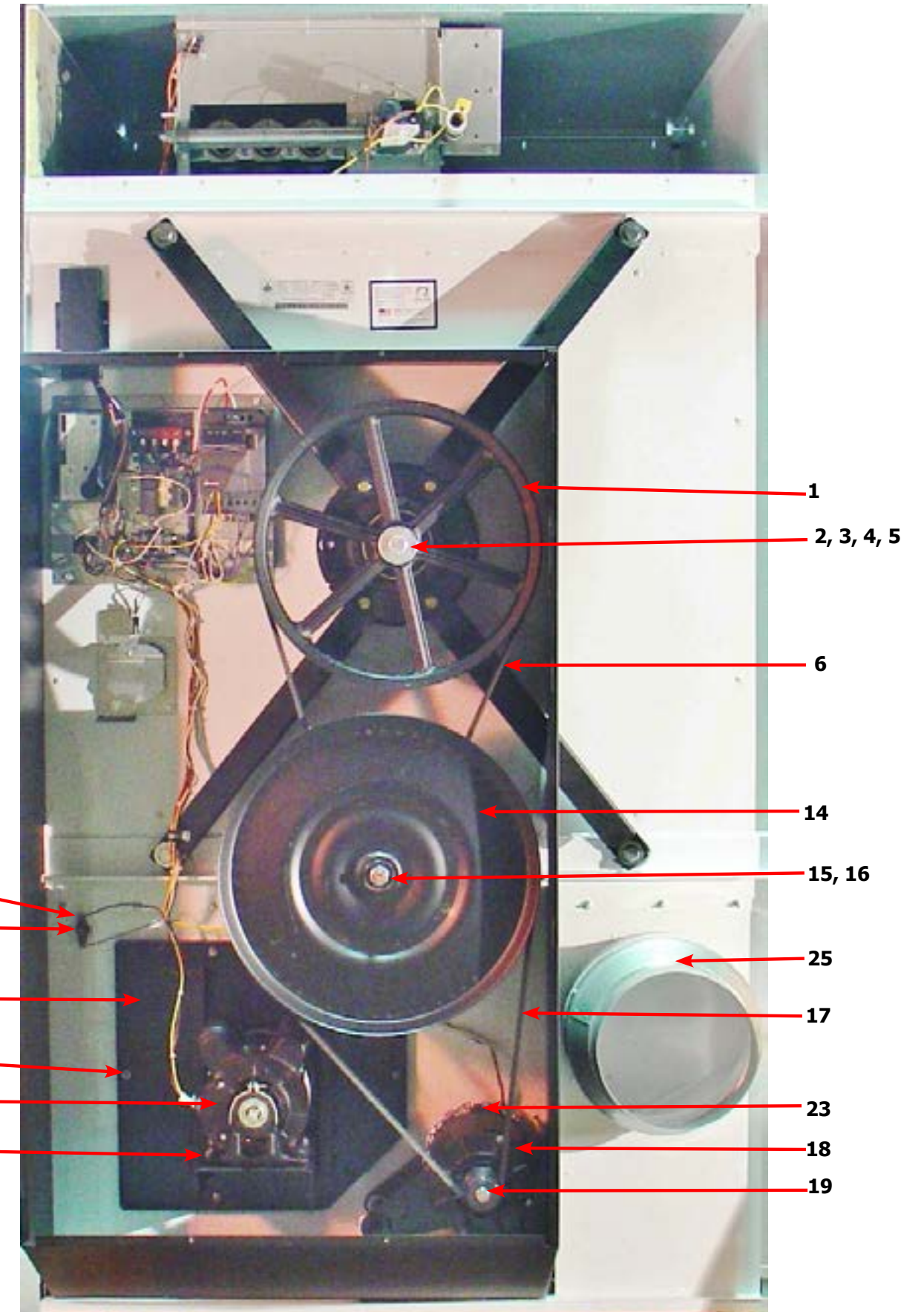

Rear View Parts Group: Guard & Exhaust

Key	Description	T-120 Reversing	
1	Cover Cabinet	9074-356-001	1
*	Screw-5/16, 10ABx3/8	9545-008-024	10
2	Duct-Transition, 12" to 10"	9109-124-001	1
*	Screws-10-16 x 1/2	9545-008-003	3
*	Guard-Side, Right	9208-111-002	1
*	Screw-Torx T20, 10B x 3/8, BLK	9545-008-034	7
3	Guard-Side, Left	9208-110-002	1
*	Screw-Torx T20, 10B x 3/8, BLK	9545-008-034	8
4	Guard-Top	9208-112-002	1
*	Screw-Torx T20, 10B x 3/8, BLK	9545-008-034	11
5	Guard-Bottom	9208-113-002	1
*	Screw-Torx T20, 10B x 3/8, BLK	9545-008-034	6
6	Guard-Wires	9208-115-002	1
*	Screw-Torx T20, 10B x 3/8, BLK	9545-008-034	2
7	Guard-Door, Right	9208-114-004	1
*	Screw-Torx T20, 10B x 3/8, BLK	9545-008-034	6
8	Guard-Door, Left	9208-114-003	1
9	Screw-Torx T20, 10B x 3/8, BLK	9545-008-034	4
*	Nut-Spring, U-type	8640-399-001	4
*	Booklet-Owners	8514-234-001	1
10	Diagram & Schematics	9506-896-001	1
11	Label-Warning & Notice	8502-763-001	1
12	Label-Instructions	8502-645-001	1
13	Decal-Lighting & Clearance	8527-151-001	1
14	Label-High Voltage	8502-614-004	1

Rear View Parts Group: Guard & Exhaust

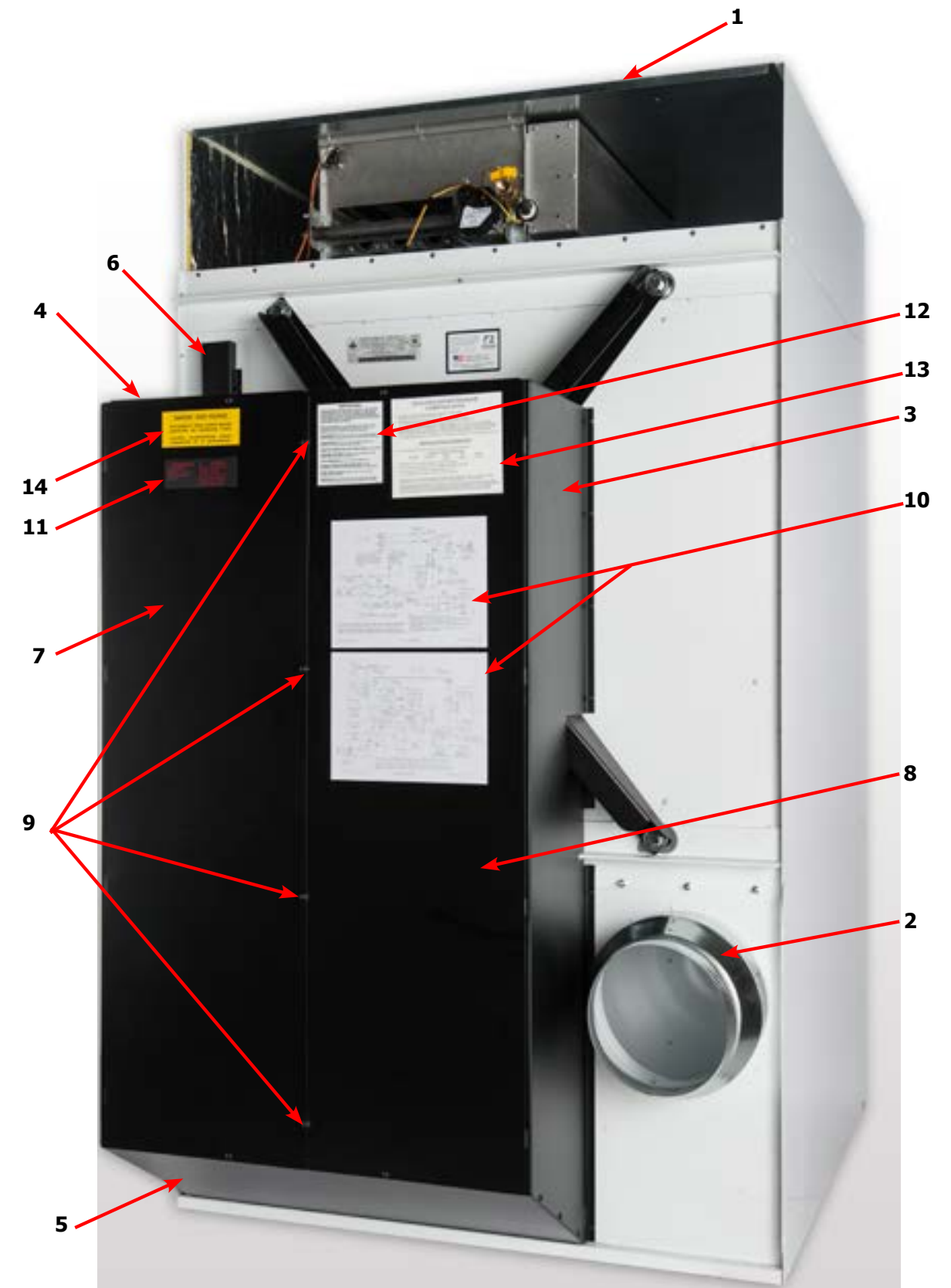

Bearing Housing Parts Group

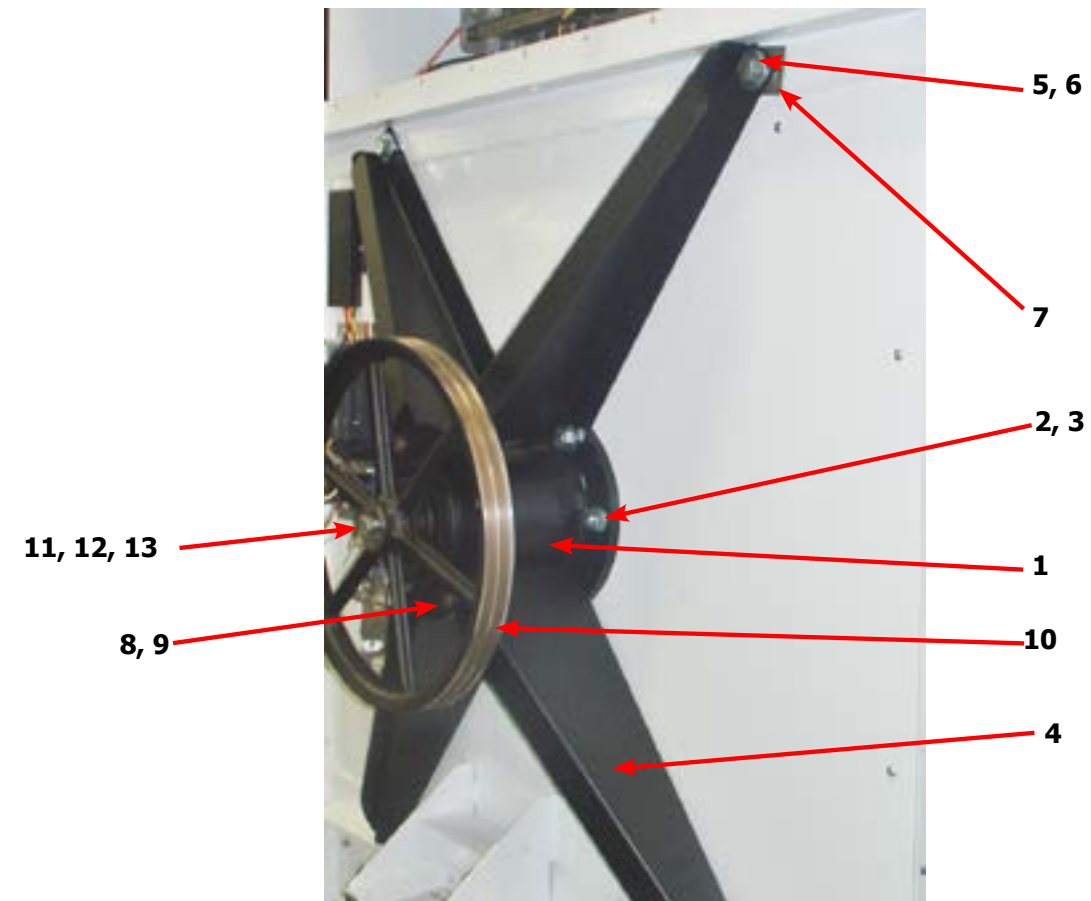

Key	Description	T-120 Reversing	QTY
	Bearing Housing Complete Assy w/ bearings & Spacer)	9803-186-001	1
1	Housing, Bearing	9241-180-002	1
*	Ring, Retaining-Internal	9487-238-003	1
*	Bearing, Ball, Front	9036-159-005	1
*	Spacer, Bearing	9538-167-001	1
*	Bearing, Ball, Rear	9036-159-004	1
*	Washer, Flat	8641-581-040	6
2	Screw-5/8"-11 x 1 1/2"	9545-060-001	6
3	Nut-Whizlock, 5/8" x 11	8640-425-001	6
4	Arm-Support Housing	9001-065-002	4
5	Screw-5/8-11 x 1 1/2	9545-060-001	4
6	Washer, Flat 5/8"	8641-581-038	4
7	Shim	9552-045-001	AR
8	Screw-7/16"-14 x 1 1/2"	9545-059-003	4
9	Nut-Whizlock, 7/16"	8640-416-005	4
*	Tolerance Ring	9487-234-006	1
10	Pulley Driven	9453-168-003	1
11	Washer, Flat 5/8" x 2 1/4"	8641-581-032	1
12	Lock Washer Spring, 1/2	8641-582-018	1
13	Screw, 5/8-11 x 1 1/2"	9545-060-001	1

Tumbler Parts Group

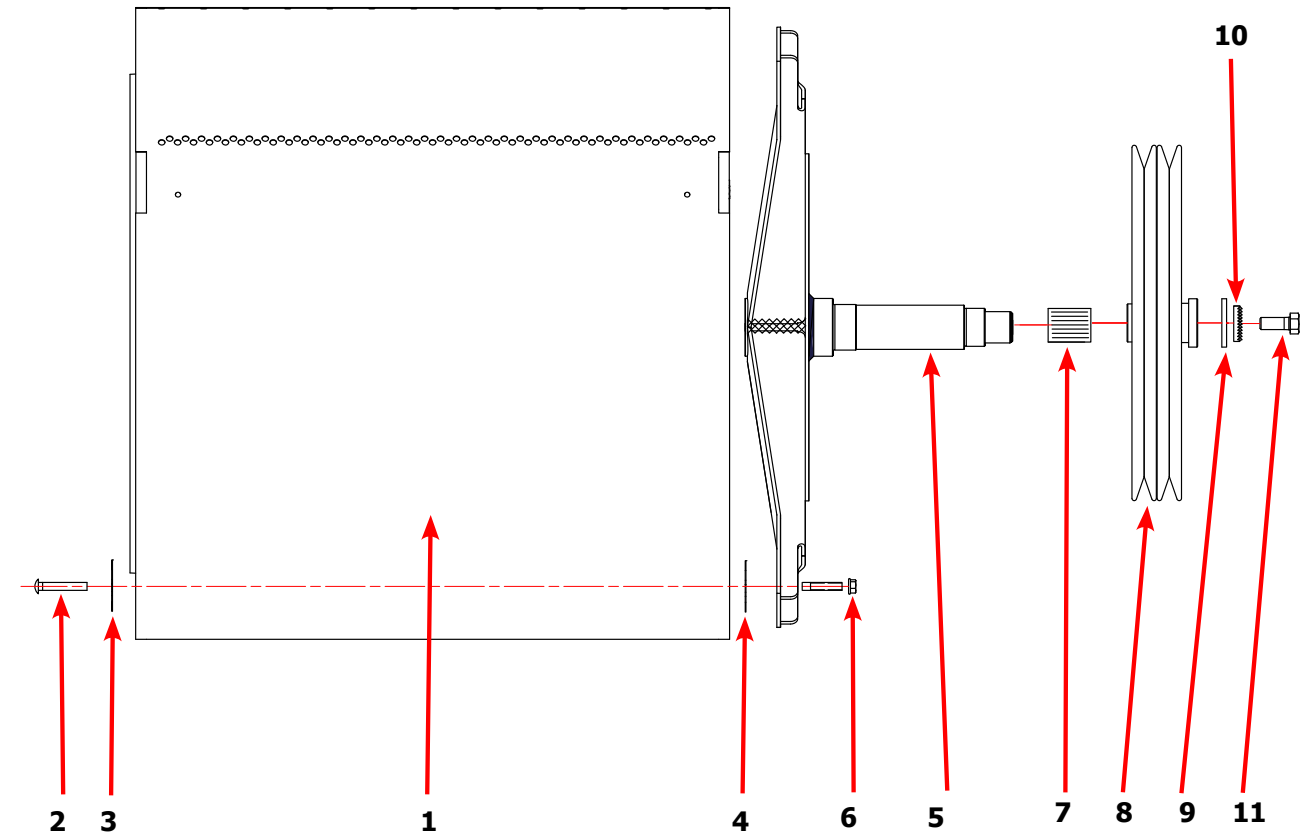

Key	Description	T-120	QTY
*	Tumbler Assy Complete W/Spider		1
1	Tumbler Assy		1
2	Rod, Tumbler	9497-266-003	4
3	Plate support, Tie Rod	9452-805-001	4
4	Shim	9552-013-003	AR
5	Spider Assy	9568-016-001	1
6	Nut, Wiz Lock	8640-417-005	4
7	Tolerance Ring	9487-234-006	1
8	Pulley, Driven	9453-168-003	1
9	Washer -Flat	8641-581-032	1
10	LockWasher - IntTooth, 1"	8641-582-018	1
11	Screw, 5/8-11 x 1 1/2"	9545-060-001	1

Burner Housing Parts Group

Key	Description	T-120 Reversing	QTY
*	Housing Assembly, Burner	9803-213-001	1
1	Screw, 10ABx3/8	9545-008-024	58
2	Bracket-Support, Gas Valve	9029-240-001	1
3	Side-Extention Baffle, Burner Housing	9551-049-001	2
4	Burner, Main	9048-022-001	3
5	Baffle-Burner Housing, Extension	9049-105-001	1
6	Panel-Burner Housing, Front	9454-882-001	1
7	Panel-Burner Housing, Back	9454-883-001	1
8	Panel-Burner Housing, Side Left	9551-052-001	1
9	Baffle-Center, Burner	9049-106-001	1
10	Panel-Burner Housing, Side Right	9551-051-001	1
11	Channel-Burner Housing, Right	9081-164-001	1
12	Bracket-Manifold	9029-239-001	1
13	Bracket-Support, Burner, Front	9029-241-001	1
14	Bracket-Support, Burner, Rear	9029-242-001	1
15	Control Assy,Gas Valve, White Rodgers 36J	9857-193-001	1
16	Manifold Assy	9381-013-001	1
17	Top Assembly, Burner Housing	9961-161-001	1
18	Screw, 10Bx1/4	9545-008-001	18
*	Orfice-Natural, #10	9425-069-027	3
*	Orfice-LP, #32	9425-069-009	3
*	Kit, LP Conversion, White Rodgers	9732-102-025	1
19	Thermostat-HI-Limit	9576-203-002	1
20	Electrode-Ignition	9875-002-003	1
21	Bracket-Igniter	9029-243-001	1
22	Elbow-3/4 Street, Black	8615-104-042	1
23	Pipe-Nipple, 3/4 x 4", Black	8655-073-046	
24	Valve-Gas Shutoff,	9379-198-001	1
25	Deflector-bottor,air	9114-055-001	1

Burner Housing Parts Group

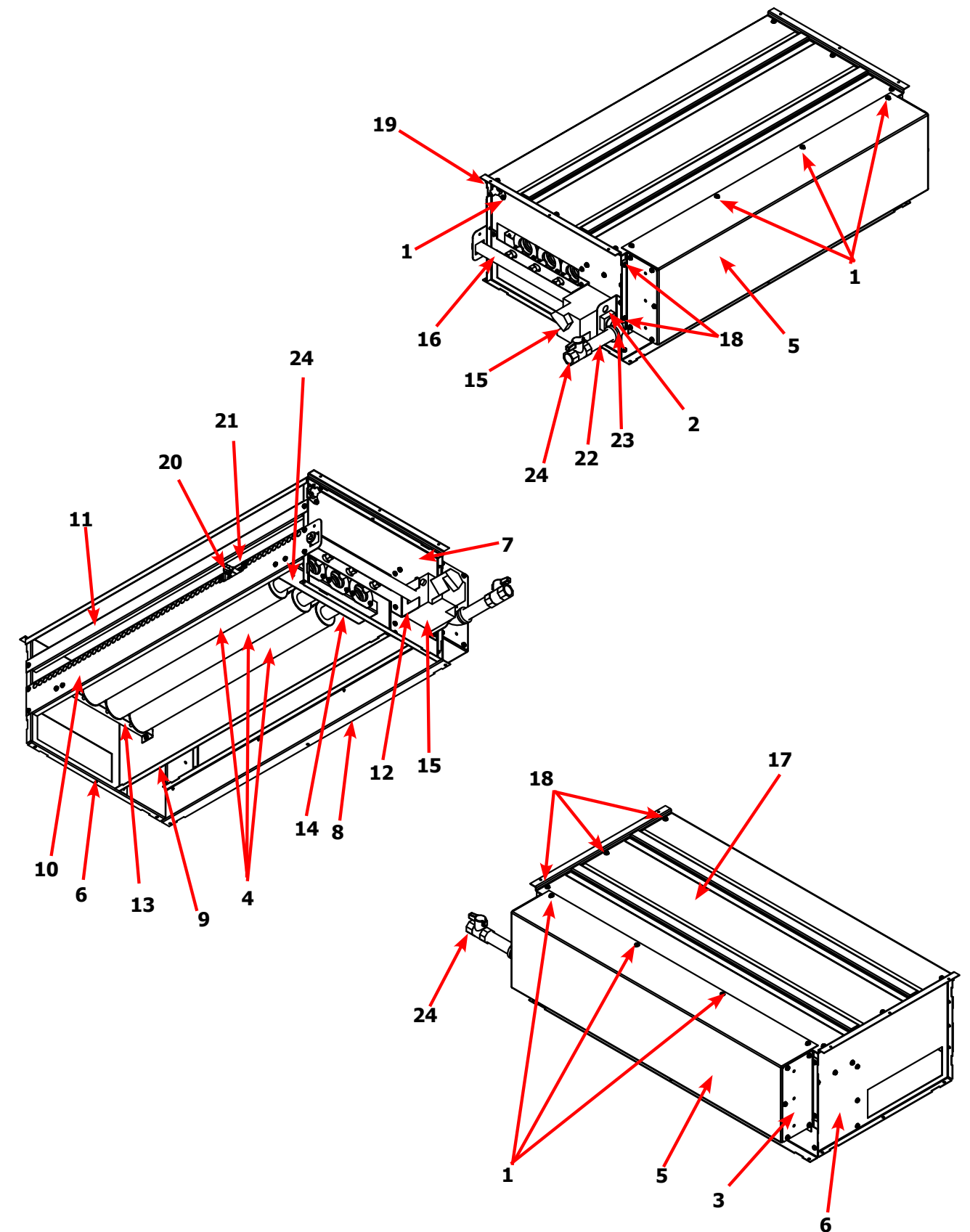

Control Assembly Parts Group

Key	Description	T-120 Reversing	QTY
*	Cntlasy-cmpl,t-120coin,60hz	9857-296-001	1
*	Cntrlasy-cmpl,t-120coin,50hz Only	9857-296-002	1
1	Transformer	8711-007-002	1
2	Main Power Terminal Block	9897-035-001	1
3	Motor Relay	5192-299-002	1
4	Ignition Control Module	9857-182-001	1
5	VFD [60HZ Only]	9375-033-011	1
5	VFD [50HZ Only]	9375-034-034	1
6	Controls Mtg Channel	9081-191-001	1
7	Terminal Block	9897-039-001	1
8	Terminal Block	9897-026-002	1
9	DC Power Supply	9150-054-001	1
10	2000hm Braking Resistor	9483-004-002	1
11	Main Terminal Marker Strip	9558-029-005	1
11	Main Terminal Marker Strip [50HZ Only]	9558-029-004	1
*	Wire Assembly-Violet 8"	8220-118-003	2
*	Wire Assembly-Jumper, blk/brn 15"	8220-113-006	1
*	Wire Assembly-Jumper, blk/wht 15"	8220-113-008	1
*	Wire Assembly-blk/brn 11"	8220-065-043	1
*	Wire Assembly-blk/wht 13"	8220-065-045	1
*	Wire Assembly-org/grn 24"	8220-064-067	1
*	Wire Assembly-wht/org 14"	8220-062-054	1
*	Wiring Harness-Ignition Control	9627-867-013	1
*	Wire Assembly-grn/yel 7"	8220-137-002	1
*	Wire Assembly-grn/yel 18"	8220-092-006	1
*	Wire Assembly-High Voltage	9631-403-005	1
*	Wire Assembly-blk/brn 9"	8220-146-008	1
*	Wire Assembly-blk/wht 9"	8220-146-010	1

Control Assembly Parts Group

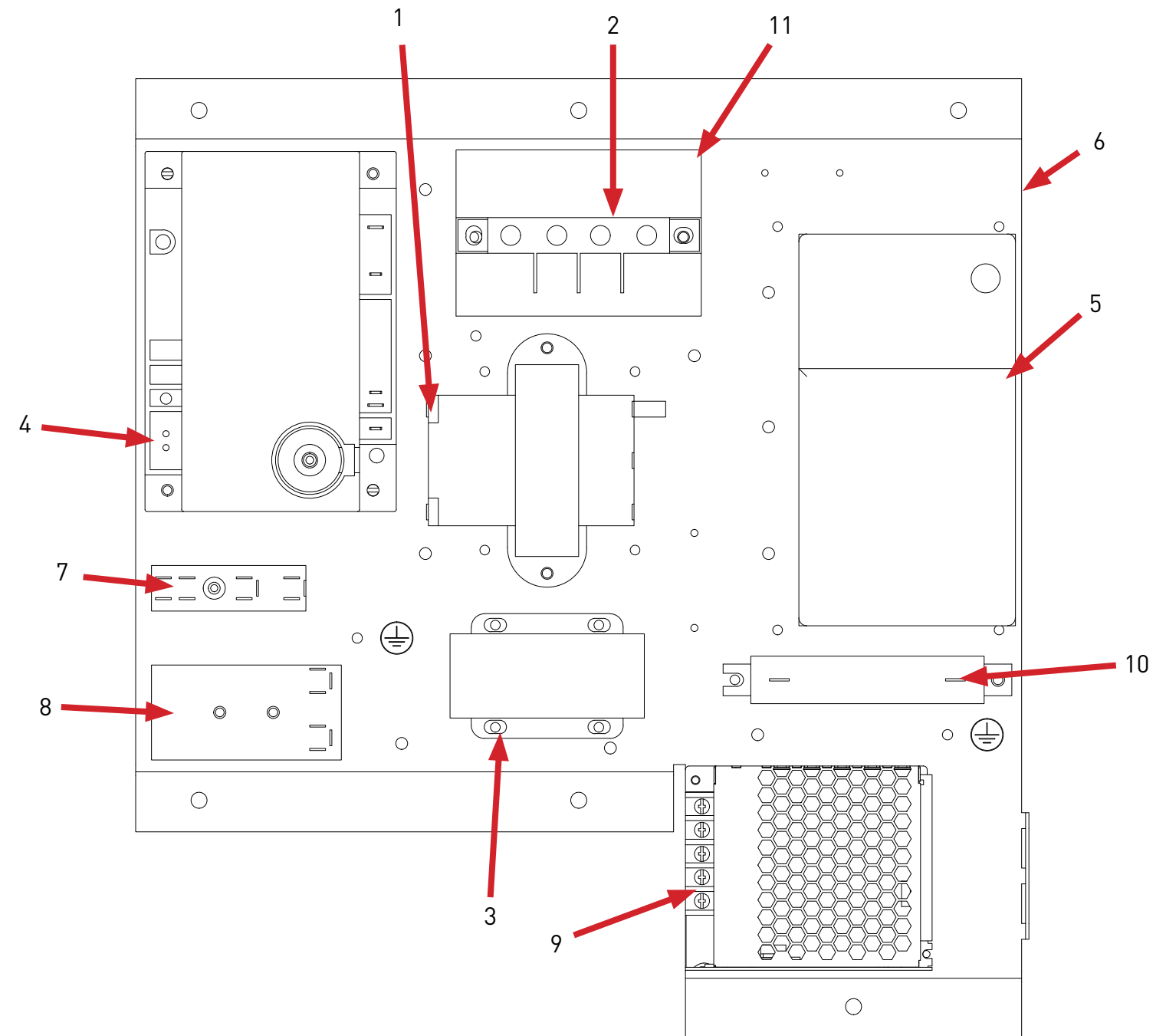

Airflow Switch Parts Group

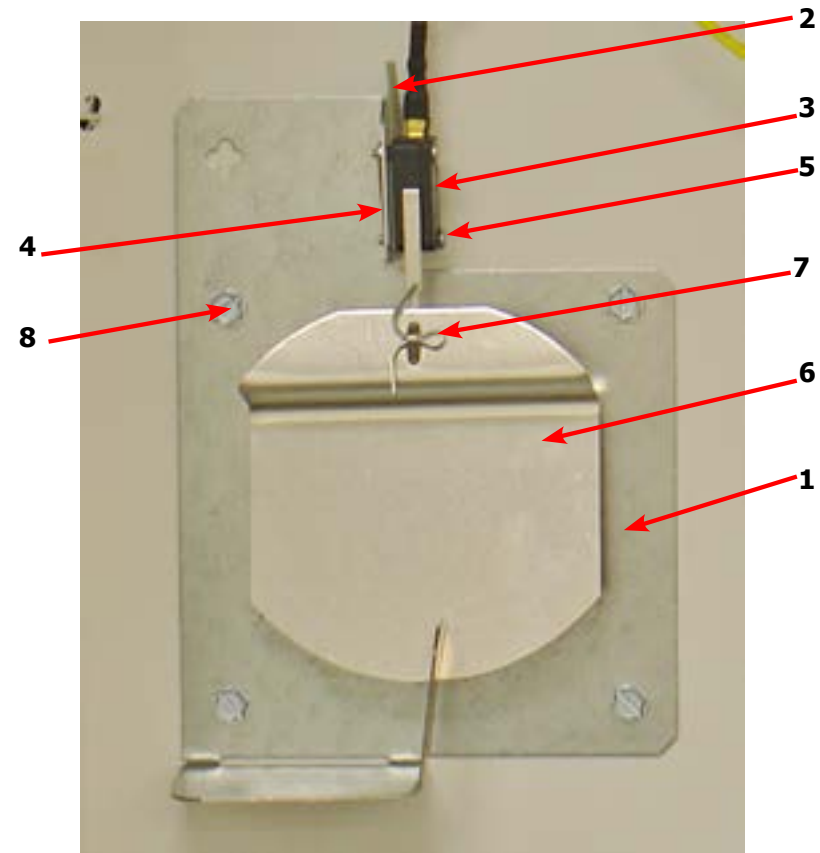

Key	Description	T-120 Reversing	QTY
*	Air Flow switch Assy	9801-098-001	1
1	Bracket-Airflow switch	9029-200-001	1
2	Shield-Switch	9550-169-003	1
3	Switch-Micro	9539-461-009	1
4	Nut-Twin, 4-40	8640-401-001	1
5	Screw-.625, 4-40	9545-020-001	2
6	Actuator-Air Flow Switch	9008-007-001	1
7	Pin-Cotter, .09375x.75	9451-169-002	1
8	Screw, 10Bx1/4	9545-008-024	4